

Contacts and Clips

Order code	Manufacturer code	Description
18-3662	n/a	PCB LEAF SPRING NEGATIVE AA/PP3 (RC)

Contacts and Clips	Page 1 of 2
The enclosed information is believed to be correct, Information may change 'without notice' due to product improvement. Users should ensure that the product is suitable for their use. E. & O. E.	Revision A 04/07/2003

RECOMMENDED LAYOUT FOR '9 VOLT' BATTERY

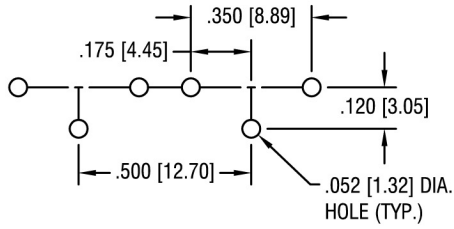

RECOMMENDED LAYOUT FOR 'AA' BATTERY USING ONE SPRING (P/N 590) AND ONE BUTTON (P/N 596) CONTACT

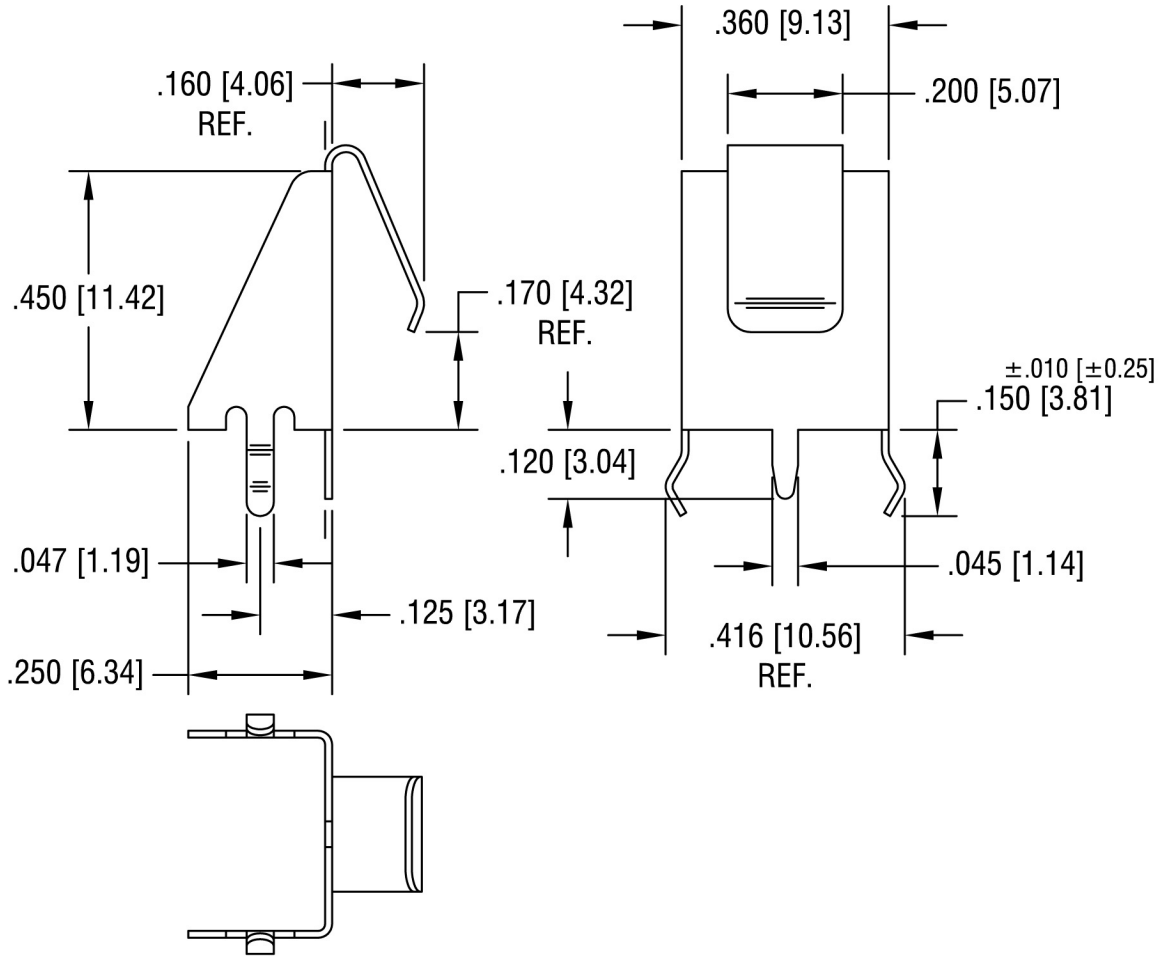
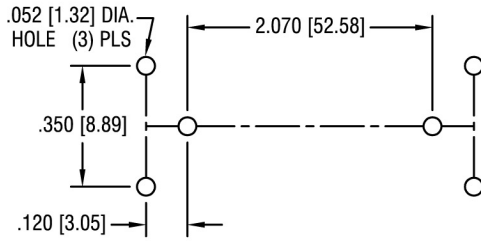

NOTE:

1. HEAT TREAT TO SPRING TEMPER.

8.26.04	CHANGE AS PER ECN 04-073	B
10.7.02	CHANGE AS PER ECN 02-066	A
DATE	DESCRIPTION	REV.

PART NAME			
'9V' 'AA' 'N' SNAP-IN SPRING CONTACT			
MATERIAL			
.012 [.30] TH'K ANNEALED SPRING STEEL			
FINISH		DRN BY	DATE
TIN NICKEL PLATE		BOONE	9.28.00
		APPD	SCALE
			3X
TOLERANCES		INCH	[MM]
DECIMAL		± .005	[± 0.15]
ANGULAR		± 1°	
UNLESS OTHERWISE SPECIFIED		CODE	DWG NO.
		C	590