

**Specifications:**

- 1.0 Voltage rating: 30V (DC)
- 1.1 Contact current rating: 1.5A max. per pin
- 1.2 Contact resistance: 30mΩ max.
- 1.3 Dielectric withstanding voltage: 500V AC for 1 minute
- 1.4 Insulation resistance: 1000MΩ min.
- 1.5 Operating temperature: -20°C to +70°C

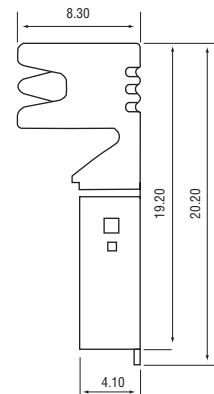
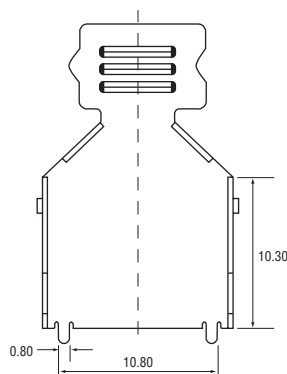
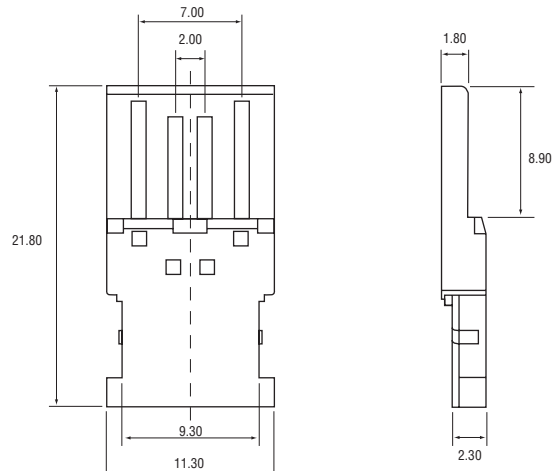
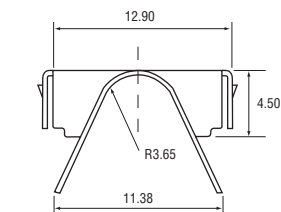
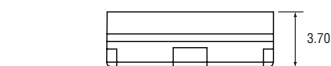

Housing with contact

Upper shell

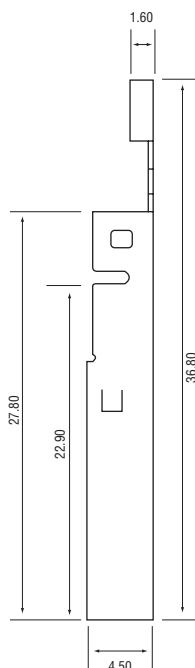
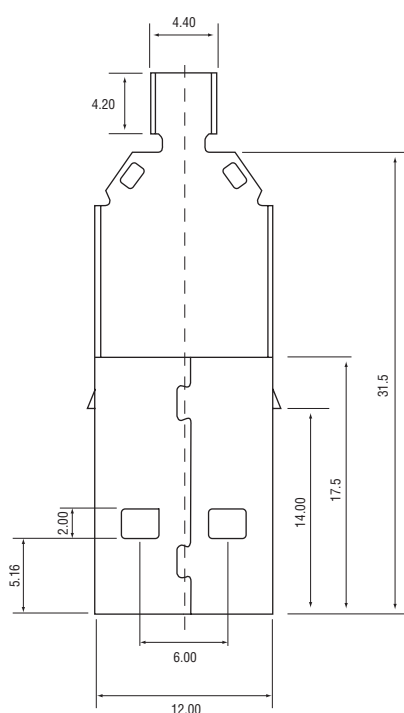

Down shell