

SPECIFICATION FOR APPROVAL



CUSTOMER : _____
CUSTOMER P/N : _____
SME P/N : _____ SF-70A
EDITION : _____ A.0
DATE : _____ 2012-7-24

DRAWING		
MADE	CHECK	APPROVAL
Lee Jin	Jim	Lucy

CUSTOMER APPROVE

SHANGHAI MEISONGBEI ELECTRONICS CO.,LTD

Add: No.139, Lane 4501, South Yanggao Rd, PuDong New District, Shanghai

Tel:+86-21-62883517 Fax:+86-21-62883519

Http://www.meisongbei.com

E-mail:meisongbei@globalsources.com

SPECIFICATION FOR APPROVAL

Customer:
 Customer P/N:
 SME P/N: SF-70A
 Date: 2012-7-24



A Dimension:Unit(mm)

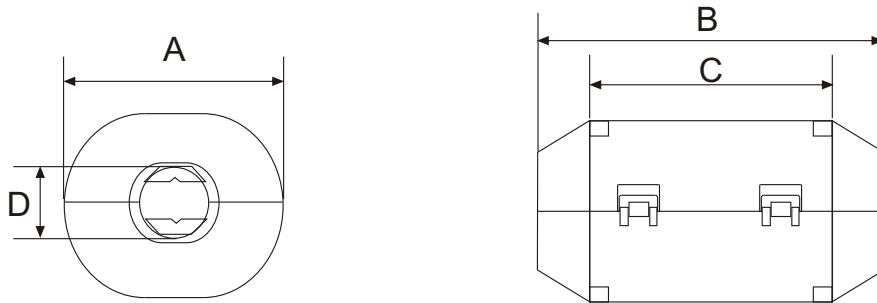

Part No.	A	B	C	D	E
SF-70A	16 ± 1.0	30 ± 1.0	23 ± 1.0	7 ± 1.0	

B Electrical Characteristics

Part No.	Test condition		Value	Unit	Tol.
Impedance @ 25MHz 0.5Ts	25MHz	Z	50	Ω	MIN.
Impedance @ 100MHz 0.5Ts	100MHz	Z	115	Ω	MIN.

C Test equipment:

1. Test equipment: HP-4191A
2. Test coil specification: Φ0.65x0.5Tsx100mm

D General Specifications:

1. Storage temp range: 0°C to +40°C
2. Operating temp range: -25°C to +105°C

Made	Lee Jin	Checked	Jim	Approved	Lucy
------	---------	---------	-----	----------	------

Shanghai Meisongbei Electronics Co.,Ltd.

SPECIFICATION FOR APPROVAL

Customer:
Customer P/N:
SME P/N: SF-70A
Date: 2012-7-24



Page 2 / 3

E Typical Impedance Characteristics:

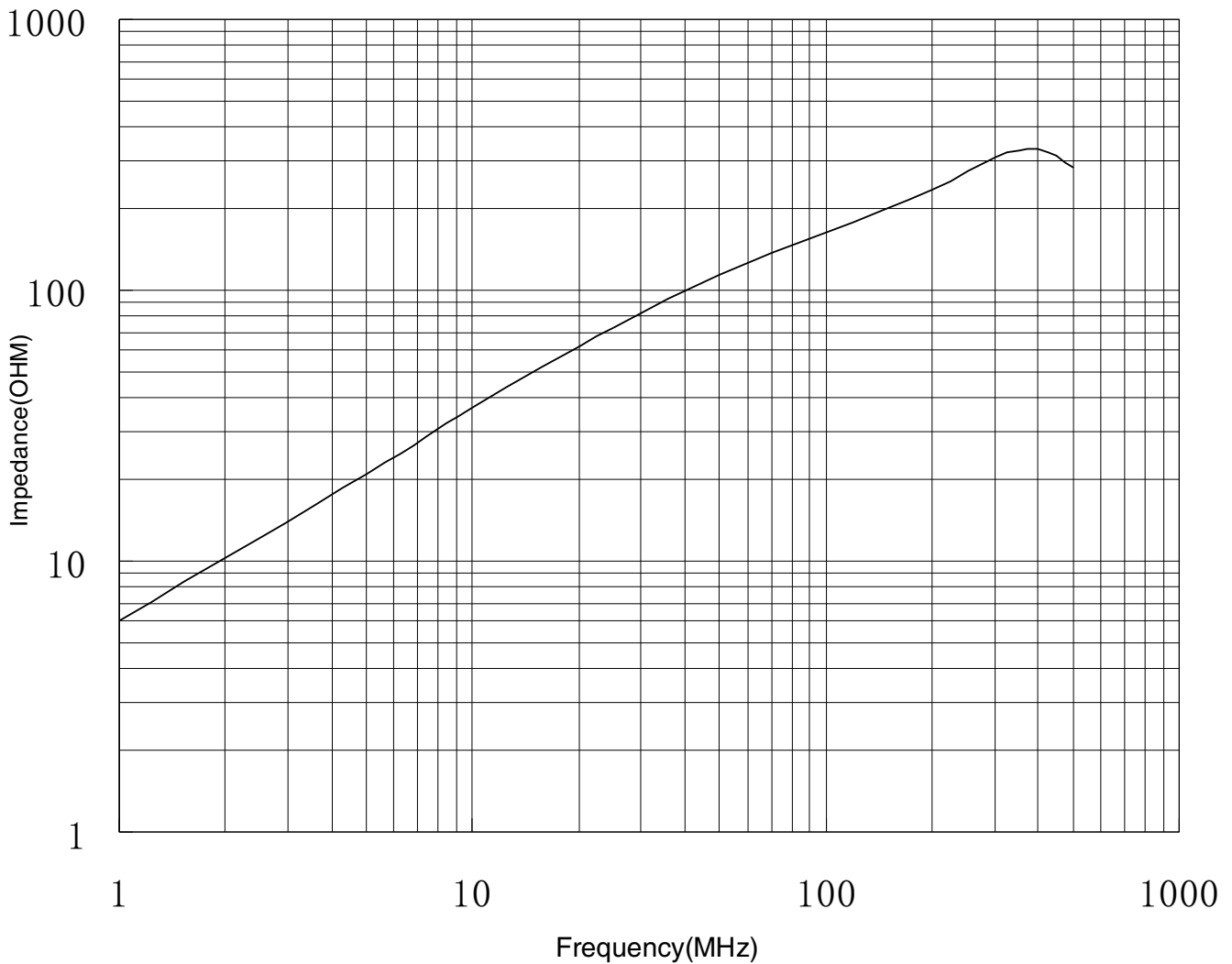

Made	Lee Jin	Checked	Jim	Approved	Lucy
------	---------	---------	-----	----------	------

Shanghai Meisongbei Electronics Co., Ltd.

Add: No.139, Lane 4501, South Yanggao Rd, PuDong New District, Shanghai Tel:+86-21-62883517 Fax:+86-21-62883519
Http://www.meisongbei.com

SPECIFICATION FOR APPROVAL

Customer:
 Customer P/N:
 SME P/N: SF-70A
 Date: 2012-7-24



F Test Data List:

ITEM	Dimensions					Z Φ0.65x0.5Tsx100L(mm)		
	A	B	C	D	E	25MHZ	100MHZ	
Spec	16.0±1.0	30±1.0	25.3±1.0	7.0±1.0		50 min	115 min	
1	16.01	30.02	23.05	7.05		71	164	
2	16.05	30.05	23.05	7.06		72	163	
3	16.02	30.06	23.06	7.04		71	164	
4	16.03	30.08	23.08	7.00		72	163	
5	16.05	30.06	23.06	7.05		72	165	
6	16.07	30.07	23.08	7.03		71	166	
7	16.08	30.05	23.08	7.05		71	164	
8	16.08	30.06	23.04	7.05		70	163	
9	16.07	30.04	23.06	7.06		71	164	
10	16.09	30.05	23.01	7.01		71	163	
\bar{X}	16.055	30.054	23.057	7.040		71.2	163.9	
Result	OK	OK	OK	OK		OK	OK	

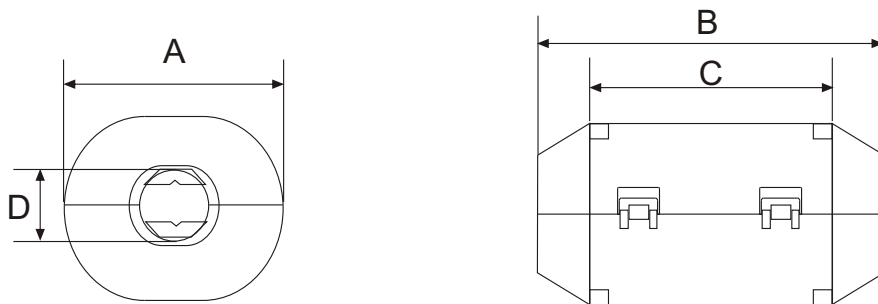

Made	Lee Jin	Checked	Jim	Approved	Lucy
------	---------	---------	-----	----------	------

Shanghai Meisongbei Electronics Co.,Ltd.

Add: No.139, Lane 4501, South Yanggao Rd, PuDong New District, Shanghai Tel:+86-21-62883517 Fax:+86-21-62883519
 Http://www.meisongbei.com