

# SPECIFICATION FOR APPROVAL



CUSTOMER : \_\_\_\_\_

CUSTOMER P/N : \_\_\_\_\_

SME P/N : \_\_\_\_\_ SF-90A

EDITION : \_\_\_\_\_ A.0

DATE : \_\_\_\_\_ 2012-7-24

| DRAWING |       |          |
|---------|-------|----------|
| MADE    | CHECK | APPROVAL |
| Lee Jin | Jim   | Lucy     |

| CUSTOMER APPROVE |
|------------------|
|                  |

## SHANGHAI MEISONGBEI ELECTRONICS CO.,LTD

Add: No.139, Lane 4501, South Yanggao Rd, PuDong New District, Shanghai

Tel:+86-21-62883517 Fax:+86-21-62883519

Http://www.meisongbei.com

E-mail:meisongbei@globalsources.com

# SPECIFICATION FOR APPROVAL

Customer:  
 Customer P/N:  
 SME P/N: SF-90A  
 Date: 2012-7-24



## A Dimension:Unit(mm)

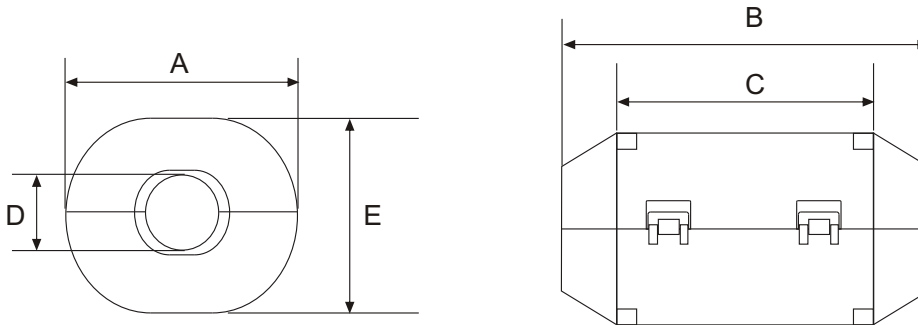

| Part No. | A          | B        | C        | D       | E          |
|----------|------------|----------|----------|---------|------------|
| SF-90A   | 19.5 ± 1.0 | 35 ± 1.0 | 28 ± 1.0 | 9 ± 1.0 | 17.4 ± 1.0 |

## B Electrical Characteristics

| Part No.                 | Test condition |   | Value | Unit | Tol. |
|--------------------------|----------------|---|-------|------|------|
| Impedance @ 25MHz 0.5Ts  | 25MHz          | Z | 60    | Ω    | MIN. |
| Impedance @ 100MHz 0.5Ts | 100MHz         | Z | 130   | Ω    | MIN. |

### C Test equipment:

1. Test equipment: HP-4191A
2. Test coil specification: Φ0.65x0.5Tsx100mm

### D General Specifications:

1. Storage temp range: 0°C to +40°C
2. Operating temp range: -25°C to +105°C

|      |         |         |     |          |      |
|------|---------|---------|-----|----------|------|
| Made | Lee Jin | Checked | Jim | Approved | Lucy |
|------|---------|---------|-----|----------|------|

**Shanghai Meisongbei Electronics Co.,Ltd.**

Add: No.139, Lane 4501, South Yanggao Rd, PuDong New District, Shanghai Tel:+86-21-62883517 Fax:+86-21-62883519  
 Http://www.meisongbei.com

# SPECIFICATION FOR APPROVAL

Customer:  
Customer P/N:  
SME P/N: SF-90A  
Date: 2012-7-24



Page 2 / 3

## E Typical Impedance Characteristics:

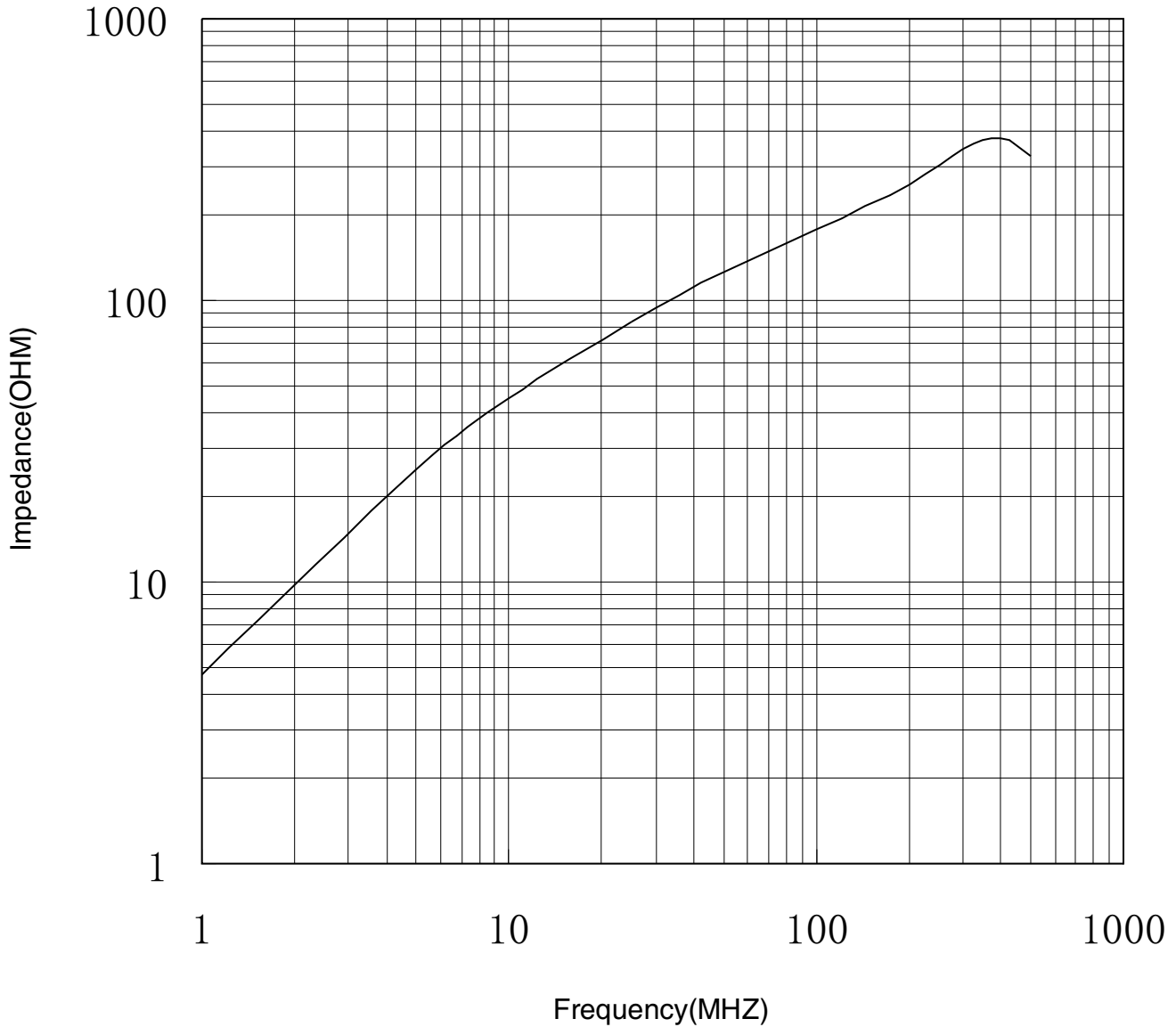

|      |         |         |     |          |      |
|------|---------|---------|-----|----------|------|
| Made | Lee Jin | Checked | Jim | Approved | Lucy |
|------|---------|---------|-----|----------|------|

**Shanghai Meisongbei Electronics Co., Ltd.**

Add: No.139, Lane 4501, South Yanggao Rd, PuDong New District, Shanghai Tel:+86-21-62883517 Fax:+86-21-62883519  
Http://www.meisongbei.com

# SPECIFICATION FOR APPROVAL

Customer:  
 Customer P/N:  
 SME P/N: SF-90A  
 Date: 2012-7-24



**F Test Data List:**

| ITEM      | Dimensions |          |          |         |          | Z Φ0.65x0.5Tsx100L(mm) |         |  |
|-----------|------------|----------|----------|---------|----------|------------------------|---------|--|
|           | A          | B        | C        | D       | E        | 25MHZ                  | 100MHZ  |  |
| Spec      | 19.5±1.0   | 35.0±1.0 | 28.0±1.0 | 9.0±1.0 | 17.4±1.0 | 60 min                 | 130 min |  |
| 1         | 19.55      | 34.99    | 28.05    | 8.99    | 17.40    | 83                     | 185     |  |
| 2         | 19.54      | 35.06    | 28.04    | 9.00    | 17.39    | 82                     | 185     |  |
| 3         | 19.53      | 35.01    | 28.05    | 8.96    | 17.35    | 83                     | 182     |  |
| 4         | 19.52      | 35.02    | 27.96    | 9.06    | 17.38    | 82                     | 184     |  |
| 5         | 19.51      | 35.02    | 28.03    | 9.01    | 17.39    | 80                     | 184     |  |
| 6         | 19.52      | 34.98    | 28.02    | 9.05    | 17.36    | 82                     | 185     |  |
| 7         | 19.51      | 34.97    | 28.05    | 9.01    | 17.45    | 83                     | 184     |  |
| 8         | 19.52      | 34.97    | 28.01    | 9.05    | 17.37    | 80                     | 183     |  |
| 9         | 19.50      | 35.00    | 28.03    | 9.04    | 17.39    | 82                     | 184     |  |
| 10        | 19.50      | 35.04    | 28.08    | 9.03    | 17.42    | 83                     | 185     |  |
| $\bar{X}$ | 19.520     | 35.006   | 28.032   | 9.020   | 17.39    | 82                     | 184.1   |  |
| Result    | OK         | OK       | OK       | OK      | OK       | OK                     | OK      |  |

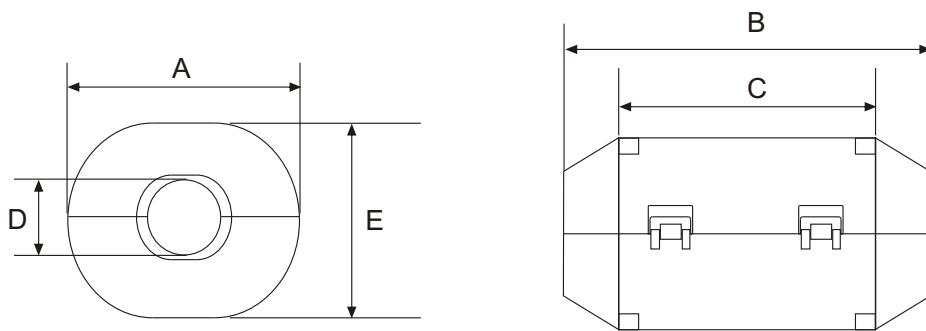

|      |         |         |     |          |      |
|------|---------|---------|-----|----------|------|
| Made | Lee Jin | Checked | Jim | Approved | Lucy |
|------|---------|---------|-----|----------|------|

**Shanghai Meisongbei Electronics Co.,Ltd.**

Add: No.139, Lane 4501, South Yanggao Rd, PuDong New District, Shanghai Tel:+86-21-62883517 Fax:+86-21-62883519  
 Http://www.meisongbei.com