

Speaker Sound Generator



DESCRIPTION

A low-cost, low-power sound generator that can produce a sound level of up to 83dB.

DISTINCTIVE FEATURES

- Compact design
- Impedance 8Ω
- Suitable for soldering directly to a circuit board

APPLICATIONS

This module is designed for fitting to a PCB and is ideal for use in toys and other small or portable applications.

Ø 30
mm

150
mW

8Ω

83dB



ELECTRICAL SPECIFICATION

Input nom.	0.15W
Input max.	0.30W
Rated Impedance	8Ω



GENERAL SPECIFICATION

Type	Speaker Sound Generator
Resonant Frequency	1.2kHz ± 0.2kHz
Frequency Range	700Hz to 50kHz
Sound Pressure Level min.	83dB @ 1.2kHz 1.1Vms Sine Wave/10cm



MATERIALS

Material	ABS
Colour	Black



ENVIRONMENTAL/OPERATING SPECIFICATION

Operating Temperature	-20°C to +90°C
-----------------------	----------------



TERMINALS

Terminals	Solder pins
Terminal Pitch	15mm
Terminal Length	8mm



DIMENSIONS/DRAWINGS

Units	mm - unless stated otherwise
Dimensions	Ø30 x 11mm
Weight	12g

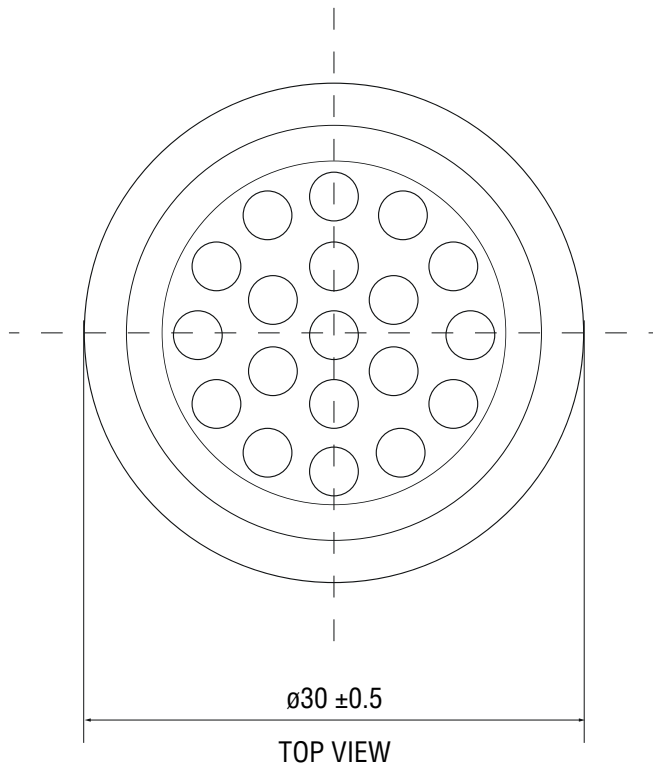
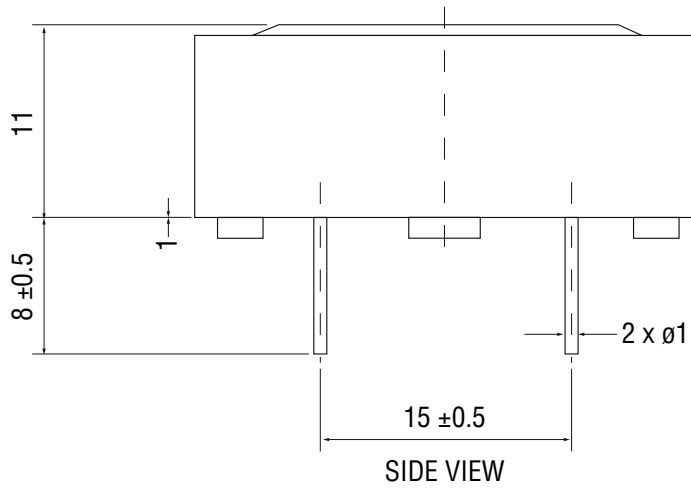

FREQUENCY RESPONSE (Actual curve of type)

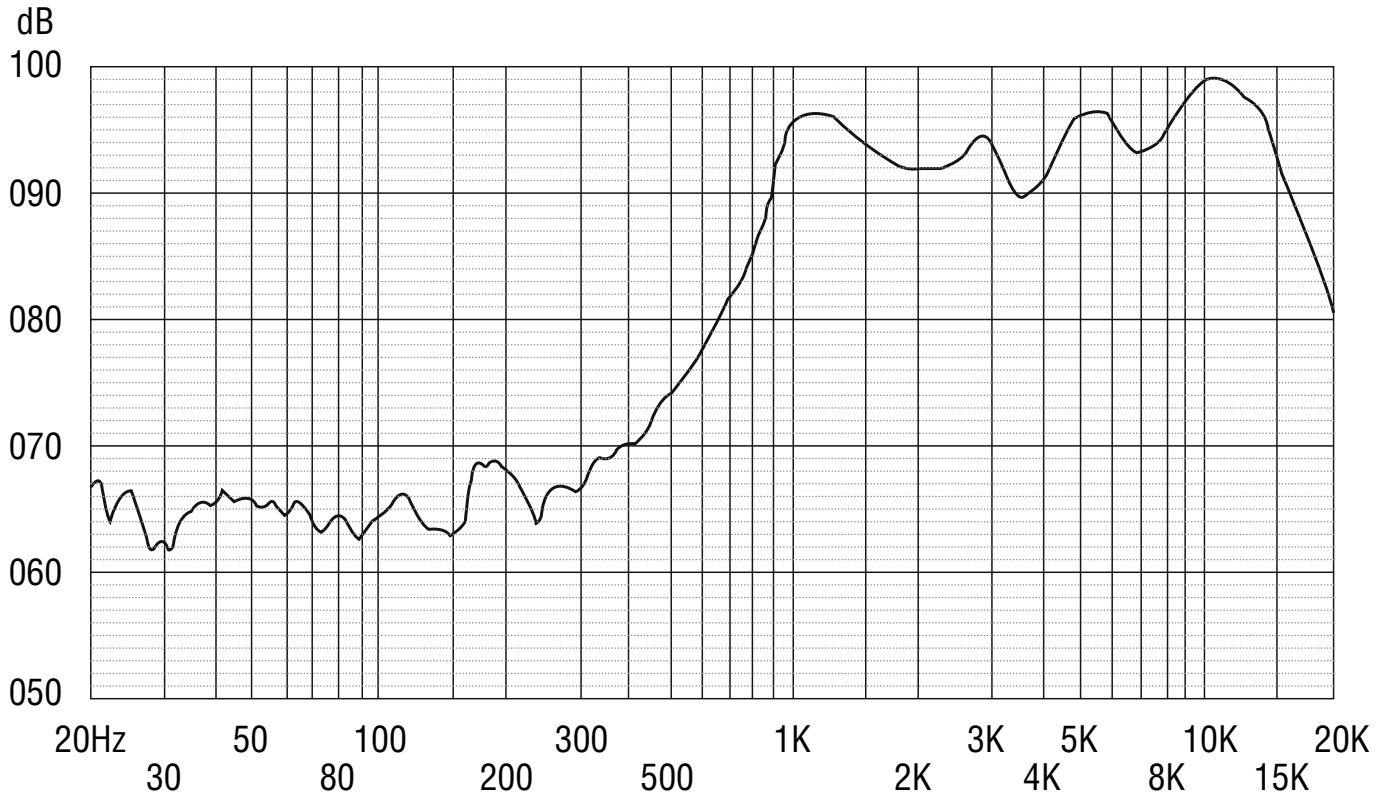

Applied voltage: 12 vp-p. 1/2 duty, sine wave
Distance for measurement: 10cm



PART NUMBER TABLE

Part Number	EAN	UNSPSC	Country of Origin
35-0900	5053556002092	46171607	China

R-TECH

Tried & trusted technology

Important Notice: This data sheet and its contents (the "Information") belong to Rapid Electronics Limited or are licensed to it. No licence is granted for the use of it other than for information purposes in connection with the products to which it relates. No licence of any intellectual property rights is granted. The Information is subject to change without notice and replaces all data sheets previously supplied. The Information supplied is believed to be accurate but Rapid Electronics Limited assumes no responsibility for its accuracy or completeness, any error in or omission from it or for any use made of it. Users of this data sheet should check for themselves the Information and the suitability of the products for their purpose and not make any assumptions based on information included or omitted. Liability for loss or damage resulting from any reliance on the Information or use of it (including liability resulting from negligence or where Rapid Electronics Limited were aware of the possibility of such loss or damage arising) is excluded. This will not operate to limit or restrict Rapid Electronics Limited's liability for death or personal injury resulting from its negligence.