

# EAO – Your Expert Partner for Human Machine Interfaces

## 45-290H.1000.111 - Keylock switch actuator 2 positions

### 45-290H.1000.111 - Keylock switch actuator 2 positions



*Attention: The preview is based on a sample product. This can differ from your current configuration.*

#### Mounting

Mounting cut-out 22.5 mm  
Design raised

#### Front

Front ring material Plastic  
Front ring colour black  
Front shape round  
Front dimension Ø 29.45 mm

#### Other Attributes

Weight 0.046 kg

#### Operating-/Indication part

Switching angle C = 90°

#### IP-Rating

Front protection IP66, IP67, IP69K

#### Actuator

Key remove A + C  
Switching action Rest - Maintained  
Housing material Plastic

#### Switching element

Rotary positions 2  
max. number of switching elements 6

#### Function

Keylock switch

# EAO – Your Expert Partner for Human Machine Interfaces

45-290H.1000.111 - Keylock switch actuator 2 positions

## Dimensions

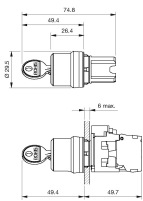

## Mounting cut-outs

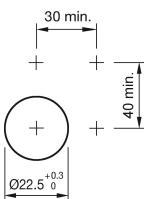

## Wiring diagram



## Switching positions

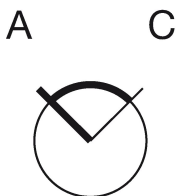

## Additional information

The standard lock: RONIS, T254

## Legend

Switching action: A = Rest, B = Momentary