

Miniature Quick Wire Sockets

Types K, J, T
(ANSI Colour Code)



- Miniature quick wire socket allowing rapid termination of wires
- Easy 'jab-in' connection, just push-in wire & tighten screw
- Available in Thermocouple types K, J, T
- For Types K, J, T contacts are made from true Thermocouple alloys
- Contacts are polarised to prevent incorrect connection
- Colour coded in accordance with ANSI specification
- Maximum continuous temperature 220 deg°C

T/C Type	Colour Code (ANSI)	+Positive Contact (alloy type)	-Negative Contact (alloy type)	Manufacturer's Part Number	Rapid Order Code
K	Yellow	+Nickel Chromium	-Nickel Alloy	XE-1142-001	61-3058
J	Black	+Iron	-Copper Nickel	XE-9072-001	61-3059
T	Blue	+Copper	-Copper Nickel	XE-1232-001	61-3060

Schematic Drawing

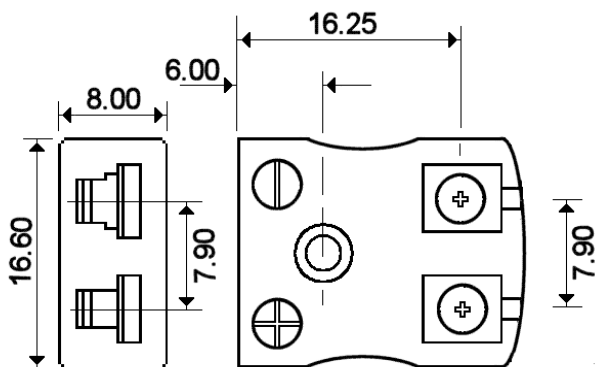

Quick-Wire Miniature Socket