

DAILY POWER BATTERIES LIMITED

4LR44

TECHNICAL SPECIFICATION FOR ALKALINE MANGANESE BATTERY

PREPARED BY:

APPROVED BY:

DATE: January 3, 2002

SPEC.NO.: REF----R44----0102

DAILY POWER BATTERIES LTD.

Room 15, 12/F., Hewlett Centre, 54 Hoi Yuen Road, Kwun Tong, Kowloon, H.K.

Tel: (852) 2343 0818 Fax: (852) 2341 9839

E-mail: sales@dpbatteries.com.hk

<http://www.dpbatteries.com.hk>

(Manufacturer reserves the right to alter or amend the design, model and specification without prior notice.)

1.Other name for the same type

L1325 4LR44

2.Chemical SystemAlkaline Zinc—Manganese battery (+) Zn | KOH | MnO₂ (-)**3.Nominal Voltage: 6.0V****4.Average Weight: 9.97g****5.Nominal Capacity: 145mAh**

(continuous discharge at 20±2 under 0.22mA discharge current to 3.60V voltage)

6.Appearance : Metal Can**7.Electrical Characteristics:**

7.1 Off—load Voltage:

New Battery 6.05V

After 12 Months (Room Temp.) 6.00V

7.2 Discharge Time(continuous discharge at 20±2 under 7.5K discharge load to 3.60V voltage)

New Battery 190 hours

After 12 Months (Room Temp.) 170 hours

7.3 Over—discharge Characteristic

Condition: 7.5K continuous discharge at 20±2 &65±20%R.H.

Period: 48hours

Characteristic: No deformation is over 0.20mm of the nominal dimension,
and no visual electrolyte leakage

8. Dimensions:

Nominal Dimension: $\phi 13.00 \times 25.20$

(Unit: mm)

Dimension	Range
A(ref.)	0.80
B	24.85 ± 0.25
C	12.70 ± 0.15
D(ref.)	0.20

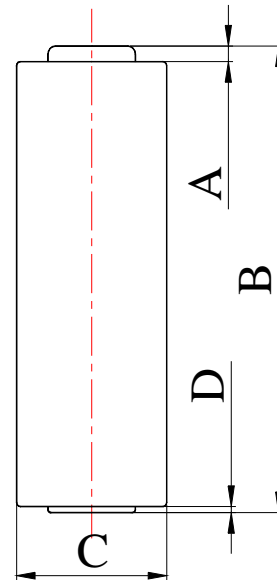

9. Typical Discharge Characteristics

(continuous discharge at 20 ± 2 under 7.5K discharge load to 3.60V voltage)

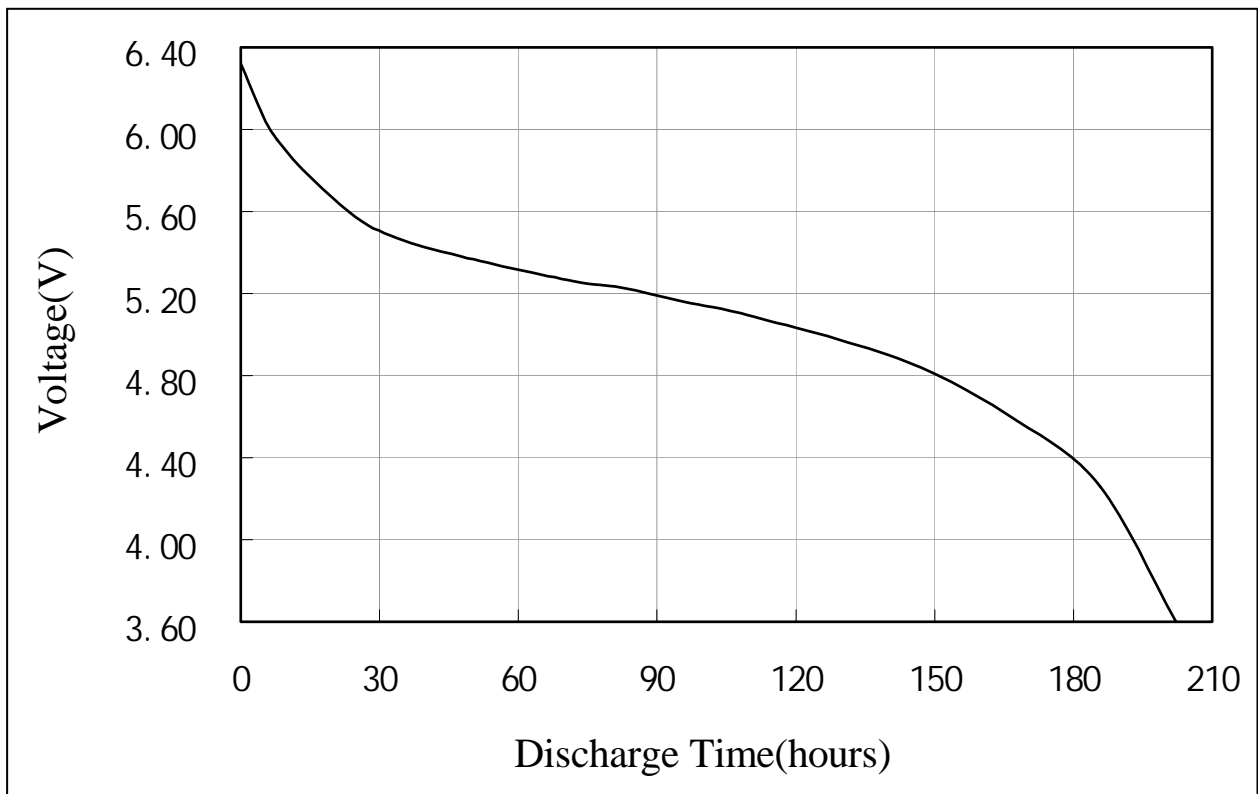

10. Mark:

The following message will be printed or stamped on the body of the battery:

10.1 Designation: 4LR44、 L1325 etc.

10.2 Manufacturer's name: Daily Power Batteries LTD.

10.3 Trademark: DPOWER.

10.4 Nominal Voltage: 6V.

10.5: Pole: “+” and “-”.

10.6 Warning: May explode or leak if charged or disposed of in fire.

11. Caution for use :

11.1 There are risks of electrolyte leakage or causing damage to the device if the battery is charged;

11.2 The battery shall be installed with “+”and “-” in correct position;

11.3 Short-circuiting and heating the battery、 disposing of the can must not be permitted.

—————END—————