

(CONTACTS-1)x2.54

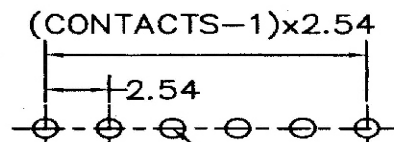

Recommended P.C.Board Layout
ø 1.02

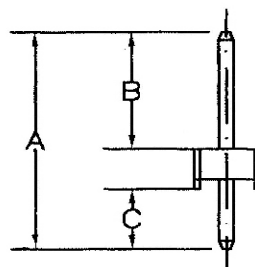
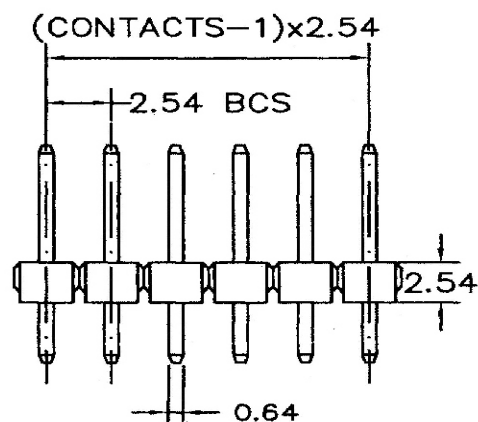

SPECIFICATIONS

Current Rating: 3 Amperes

Insulation Resistance: 1000MΩ Min

Dielectric Withstanding: 600V AC/DC

Contact Resistance: 20mΩ Max.

Operating Temperature: -40°C to +105°C

MATERIALS

Contact Material: Copper Alloy

Contact Plating: Gold / Tin over Nickel

Insulator: Glass Filled Polyester (UL 94V-0)

P.B.T or Nylon-6T

All materials must be RoHS compliant.

| Terminal Code | Dimensions(mm) | | |
|----------------|----------------|-------|------|
| | A | B | C |
| PA | 10.20 | 5.20 | 2.50 |
| XPB | 10.80 | 5.80 | 2.50 |
| PC | 11.60 | 5.80 | 3.30 |
| PD | 12.60 | 6.80 | 3.30 |
| PE | 14.00 | 8.20 | 3.30 |
| PF | 14.80 | 9.00 | 3.30 |
| PG | 17.90 | 12.10 | 3.30 |
| XPH | 19.80 | 14.00 | 3.30 |
| PJ | 21.60 | 15.80 | 3.30 |
| PK | 22.80 | 17.00 | 3.30 |
| PL | 24.90 | 19.10 | 3.30 |
| NF | 11.60 | 6.00 | 3.10 |
| NG | 11.80 | 6.00 | 3.30 |
| NH | 12.60 | 7.00 | 3.10 |
| NJ | 13.50 | 8.00 | 3.00 |
| NK | 14.20 | 8.70 | 3.00 |
| NL | 16.00 | 10.50 | 3.00 |
| NM | 18.00 | 12.50 | 3.00 |
| NN | 20.00 | 14.50 | 3.00 |
| TK | 14.50 | 8.90 | 3.10 |
| TL | 11.30 | 5.50 | 3.30 |
| TF | 11.80 | 5.70 | 3.60 |

Datenblatt passend zu folgenden Artikelnummern

10120500 / 10120502 / 10120504 / 10120506 / 10120508 / 10120510

10120182 / 10120183 / 10120184