



---

# Expert Tool Chests & Roller Cabinets

---

## INSTRUCTIONS

---

### 1. HEALTH & SAFETY INFORMATION

---

- WEAR SAFETY GLASSES AND GLOVES when removing strapping and packaging materials. Straps can snap when removed causing personal injury.
- WEAR SAFETY GLASSES when replacing or repositioning ball bearing drawer slides.
- DO NOT pull this product-push the product to prevent personal injury.
- Swivel castor and push bar must be placed on same side of the product.
- USE THE BRAKE when this product is not being moved. The brake will prevent accidental rolling which may product damage or personal injury.
- DO NOT open more than one drawer at a time as this may cause the product to tip causing personal injury or product damage.
- DO NOT alter this product by welding attachment or adding electrical equipment. Do not mount this product on a moving object or vehicle as this may cause personal injury or product damage.
- DO NOT tow this product with moving equipment or vehicles as this may cause product to tip, causing personal injury or product damage.
- DO NOT step in drawers or on top of unit as this may cause the product to tip. This may cause personal injury or product damage.
- Take caution when closing the cover and remove hands before cover is closed completely.
- Maximum drawer weight capacity should not exceed 45kg (100lb).
- Maximum product weight (including contents) should not exceed 450kg (1000lb).
- To lock a chest, close drawers before closing lid, making sure all drawers are firmly closed to ensure proper function of locking bars.
- Always use the proper sized cabinet and chest combination. Improper matching of cabinet and chest components can cause the product to tip which may result in personal injury or product damage.
- DO NOT use the product on uneven surfaces or inclines as this may cause the product to tip or become unstable resulting in possible personal injury or product damage.
- Remove work surface (if provided) before mounting top chest. If work surface is not removed, the top chest may slide off cabinet causing personal injury or product damage.

## 2. PREPARING THE TOOL CHEST

### 2.1 PUSH BAR ATTACHMENT (ROLLER CABINETS ONLY) - FIG.1

NOTE: Holes in the unit are tapped requiring no nuts for installation.

Attach the handle using four(M8X25) hex screws. Do not over tighten the screws.

FIG.1

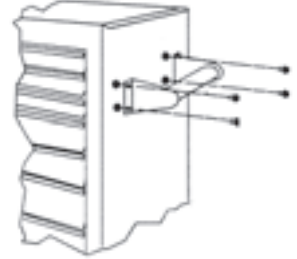

### 2.2 REMOVING AND INSTALLING DRAWERS - FIG. 2

Completely empty the drawer.

Fully extend drawer.

LEFT SIDE: Push the locking tab down and hold.

RIGHT SIDE: Pull the locking tab up and hold.

Pull out the drawer to remove.

To reinstall, push the drawer into the slides until the drawer stops.

FIG.2

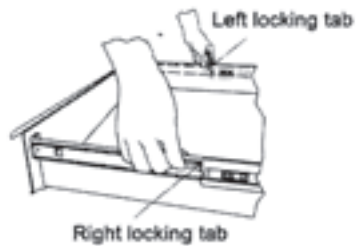

### 2.3 TO REMOVE THE SLIDE - FIGS. 3 - 4

From the unit, first remove the drawer (follow the drawer removal procedure).

Turn the slide to the left (right) and hold.

Push the slide up to disengage Tab "A" from Slot "A".

Push the slide along to release Tab "B" into Slot "B".

The slide may now be removed.

FIG.3

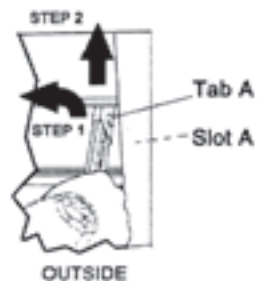

### 2.4 TO REINSTALL THE SLIDE

Place the slide in the appropriate position, pull the slide and engage Tab "B" into Slot "B", then push the slide down to lock Tab "A" into Slot "A".

FIG.4

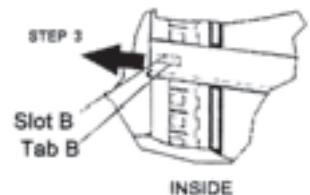

### 2.5 LUBRICATION

To ensure smooth operation of the sliders, lubricate periodically with a light grease. Do this at least twice a year.