

Easter Chick Project

What you will need:

- Wiggle eyes
- Polystyrene egg shapes
- Poster paint (Yellow)
- Pipe cleaners
- Exotic feathers
- Pritt Stick
- Paintbrushes

Quantity	Order code
Pack of 100	06-0184
Pack of 30	06-4032
600ml	06-0806
Pack of 100	06-0296
28g pack	06-7568
43g single	87-6028
Pack of 12	06-6272

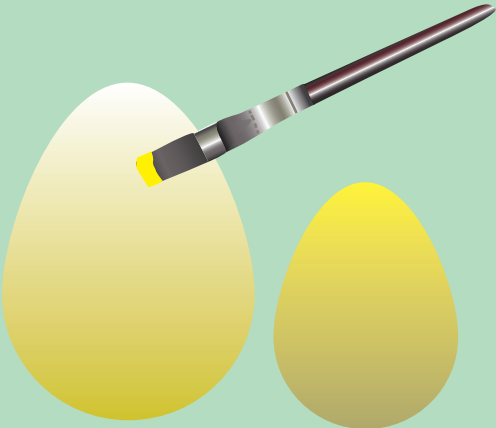

Step 1
Paint 1 big egg shape and 1 small egg shape with the yellow poster paint and leave to dry.



Step 2
While the eggs are drying, cut 1 pipe cleaner in half. Fold 1 piece in half, bending the 2 loose ends over at right angles. Repeat this with the second piece of pipe cleaner.



Step 3
Twist the 2 pieces together to make 1 leg. You may need to re-arrange the toes so you have 3 at the front and 1 at the back. Trim away any excess from the toes as necessary. Repeat steps 2 and 3 for the other leg.

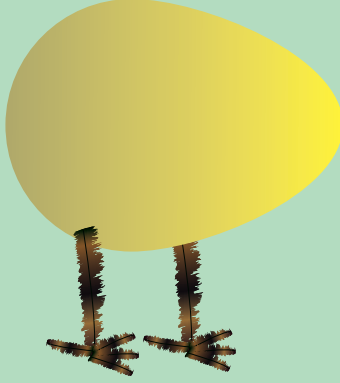

Step 4
Once the paint has dried on the eggs, push each leg into the large egg so it stands up.

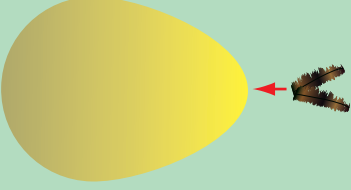

Step 5
To create the beak of your chicken, cut a piece of pipe cleaner approx 3cm long and fold in half so you get a 'V' shape. Push this into the front of the smaller egg shape.

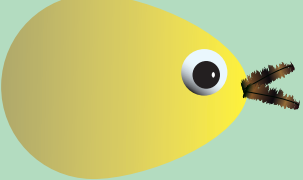

Step 6
Take a pair of wiggle eyes and stick on each side of the head.

For all materials and information see our website www.rapidonline.com

STEP-BY-STEP PROJECT

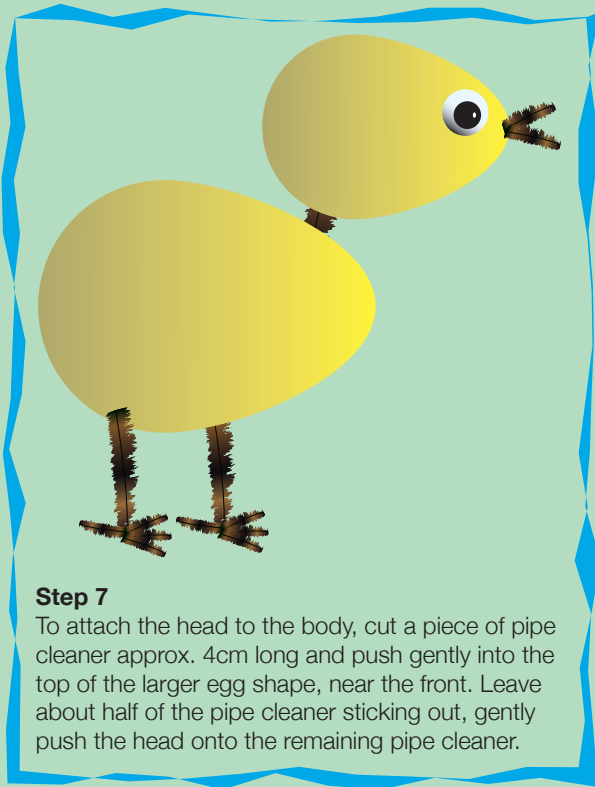

Step 7

To attach the head to the body, cut a piece of pipe cleaner approx. 4cm long and push gently into the top of the larger egg shape, near the front. Leave about half of the pipe cleaner sticking out, gently push the head onto the remaining pipe cleaner.

Step 8

From the bag of feathers, pick 4 larger coloured feathers and 1 smaller feather. Stick 2 of the larger feathers on each side of the bird and the smaller feather on the back of his head using Pritt Stick.



NOTES

Blank area for notes.

SBS EC 04/20