

Board-to-Wire Connectors  
Pitch 5.08 mm Floppy

Female Housing and Contacts



**SPECIFICATION:**

AWG (Max.):	AWG 18
AWG (Min.):	AWG 24
Operating Voltage (Max.):	250 V
Operating Temperature:	-25°C to 85°C
Insulation Resistance (Min.):	1000 MΩ
Cable Diameter (Max.):	3.7 mm
Contact Resistance (Max.):	20 mΩ
Dielectric Strength:	1,500 Vac

**MATERIAL:**

Material (Terminal):	brass, tin plated
Material (Housing):	nylon 66
Flammability Class:	UL 94 V-2

**TOLERANCE:**

.X:	± 0.30
.XX:	± 0.20

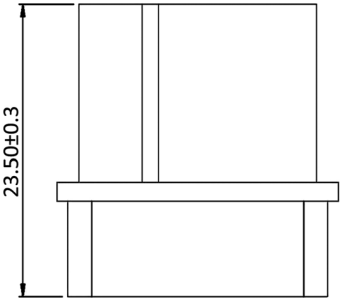
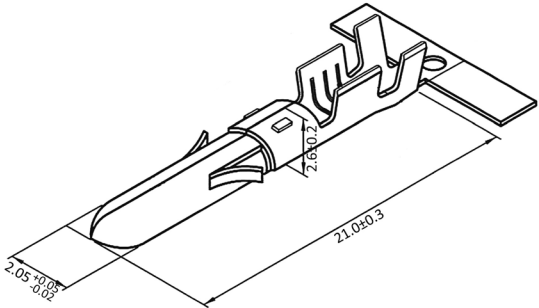
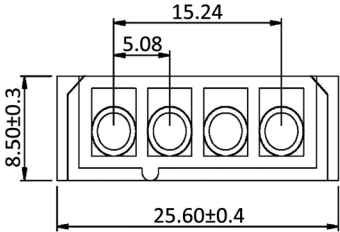

Order Information

Identifier:

FK05

Counterpart of power plug

Version:

#

empty: housing with four contacts

G: only housing

CR: only contact (100 pcs. separately cut)

CR7K: only contact (roll with 7.000 pcs.)