

# D-Sub PCB

Male Connectors, tin plated



RoHS  
COMPLIANT

**SPECIFICATION:**

Current rating: 1 A  
 Insulation resistance: 500 MΩ min.  
 Contact resistance: 30 mΩ max.  
 Dielectric voltage: 500 V AC  
 Operation temperature: -40 °C to +70 °C

**MATERIAL:**

Insulator: PBT white UL94V-0  
 Shell: Steel  
 Pins: Brass

**FINISH:**

Contacts: Gold Flash  
 Front shell: Nickel plated  
 Rear shell: Tin plated

**HANDLING:**

Processing: Wave soldering  
 Packing: Tray

**TOLERANCE:**

.X ± 0.20  
 .XX ± 0.10

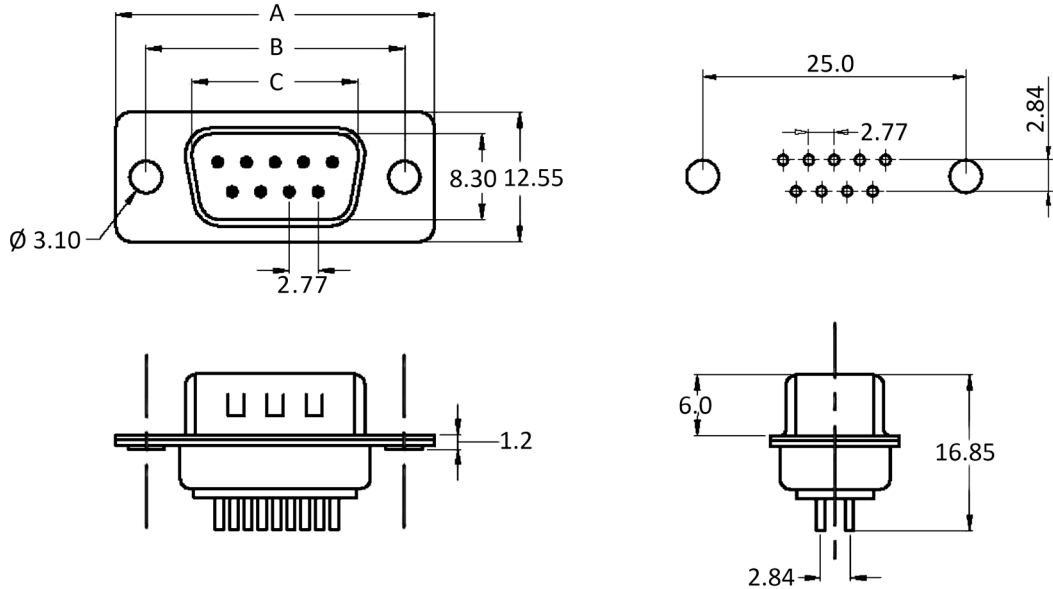
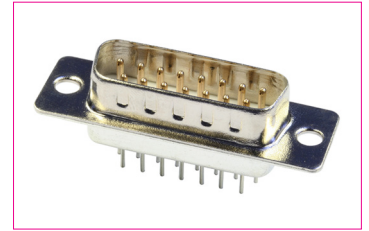

**Dimensions**

No. of contacts:	A:	B:	C:
9	30.85	25.00	16.92
15	39.25	33.35	25.25
19	44.80	38.86	30.60
23	50.30	44.30	35.90
25	53.10	47.04	38.96
37	69.40	63.50	55.42

**Order-Information**

Identifier:	No. of contacts:	Version:	Shell:
ST	#	P	V
D-Sub Male	9: 9 pin 15: 15 pin 19: 19 pin 23: 23 pin 25: 25 pin 37: 37 pin	P: Solder pins	V: Tin plated