

## D-Sub Plastic cover, Top cable entry, Male or Female jackscrew

## TECHNICAL SPECIFICATIONS

|                        |   |
|------------------------|---|
| Material:              | Glass Filled PBT<br>UL94 V-0  |
| Operating Temperature: | -55°C to +110°C   |
| Cable Entry:           | Top Entry   |
| Jackscrew:             | UNC 4-40<br>Male or Female Version  |
| Cable O.D:             | 9-way Up to 6,0mm<br>15-way Up to 7,0mm<br>25-way Up to 8,0mm<br>37-way Up to 9,0mm |
| Colour:                | Black   |

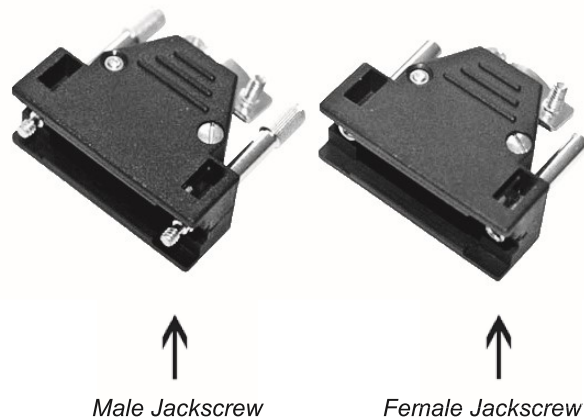

## Features:

- Suitable for sizes 9, 15, 25 and 37
- Easy to re-open
- Male or female Jackscrew
- Cable clamp located outside

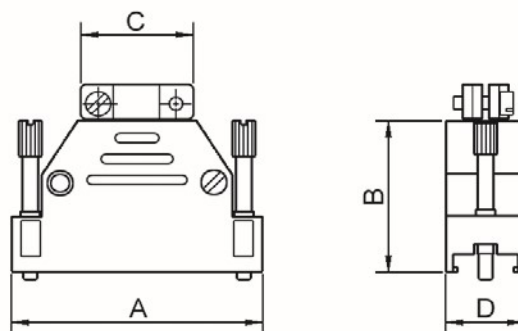

| Size | A    | B    | C    | D    |
|------|------|------|------|------|
| 9    | 31,4 | 24,0 | 14,5 | 18,2 |
| 15   | 42,0 | 30,0 | 14,5 | 18,2 |
| 25   | 55,5 | 36,0 | 25,1 | 18,2 |
| 37   | 69,8 | 38,0 | 39,2 | 18,2 |

## Ordering information: Male Jackscrew

| Size:           | P/N - Kitted: | Product Code: |
|-----------------|---------------|---------------|
| 9-way, Male JS  | 2801-0102-01  | ED-D09T-K     |
| 15-way, Male JS | 2801-0102-02  | ED-D15T-K     |
| 25-way, Male JS | 2801-0102-03  | ED-D25T-K     |
| 37-way, Male JS | 2801-0102-04  | ED-D37T-K     |

## Ordering information: Female Jackscrew

| Size:             | P/N - Kitted: | Product Code: |
|-------------------|---------------|---------------|
| 9-way, Female JS  | 2801-0102-11  | ED-D09TF-K    |
| 15-way, Female JS | 2801-0102-12  | ED-D15TF-K    |
| 25-way, Female JS | 2801-0102-13  | ED-D25TF-K    |
| 37-way, Female JS | 2801-0102-14  | ED-D37TF-K    |



Encitech AB  
Rörkullsvägen 4  
SE-302 41 HALMSTAD, Sweden

Tel: +46-(0)35-15 13 90  
e-mail: connectors@encitech.com

[www.encitech.com](http://www.encitech.com)