

Electronic housing - ME MAX 17,5 2-2 KMGY - 2713599

Please be informed that the data shown in this PDF Document is generated from our Online Catalog. Please find the complete data in the user's documentation. Our General Terms of Use for Downloads are valid (<http://download.phoenixcontact.com>)



Electronic housing consisting of: Housing shells left and right, front plate, transparent cover, metal foot catch and spring, open housing, 12-pos. (4 x 3 pos.), width: 17.5 mm, color: Light gray

Product Features

- DIN rail bus connector as an option
- Plug-in connection with screw, spring-cage or fast connection technology
- Labels for additional labeling as an option
- Large front surface for high-pos. plugs or operating and setting elements
- Large PCB surface despite compact housing dimensions
- The fitted cover is easy to adapt and print
- Easy module replacement without interrupting the contact chain
- Transparent front cover can be swiveled
- Functional earth ground contact as an option
- Fixed or plug-in connection technology can be combined on up to three connection levels, with different pitches

Key commercial data

package_quantity	10
GTIN	4017918917487

Technical data

General

Housing type	Complete housing
Housing material	Polyamide
Color	light gray

Ambient conditions

Ambient temperature (operation)	-40 °C ... 105 °C
--	-------------------

Dimensions

Length	99 mm
Constructional height	114.5 mm
Width	17.5 mm

Technical data

Inflammability class according to UL 94	V0
Power dissipation at 20°C in the horizontal mounting position	5.2 W 10.8 W
Number of positions	12

Electronic housing - ME MAX 17,5 2-2 KMGY - 2713599

Technical data

classifications

eCl@ss

eCl@ss 4.0	27180401
eCl@ss 4.1	27180401
eCl@ss 5.0	27180506
eCl@ss 5.1	27180506
eCl@ss 6.0	27180802
eCl@ss 7.0	27182702
eCl@ss 8.0	27182702

ETIM

ETIM 2.0	EC001031
ETIM 3.0	EC001031
ETIM 4.0	EC001031
ETIM 5.0	EC001031

UNSPSC

UNSPSC 6.01	31261501
UNSPSC 7.0901	31261501
UNSPSC 11	31261501
UNSPSC 12.01	31261501
UNSPSC 13.2	31261501

approvals

UL Recognized / cUL Recognized / cULus Recognized /

Approval details

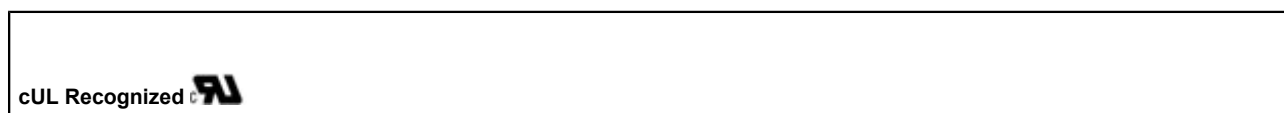
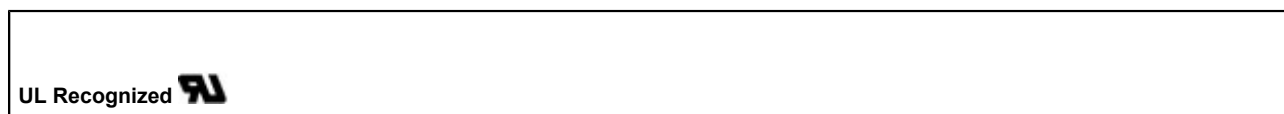

Electronic housing - ME MAX 17,5 2-2 KMGY - 2713599

accessories

Printed circuit board terminal

MKDSO 2,5/ 3-6 SET KMGY - 2713735



MKDSO 2,5/ 3-6 SET - 2707932



Printed circuit board housing

MSTBO 2,5/ 3-6 ST SET KMGY - 2713748



MSTBO 2,5/ 3-6 ST SET - 2707958



Filler plug

ME MAX B-17,5 KMGY - 2706959



Electronic housing - ME MAX 17,5 2-2 KMGY - 2713599

accessories

PCB

ME MAX LP SAMPLE MSTBO 2-2 - 2713777



Ground contact

ME FE-CONTACT - 2908294



Device marking

BMKLT 14X12 WH - 0813789



DIN rail connector

ME 17,5 TBUS 1,5/ 5-ST-3,81 GN - 2709561



Electronic housing - ME MAX 17,5 2-2 KMGY - 2713599

accessories

ME 17,5 TBUS 1,5/ 5-ST-3,81 KMGY - 2713645



ME MAX B-17,5 GN - 2706991

Drawings

Drilling diagram

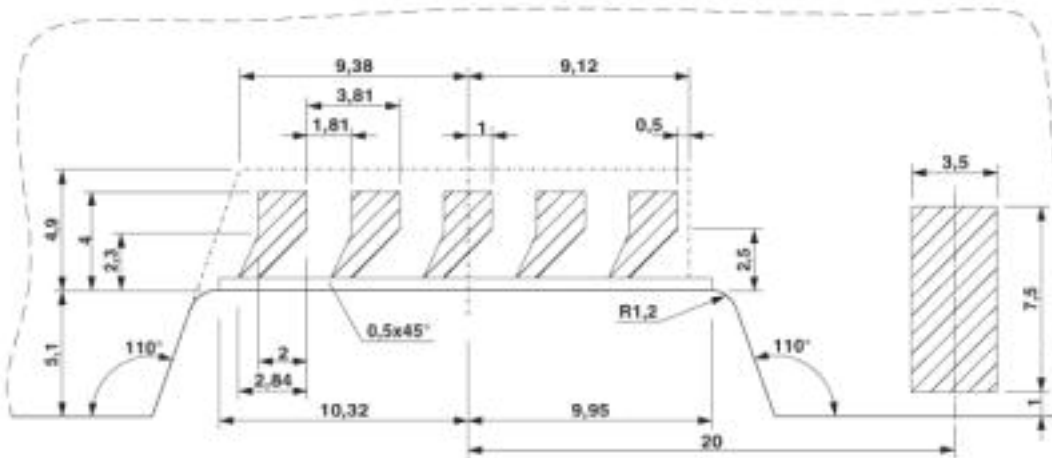

Detailed dimensional drawing of the DIN rail connector contact pads

Electronic housing - ME MAX 17,5 2-2 KMGY - 2713599

Explosion drawing

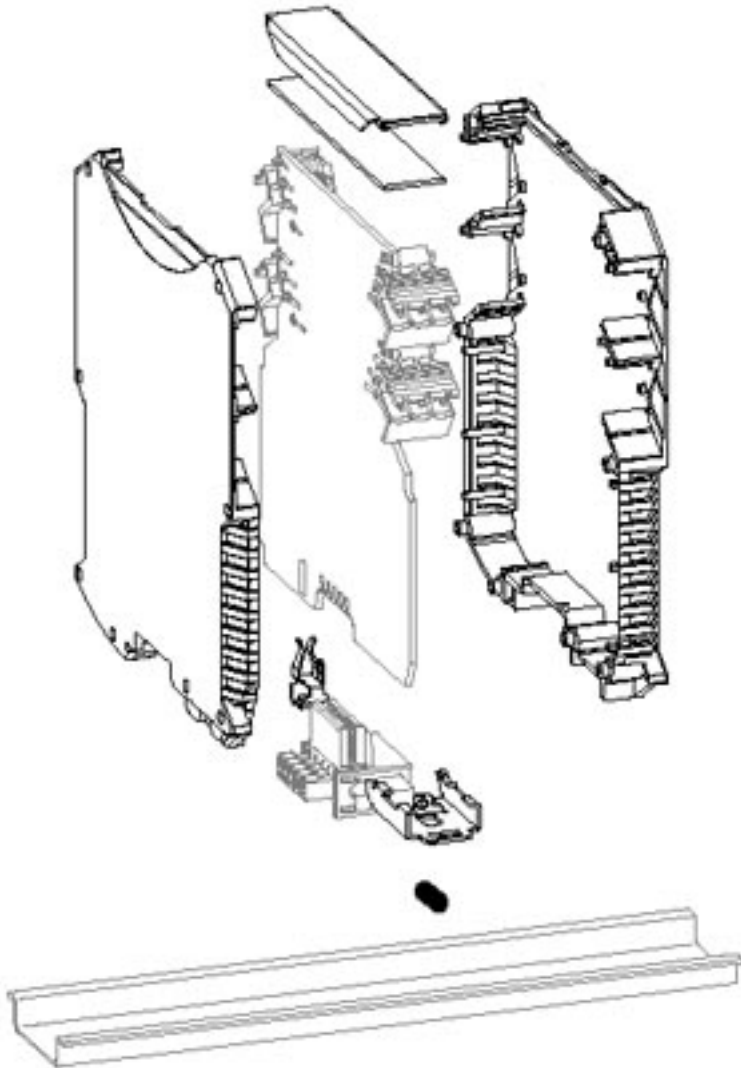

The illustration shows a version of the product (open housing) with accessories

Electronic housing - ME MAX 17,5 2-2 KMGY - 2713599

Dimensioned drawing

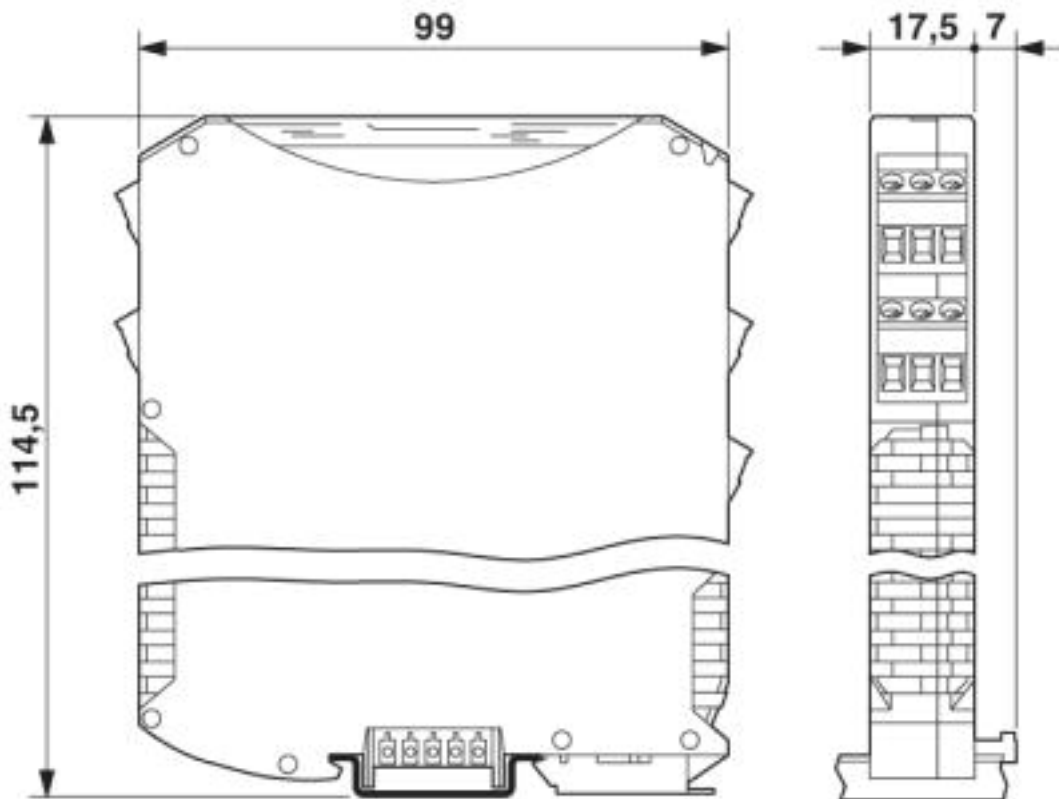

Electronic housing - ME MAX 17,5 2-2 KMGY - 2713599

Dimensioned drawing

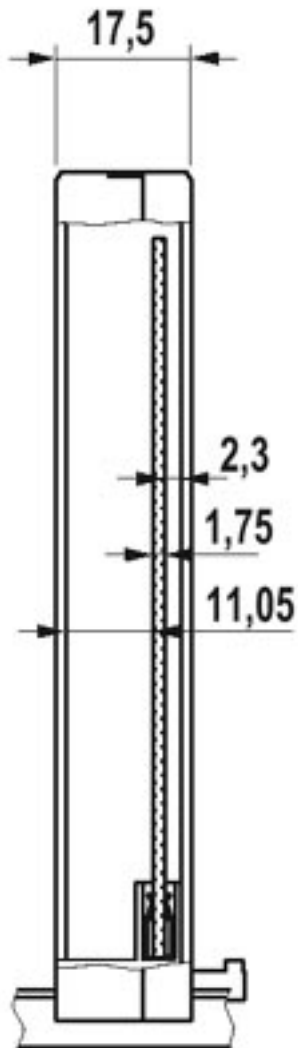

Electronic housing - ME MAX 17,5 2-2 KMGY - 2713599

Dimensioned drawing

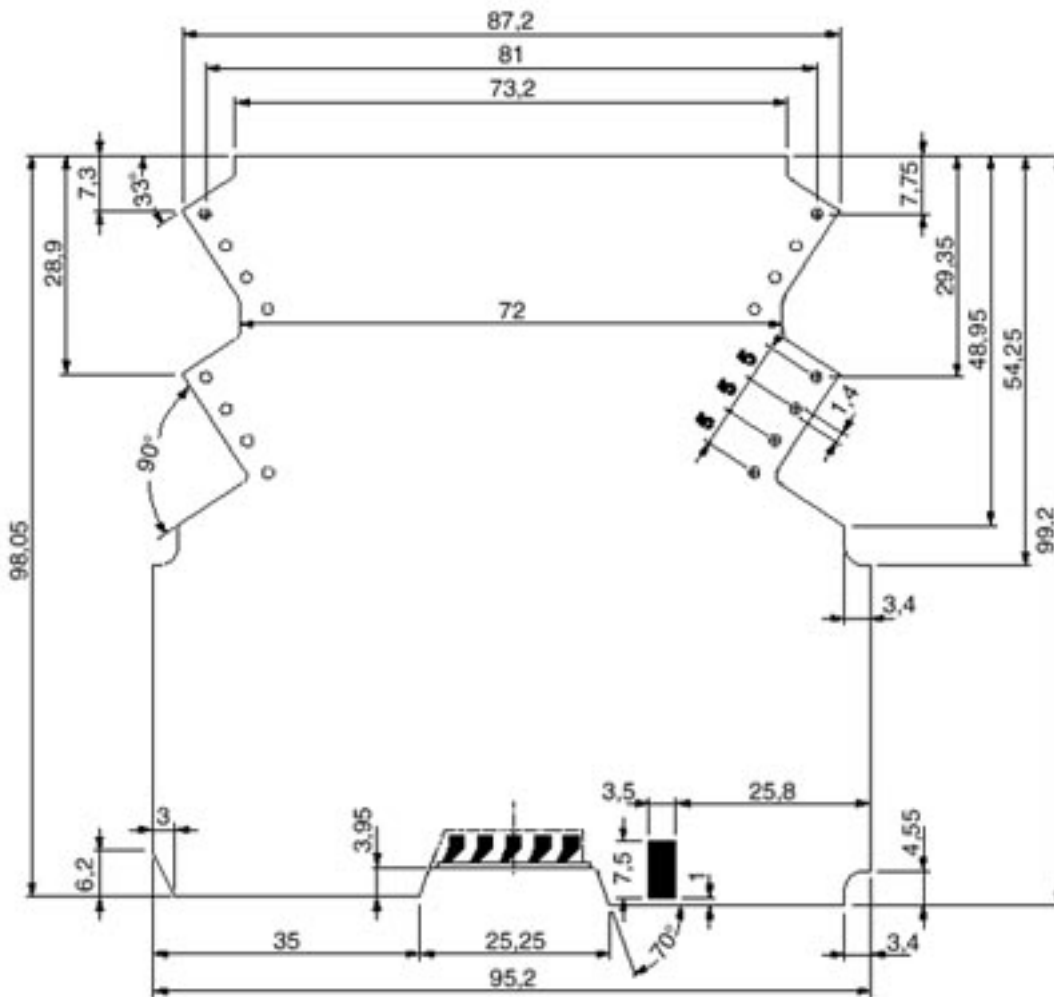

Dimensional drawing of the ME MAX 2-2 printed circuit board, for printed circuit terminal block connection (MKDSO), view: component side

Electronic housing - ME MAX 17,5 2-2 KMGY - 2713599

Dimensioned drawing

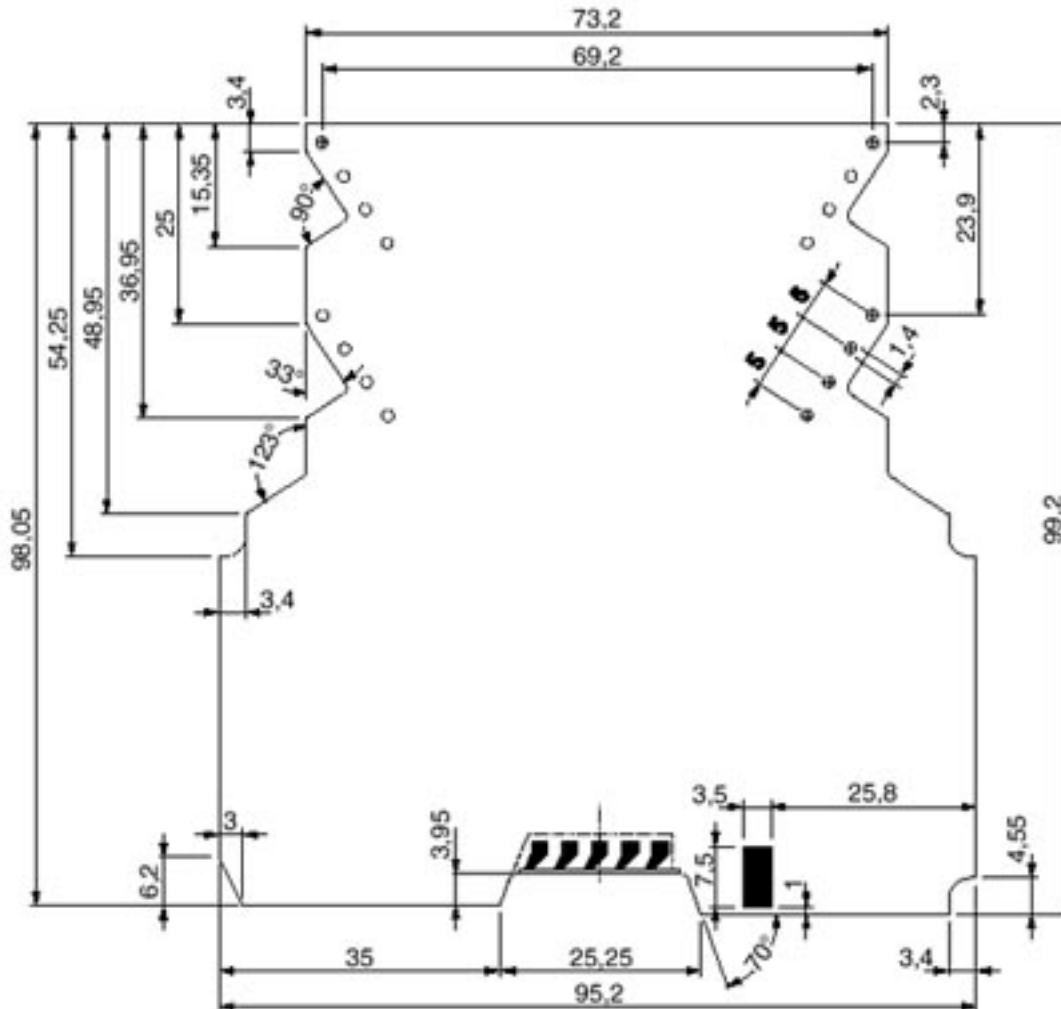

Dimensional drawing of the ME MAX 2-2 printed circuit board for plug connection (MSTBO), view: component side

© Phoenix Contact 2013 - all rights reserved
<http://www.phoenixcontact.com>