

## Self Adjusting Wire-End Ferrule Crimping Pliers Range 0.25...10 mm<sup>2</sup> (AWG 23-7) Item-No.: 24T060

This crimping tool is particularly suitable for hobbyists, craftsmen, field service, service workshops, electronics technicians and laboratory needs. The crimping tool is optimally matched to the field of application and has an automatic adjustment to the sleeve diameters between 0.25 and 10 sqmm. The square crimping claw ensures a safe crimping process, the ergonomic full-shell-handle fits well in the hand and allows comfortable working. The pliers have an adjustment option for fine adjustment of the compressive force and a quick locking safety lock.



### Technical Specifications

Four-mandrel press claw • Automatic adjustment • Fine adjustment ratchet pressure • Quick release safety lock • ergonomic handle • Range from 0.25 to 10 mm<sup>2</sup> (AWG 23 ... 7) • Weight: 404 g.

### Usage example

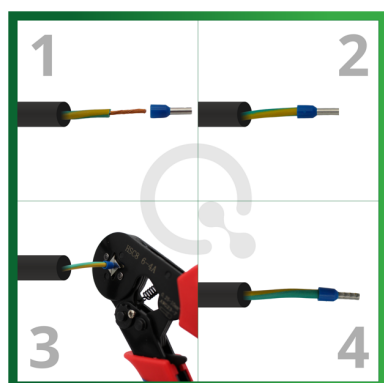

Application by qualified electricians only.

Works best with Quadrios' ferrule assortment sets.

