

HZB12-18EX Valve Regulated Lead Acid battery.
8 year design life for stand by power applications.
12 Volts 26 Ah

Innovative Features

- Completely maintenance free, sealed construction eliminates the need for watering
- Special formation process
- Analytical Grade electrolyte
- Spill proof / leak proof
- Valve regulated Max internal pressure 2.5 psi
- Multi-position usage
- ABS Case and cover - VO on request
- Low self discharge
- FAA and IATA approved as non-hazardous
- Built to comply with IEC 896-2, DIN 43534, BS 6290 Pt4, Eurobat.



Specifications

Nominal Voltage	12 Volts
Nominal Capacity	26Ah (C20 @ 20 °C)
Design Life	8 Years
Operating Temperature	-20 °C to 50 °C
Grid alloy	Calcium / Tin lead alloy
Plates	Flat Pasted
Separator	Absorbant Glass Mat
Active material	Very high purity lead
Case and cover	ABS (VO on request)
Charge Voltage	Float 2.25 - 2.30 VPC @25 °C Cycling See Haze cyclic charging profile Max ripple 0.05C (A)
Electrolyte	Sulphuric acid Analytical grade purity
Venting Valve	EPDM Rubber 1.5 to 2 psi (10.5 - 14 KPa) release pressure. Resealing at 1 psi (7 KPa)
Terminal	Insert 12mm Dia M5 thread. Epoxy sealed by extended mechanical paths
Torque setting	The recommended torque value for all types is 5-7 Nm
Cables	Connectors, cables, terminal covers on request.

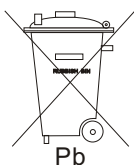

Haze Battery Company keenly encourages environmental awareness; PLEASE follow guidelines for the recycling /disposal of lead.

Website: www.hazebattery.com
E mail : sales@hazebattery.com

Sealed Lead Acid 12 Volt Bloc AGM Range
PRODUCT SHEET HZB12-18EX

12V
AGM

Specifications

Nominal Voltage		12V	
Nominal Capacity		26 Ah	
Dimensions	Total Height (Inc. terminals)	170 mm	6.69 inches
	Length	181 mm	7.13 inches
	Width	77 mm	3.03 inches
	Weight	6.85 Kg	15.14 lbs

Characteristics

Capacity 20-25 °C (68-77 °F) To 1.75 volts	20 hour rate	26.4 Ah
	10 hour rate	25.0 Ah
	5 hour rate	22.5 Ah
	1 hour rate	17.3 Ah
	15 min rate	12.4 Ah
	Internal Resistance	mOhms
	Impedance	S
Capacity correction for Temperature Variations (C20)	40 °C (104 °F)	102%
	20 °C (68 °F)	100%
	0 °C (32 °F)	85%
	-15 °C (5 °F)	65%
Self-Discharge 20 °C (68 °F)	Capacity after 1 months storage	98%
	Capacity after 3 months storage	94%
	Capacity after 6 months storage	86%
Short Circuit Current 20 °C (68 °F)		
Terminal	Standard	12mm Insert M5 thread Cu Flag
	Optional	
Charging (Constant Voltage)	Cyclic	2.35 - 2.40 VPC (20-25 °C)
	Float	2.27 - 2.30 VPC (15-25 °C)

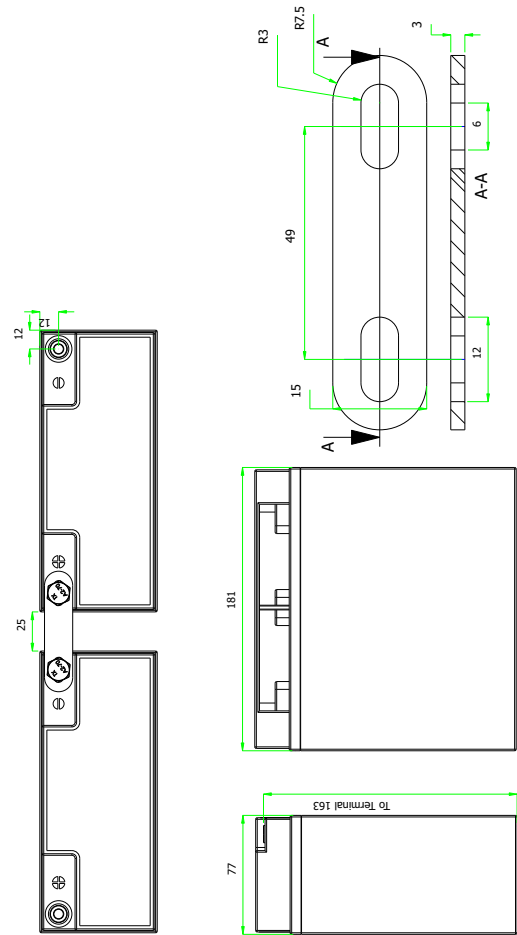

Constant Power Discharge - Watts per Cell @ 20-25 °C

End V per Cell	5M	10M	15M	20M	25M	30M	35M	40M	45M	60M	90M	2 hr	3 hr	4 hr	5 hr	6 hr	7 hr	8 hr	10 hr	12 hr	20 hr
1.85	201	115.4	84.2	68.7	58.6	51.1	45.4	41.0	37.8	30.2	21.7	17.0	11.98	9.47	7.91	6.77	5.92	5.26	4.27	3.58	2.18
1.80	215	123.3	89.9	73.4	62.6	54.6	48.5	43.8	40.3	32.2	23.2	18.1	12.80	10.12	8.45	7.23	6.33	5.62	4.56	3.83	2.33
1.75	229	131.1	95.7	78.1	66.6	58.1	51.6	46.6	42.9	34.3	24.7	19.3	13.6	10.76	8.99	7.69	6.73	5.98	4.85	4.07	2.48
1.70	234	134	97.8	79.8	68.0	59.3	52.8	47.6	43.8	35.0	25.2	19.7	13.9	11.00	9.19	7.86	6.88	6.11	4.95	4.16	2.53
1.67	236	135	98.6	80.5	68.6	59.9	53.2	48.0	44.2	35.4	25.4	19.9	14.0	11.10	-	-	-	-	-	-	-
1.65	237	136	99.0	80.8	68.9	60.1	53.4	48.2	44.4	35.5	25.5	19.9	14.1	11.14	-	-	-	-	-	-	-
1.60	239	137	100.0	81.6	69.5	60.7	54.0	48.7	44.8	35.8	25.8	20.1	14.2	11.25	-	-	-	-	-	-	-

Constant Amps Discharge - Amps @ 20-25 °C

End V per Cell	5M	10M	15M	20M	25M	30M	35M	40M	45M	60M	90M	2 hr	3 hr	4 hr	5 hr	6 hr	7 hr	8 hr	10 hr	12 hr	20 hr
1.85	99.2	58.7	43.6	35.0	29.6	25.9	23.2	21.0	19.2	15.2	11.00	8.61	6.13	4.77	3.96	3.39	2.97	2.66	2.20	1.86	1.16
1.80	106.0	62.8	46.6	37.4	31.6	27.7	24.8	22.4	20.5	16.3	11.75	9.19	6.55	5.09	4.23	3.62	3.17	2.84	2.35	1.98	1.24
1.75	112.8	66.8	49.6	39.8	33.7	29.5	26.3	23.9	21.8	17.3	12.50	9.78	6.97	5.42	4.50	3.85	3.37	3.02	2.50	2.11	1.32
1.70	115.3	68.2	50.7	40.7	34.4	30.1	26.9	24.4	22.3	17.7	12.77	9.99	7.12	5.54	4.59	3.94	3.44	3.08	2.56	2.16	1.35
1.67	116.3	68.8	51.1	41.0	34.7	30.4	27.2	24.6	22.5	17.8	12.89	10.08	7.18	5.59	-	-	-	-	-	-	-
1.65	116.7	69.1	51.3	41.2	34.8	30.5	27.3	24.7	22.6	17.9	12.94	10.12	7.21	5.61	-	-	-	-	-	-	-
1.60	117.9	69.8	51.8	41.6	35.2	30.8	27.5	24.9	22.8	18.1	13.06	10.22	7.28	5.66	-	-	-	-	-	-	-

Ampere Hour @ 20-25 °C

End V per Cell	2 hr	3 hr	4 hr	5 hr	6 hr	7 hr	8 hr	10 hr	12 hr	20 hr
1.85	17.2	18.4	19.1	19.8	20.3	20.8	21.2	22.0	22.3	23.2
1.80	18.4	19.6	20.4	21.1	21.7	22.2	22.7	23.5	23.8	24.8
1.75	19.6	20.9	21.7	22.5	23.1	23.6	24.1	25.0	25.3	26.4
1.70	20.0	21.4	22.2	23.0	23.6	24.1	24.7	25.6	25.9	27.0
1.67	20.2	21.5	22.4	-	-	-	-	-	-	-
1.65	20.2	21.6	22.4	-	-	-	-	-	-	-
1.60	20.4	21.8	22.7	-	-	-	-	-	-	-



110914