

		Conditions
cell type:	NiMH	
cell size:	AA	
nominal voltage:	1.2 V	
max. charge voltage:	1.5 V	at standard charge (0.1C / 20°C)
capacity		
nominal:	1300 mAh	discharge at 0.2C
minimum:	1300 mAh	discharge at 0.2C
	1200 mAh	discharge at 1C
		1.0V end discharge voltage
		ta: 20°C
max. continuous discharge current:	3900 mA	ta: 0...45°C
charge	current	time
standard charge:	130 mA	14....16hrs
quick charge:	390 mA	4hrs
fast charge:	1300 mA	1.1hrs
recommended charge termination control parameters:	0...5 mV 0.8...1 °C 45...50 °C	- ΔV (-deltaV) temperature rise per minute TCO (temperature cut off)
trickle charge current:	10...30 mA	(recommended)
continuous overcharge: (less than 1 year)	≤ 130 mA	no conspicuous deformation no leakage
internal resistance: (impedance)	≤ 45 mΩ	at 1KHz battery fully charged
life expectancy:	≥ 500 cycles	acc. IEC standard
self discharge		
charge retention:	≥ 80 %	after 12 months storage at 20°C
initial capacity:	≥ 900 mAh	within 30 days after delivery discharge at 0.2C
ambient temperature range:	0...45 °C 10...40 °C - 20...65 °C - 20...50 °C - 20...40 °C - 20...30 °C	standard charge fast charge discharge storage (≤3months) storage (≤6months) storage (≤24months)

QCT1: 20/1250/45
QCT2: 30/1150/50

mechanical specifications

cell dimensions

diameter d1:		14.3 - 0.7	mm
diameter d2:	max.	5.5	mm
height h1:		50.4 - 0.5	mm
height h2:	min.	1.2	mm
weight:		23 ± 2	g

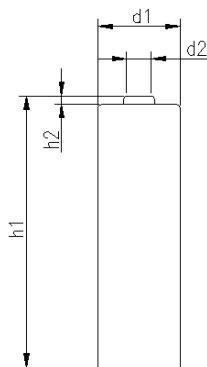

Diagrams

standard charge

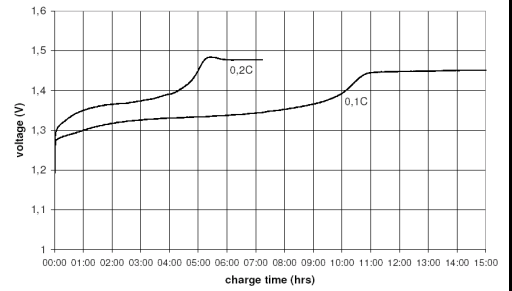

fast charge

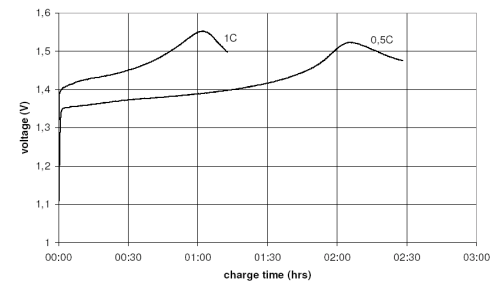

low rate discharge

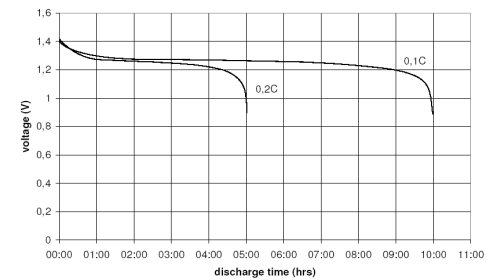

high rate discharge

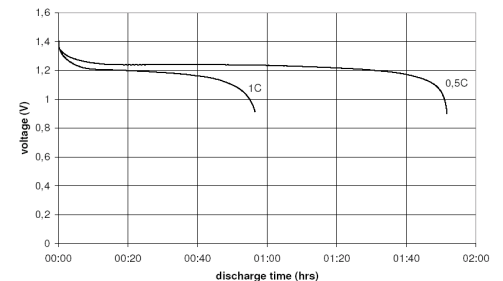

	ANSMANN Specifications for model:	NiMH Battery
		AA - 1300mAh low self discharge
	data sheet no. / part no.	5030792
	supplier no.	702069
	author / date	JF / 29.05.2024