

battery type: Lithium - Iron Disulfide
battery size: IEC: FR6; ANSI: AA; L91; Mignon
chemical system: Li-FeS₂

Conditions

nominal voltage: 1.5 V
open circuit voltage: 1.78...1.83 V new battery
 1.75...1.83 V after 1 year storage at 20°C

capacity rated: 3000 mAh all measurements at 20°C ambient discharge at 75ohms load; 24hours/day End Voltage (EV): 0.9V

minimum: 2850 mAh discharge at 35mA constant current End Voltage (EV): 0.8V
 2700 mAh discharge at 1000mA const. current End Voltage (EV): 0.8V

typical service output (new batteries)

≥ 960 cycles discharge at 1000mA; EV: 0.9V discharge 10s/m 1h/d
 ≥ 84 h load resistor: 43ohms; EV: 0.9V discharge 4h/d
 ≥ 170 min discharge at 1000mA; EV: 0.9V discharge 24h/d
 ≥ 20.3 h load resistor: 10ohms; EV: 0.9V discharge 24h/d
 ≥ 12.0 h discharge at 250mA; EV: 0.9V discharge 1h/d

internal resistance: ≤ 350 mΩ at 1kHz, sine wave measurement full battery

max. discharge current: 2000 mA continuous
 3000 mA pulse

shelf life: 10 years under proper storage conditions

leakage resistance over discharge: no leakage 10ohms continuous discharge for 48h; ta: 20°C; RH: 60±15%

high temperature: no leakage store 20days at ta: 60°C; RH:90±5%

ambient temperature range: - 40...60 °C

recommended storage conditions: -20....40 °C ambient temperature
 45...75 % rel. humidity

mechanical specifications

cell dimensions
 diameter d1: 14.3 - 0.4 mm
 diameter d2: 5.2 - 0.5 mm
 height h1: 50.4 - 0.4 mm
 height h2: 1.7 - 0.5 mm
 weight: 15 ± 2 g

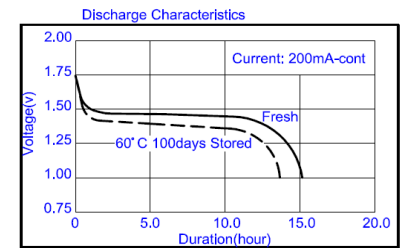
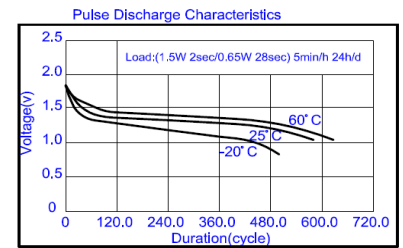
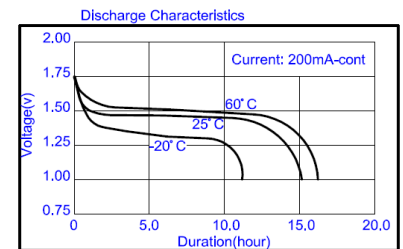
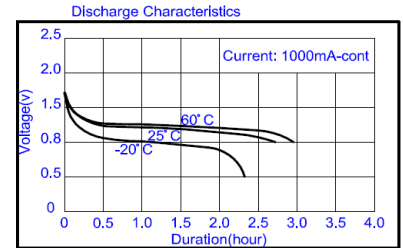
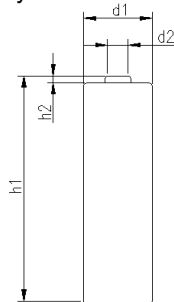

	ANSMANN Specifications for model:	Ansmann Extreme Lithium Battery AA - size
	data sheet no. / part no.	1512-0002
	s.n.	703331
	author / date	TG / 29.05.2024