

Order code	Manufacturer code	Description
22-5100	n/a	2 WAY STRAIGHT SINGLE ROW SOCKET (RC)
22-5102	n/a	3 WAY STRAIGHT SINGLE ROW SOCKET (RC)
22-5104	n/a	4 WAY STRAIGHT SINGLE ROW SOCKET (RC)
22-5106	n/a	5 WAY STRAIGHT SINGLE ROW SOCKET (RC)
22-5108	n/a	10 WAY STRAIGHT SINGLE ROW SOCKET (RC)
22-5110	n/a	15 WAY STRAIGHT SINGLE ROW SOCKET (RC)
22-5112	n/a	20 WAY STRAIGHT SINGLE ROW SOCKET (RC)
22-5114	n/a	25 WAY STRAIGHT SINGLE ROW SOCKET (RC)

	Page 1 of 2
The enclosed information is believed to be correct, Information may change without notice due to product improvement. Users should ensure that the product is suitable for their use. E. & O. E.	Revision A 20/02/2007

2044 Series

P.C.B. Socket 2.54mm(0.100")

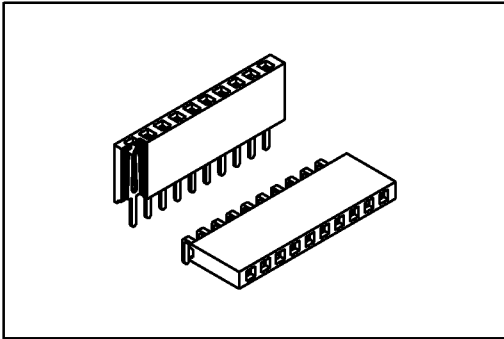

Material:

Housing: 30% Glass filled PBT UL94V-0.

Contacts: Phosphor Bronze.

Plating: Gold plated over nickel.

Tin plated over nickel.

Electrical Characteristics:

Current Rating: 1 AMP.

Insulator Resistance: 5000MΩmin. at DC 500V.

Contact Resistance: 20mΩmax. at DC 100mA.

Operating Temperature: -55°C~+105°C.

Features:

- * Available in both Straight and Right Angle.
- * High profile 8.50mm (0.335").
- * Mates with 0.64mm (0.025") square pin.
- * Turning fork contacts offer lower cost for competitive market.

Mates with: 2011,2012,2015.

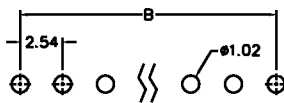
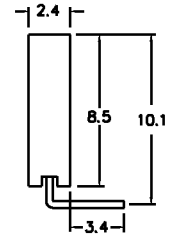
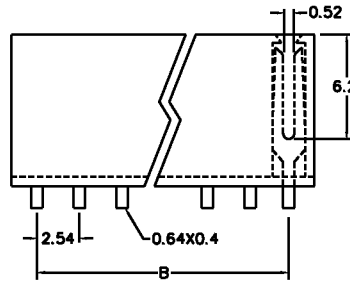
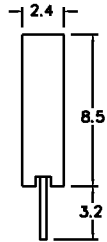
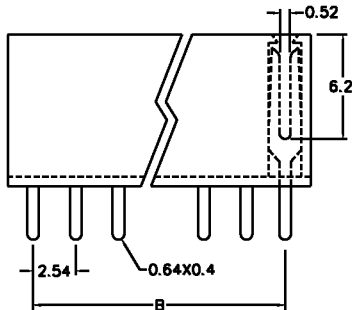
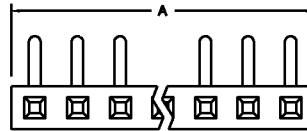
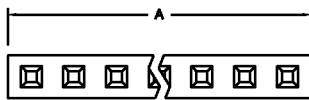

P.C. Board Layout

Position	2 Thru 40
Dimension	
A	2.54 X No. of Positions +0.5
B	2.54 X No. of Positions -2.54

Ordering information

2044- 1 X 40 G 00 S A
 Series Single Row No. of Pin Per Row G: Gold Plated T: Tin Plated 00: G/F 10: 10μ" 15: 15μ" 30: 30μ" S: Straight R: Right Angle A: Tray Package B: Bulk Package