

IEC connectors

Order code	Manufacturer code	Description
23-2100	n/a	FUSED IEC CHASSIS PLUG 6.3MM FAST-ON RC
23-0360	n/a	FUSED IEC CHASSIS PLUG (RC)

IEC connectors	Page 1 of 2
The enclosed information is believed to be correct, Information may change 'without notice' due to product improvement. Users should ensure that the product is suitable for their use. E. & O. E.	Revision A 04/07/2003

Connectors – Mains/Power

Fused Chassis Plug

Dimensions:

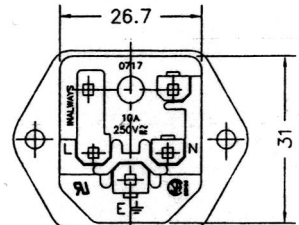
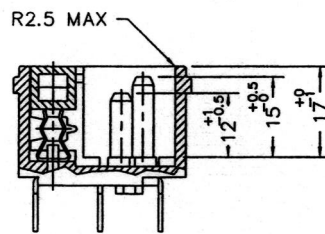
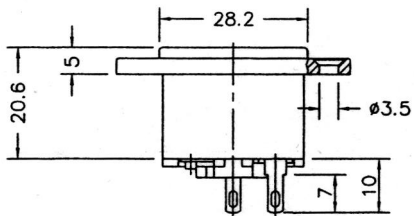
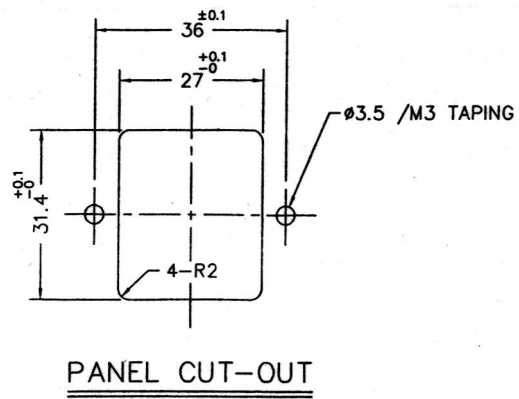
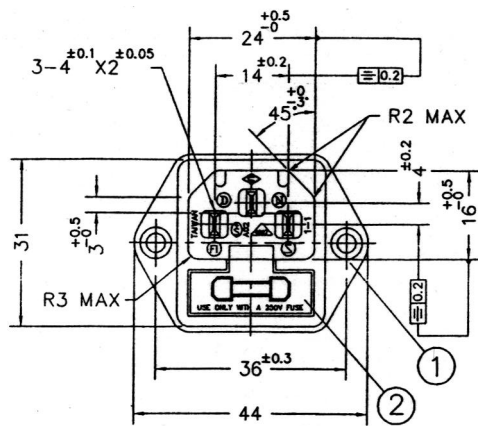

Specification:

Housing:	PA66 (UL94V-2 STD)
Terminals:	Copper alloy
Rating:	10A 250Vac
Approvals:	UL, CSA, VDE, SEV, SEMKO, DEMKO, NEMKO, FIMKO