



Data Sheet - TRU Components

BN: 3192605/ 3192606/ 3192607/ 3192608/ 3192609/ 3192610/ 3192611/ 3192612

last updated: 2 Aug 2024

RJ45 waterproof connector application type

Applications

Products are used in a certain equipment information control box

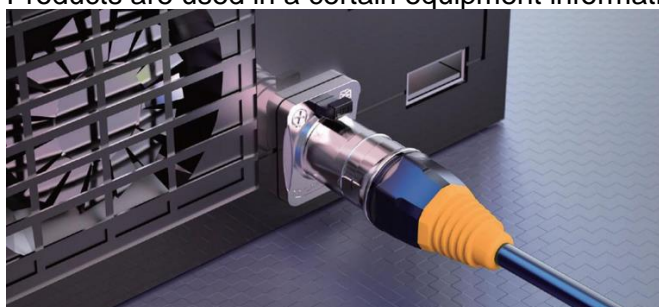

Features Overview



Waterproof/ dustproof performance



Super anti-shielding ability



Multiple style options



Panel mount



Data Sheet - TRU Components

BN: 3192605/ 3192606/ 3192607/ 3192608/ 3192609/ 3192610/ 3192611/ 3192612

last updated: 2 Aug 2024

Technical Table

BN	Product description
----	---------------------

3192605	IP65 RJ45 male metal circular plug connector
---------	--



3192606	IP65 RJ45 male metal circular plug connector, yellow
---------	--

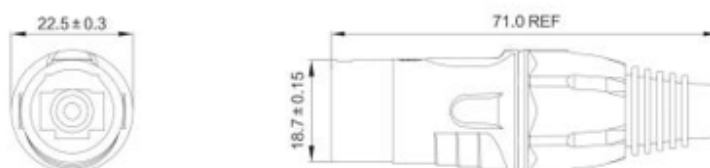

3192607	IP65 RJ45 female to standard RJ45 female straight metal square receptacle socket connector
---------	--

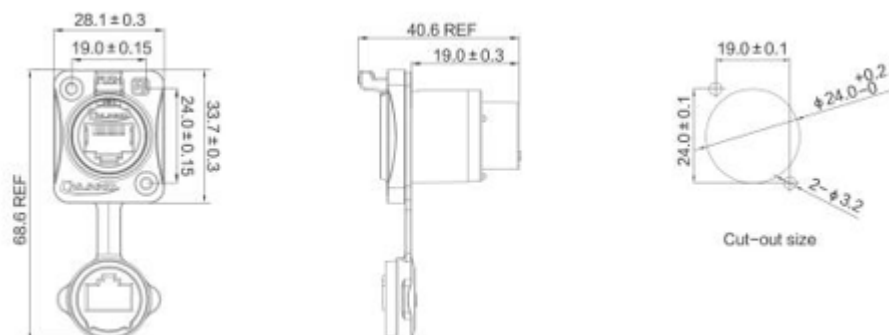

Data Sheet - TRU Components

BN: 3192605/ 3192606/ 3192607/ 3192608/ 3192609/ 3192610/ 3192611/ 3192612

last updated: 2 Aug 2024

3192608 IP65 RJ45 female to standard RJ45 female angle metal square receptacle socket connector

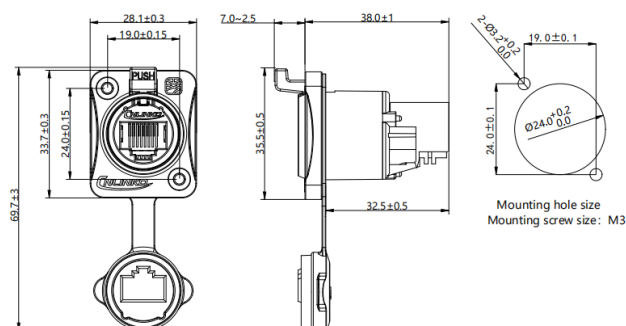

Cable O.D. range:	Ø5.5 ~ Ø7.0 mm
Wire size:	26 – 24 AWG
Temperature Range:	-10°C to +70°C
Rated Voltage:	60V DC
Rated Current:	1.5A
Product Material:	Zinc alloy
Withstand Voltage:	100V/min
Insulation Resistance:	>500MΩ
Endurance Test:	>500 times
Shell Material:	Engineering plastic
Contact Material:	Male/ Female pin (Copper alloy)
Transmission Level:	USB2.0, USB 3.0
Protection Level:	IP44/ IP65 (In connected state)
Assembly Method:	¼ quick bayonet connection/ plug-in connection/ push-pull connection



Data Sheet - TRU Components

BN: 3192605/ 3192606/ 3192607/ 3192608/ 3192609/ 3192610/ 3192611/ 3192612

last updated: 2 Aug 2024

BN	Product description
----	---------------------

3192609 IP65 RJ45 female plastic circular plug connector

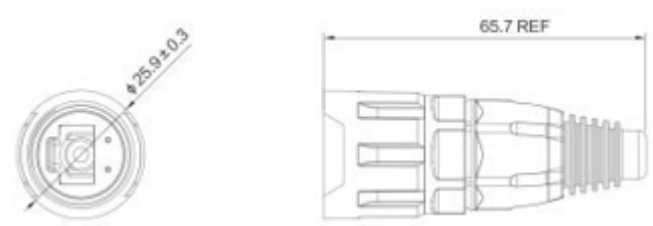

3192610 IP65 RJ45 female to standard RJ45 female plastic socket connector with cover

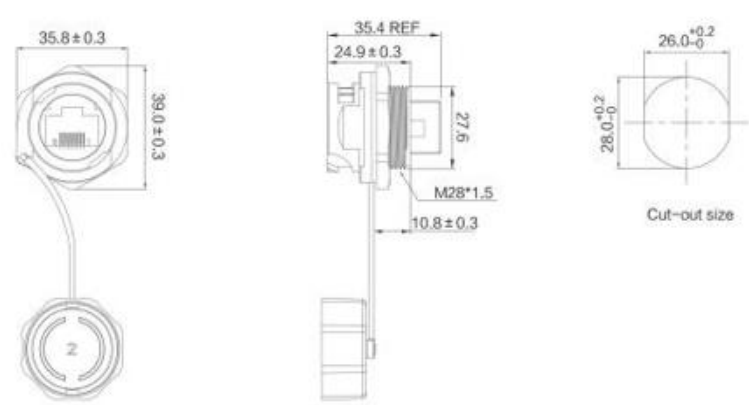

Data Sheet - TRU Components

BN: 3192605/ 3192606/ 3192607/ 3192608/ 3192609/ 3192610/ 3192611/ 3192612

last updated: 2 Aug 2024

3192611 IP65 RJ45 female to standard RJ45 female plastic socket connector with cover

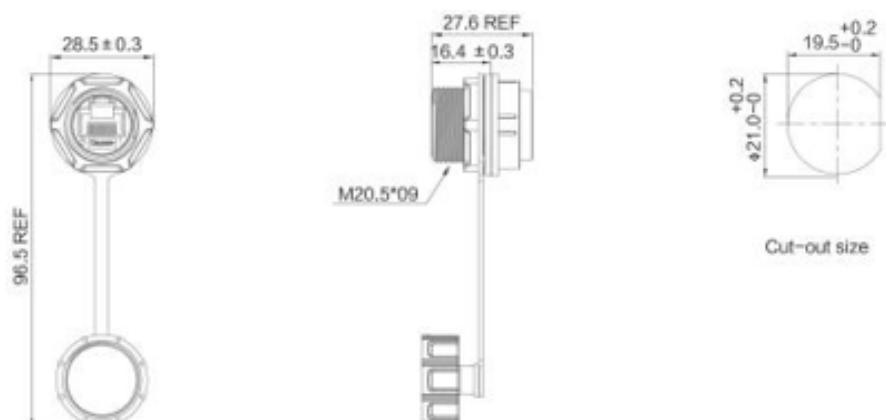

3192612 IP65 RJ45 male plastic plug connector

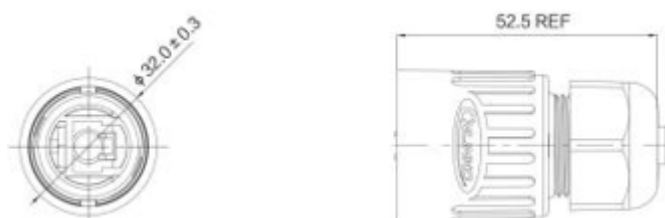

Cable O.D. range:	Ø5.5 ~ Ø7.0 mm
Wire size:	26 – 24 AWG
Temperature Range:	-10°C to +70°C
Rated Voltage:	60V DC
Rated Current:	1.5A
Product Material:	PBT
Insulation Resistance:	>500MΩ
Endurance Test:	>500 times
Shell Material:	Engineering plastic
Contact Material:	Male/ Female pin (Copper alloy)