

## Hand-Held and Remote

Order code	Manufacturer code	Description
30-1215	n/a	115X65X40 SEALED ENCLOSURE (RC)
30-1220	n/a	115X65X55 SEALED ENCLOSURE (RC)
30-1225	n/a	115X90X55 SEALED ENCLOSURE (RC)
30-1230	n/a	171X121X55 SEALED ENCLOSURE (RC)

Hand-Held and Remote	Page 1 of 2
The enclosed information is believed to be correct, Information may change without notice due to product improvement. Users should ensure that the product is suitable for their use. E. & O. E.	Revision A 20/02/2007

## IP65 Sealed ABS Enclosures

### Material Specifications

Polylac

ABS Resin Characteristics

Typical Properties	ASTM Test	Units	(General) PA-747
Tensile Strength	D-638	Kg/cm <sup>2</sup> (lb/in <sup>2</sup> )	410 (5810)
Tensile Elongation	D-638	%	30
Flexural Modulus	D-790	10 <sup>4</sup> kg/cm <sup>2</sup> (10 <sup>5</sup> lb/in <sup>2</sup> )	2.0 (2.8)
Flexural Strength	D-790	kg/cm <sup>2</sup> (lb/in <sup>2</sup> )	560 (7940)
Rockwell-Hardness	D-785		R-98
IZOD Impact Strength	D-256	1/8" kg-cm/cm (ft-lb./in)	38 (7.0)
IZOD (Notched)		1/4" kg-cm/cm (ft-lb./in)	32 (6.0)
Vicat Softening Temperature	D-1525	°C (°F)	102 (216)
H.D.T. (annealed) (85°C / 8hrs)	D-648	°C (°F)	94 (201)
(unannealed)			83 (181)
Specific Gravity	D-792	23/23°C	1.03
Melt Flow Index	D-1238	g/10min. (cond.G)	0.8
		g/10min. (cond.I)	3.0
Flammability	File No. E56070 UL-94		1/16" HB
	File No. LS66844 C22.2 No. 0.6 (C.S.A.)		
Product Description			High Impact

All tests were run under laboratory condition

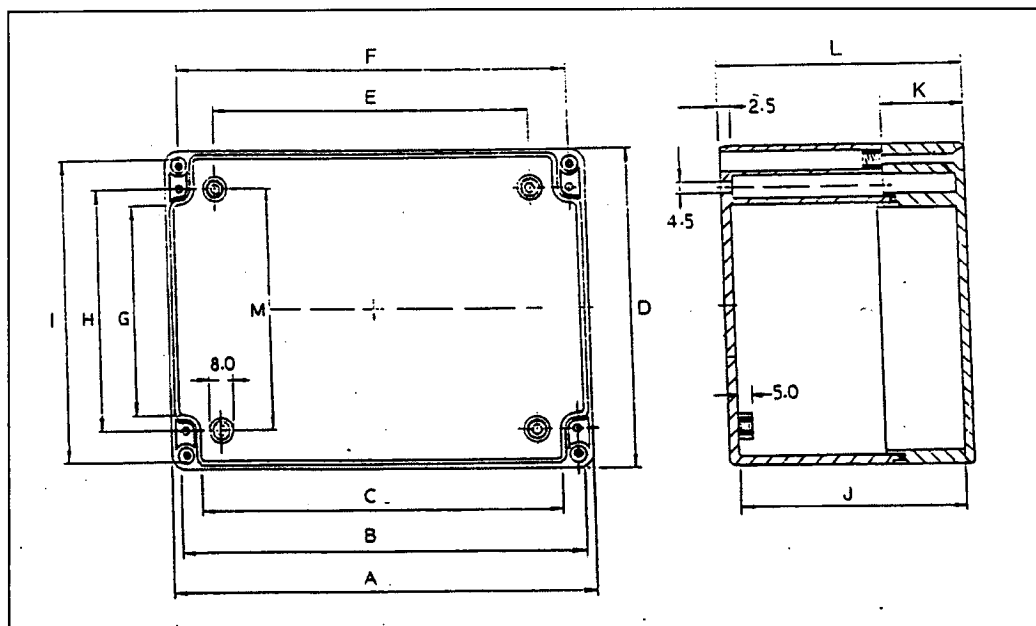

A	B	C	D	E	F	G	H	I	J	K	L	M
115.0	108.0	81.0	65.0	95.0	103.0	40.0	53.0	58.0	35.0	15.0	40.0	28.0
115.0	108.0	81.0	65.0	95.0	103.0	40.0	53.0	58.0	50.0	15.0	55.0	28.0
115.0	108.0	81.0	90.0	77.0	103.0	46.0	60.0	83.0	50.0	15.0	55.0	68.0
171.0	164.0	145.0	121.0	133.0	159.0	77.5	91.0	114.0	50.0	15.0	55.0	99.0