

## Pan Head Recess T Drive Machine Screw – Packs of 100



### DESCRIPTION

Pan Head Recess T-Drive (also known as Torx<sup>®</sup>) Machine Screws with zinc-plated, passivated finish.

### DISTINCTIVE FEATURES

- Torx<sup>®</sup> Drive
- Steel Grade 4.8
- M3, M4 M5 option
- Zinc & Clear Cr3 Finish
- Dome head style
- Supplied in packs of 100

### APPLICATIONS

The star-shaped head of these T Drive screws makes them more secure than regular slotted or Poxidriv screws and allows higher torque transmission, so that screws and bolts can be tightened more securely. Suitable for many applications, T drive or Torx<sup>®</sup> screws are typically used in consumer electronics, hard disk drives, computer systems, vehicles and bicycles, etc.

**Pan  
Head**

**Grade  
4.8  
Steel**

**Zinc  
& Clear  
Cr3**





## GENERAL SPECIFICATION

Series	Machine Screws
Type	Recess T Drive



## MATERIALS

Material	Grade 4.8 Steel
Finish	Zinc & Clear Cr3



## CERTIFICATION AND STANDARDS

Material Specification	~DIN 7985T ~ISO 14583
------------------------	-----------------------



## OPTIONS (MOQ may apply)

Lengths	Various
Thread Sizes	M1.6 to M12
Thread Type	Coarse and Fine
Material	Stainless Steel
Head Styles	e.g. Button, Countersunk, Cheese

## DIMENSIONS/DRAWINGS

Units mm - unless stated otherwise

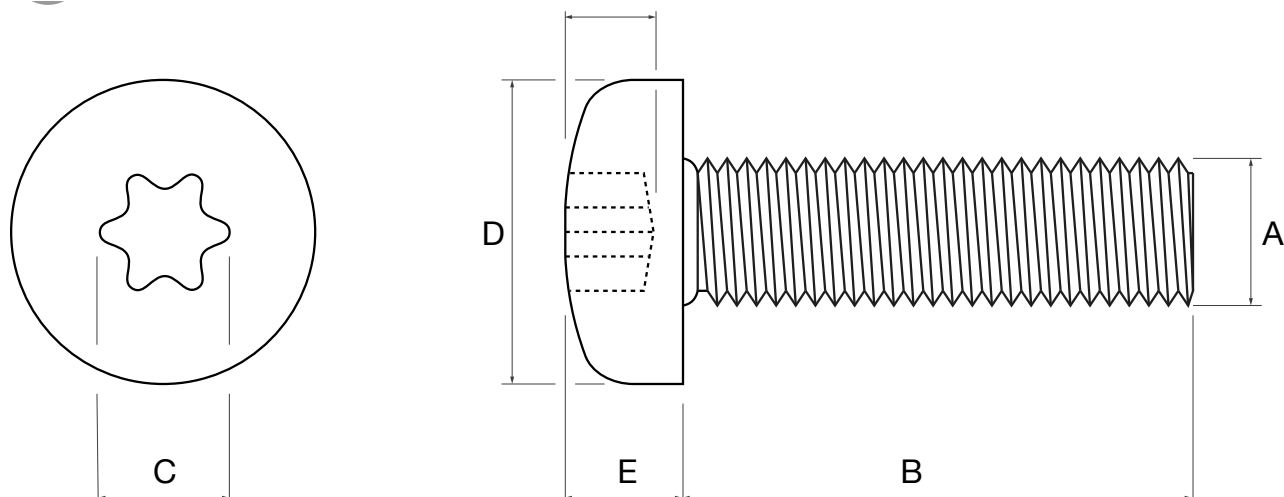

## PART NUMBER TABLE

Part number	A Thread size	B Length	C Screwdriver size	D Head width	E Head depth	F Screwdriver depth	UNSPSC	EAN	Country of Origin
<b>33-7054</b>	M3	6	T10 - 2.8	6.0	2.4	1.27 max.	73181900	5053556009671	United Kingdom
<b>33-7055</b>		10					73181900	5053556009688	United Kingdom
<b>33-7212</b>		20					73181900	5053556011254	China
<b>33-7213</b>	M4	6	3.95	12	3.1	1.66	73181900	5053556011261	China
<b>33-7214</b>		12					73181900	5053556011278	China
<b>33-7215</b>		20					73181900	5053556011285	China
<b>33-7216</b>	M5	12	4.5	12	3.8	1.91	73181900	5053556011292	China
<b>33-7217</b>		20					73181900	5053556011308	China

For further information on pricing, delivery, and long-term stock agreements please get in touch with your local business development contact, telephone our main office on **01206 838000** or email **Sales@Rapidonline.com**.



**Important Notice:** This data sheet and its contents (the "Information") belong to Rapid Electronics Limited or are licensed to it. No licence is granted for the use of it other than for information purposes in connection with the products to which it relates. No licence of any intellectual property rights is granted. The Information is subject to change without notice and replaces all data sheets previously supplied. The Information supplied is believed to be accurate but Rapid Electronics Limited assumes no responsibility for its accuracy or completeness, any error in or omission from it or for any use made of it. Users of this data sheet should check for themselves the Information and the suitability of the products for their purpose and not make any assumptions based on information included or omitted. Liability for loss or damage resulting from any reliance on the Information or use of it (including liability resulting from negligence or where Rapid Electronics Limited were aware of the possibility of such loss or damage arising) is excluded. This will not operate to limit or restrict Rapid Electronics Limited's liability for death or personal injury resulting from its negligence.