

KM50-1G

TO-218, TO-220, TO-220-single gauge (0.020")



Extruded heat sink with cut length of 50 (1.969)

Height: 44.96
 Mount Orientation: Vertical
 Finish: Black Anodize
 RoHS: Compliant
 Thermal Resistance: 4.80

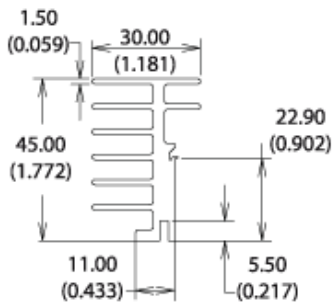

For TO-220 use CLIP 4426 or CLIP 4525
 CLIPS SOLD SEPARATELY

RoHS
 Compliance
 PENDING

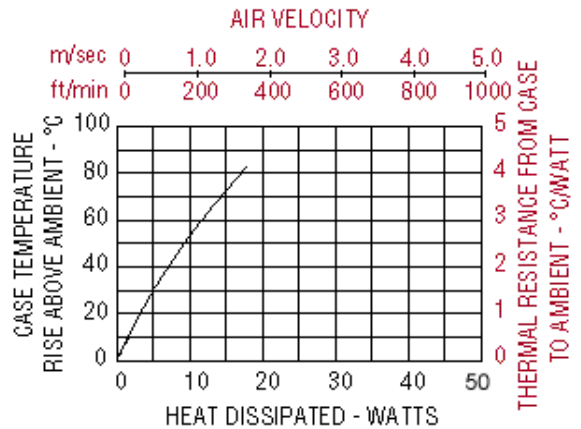

CLIP 4426

CLIP 4525

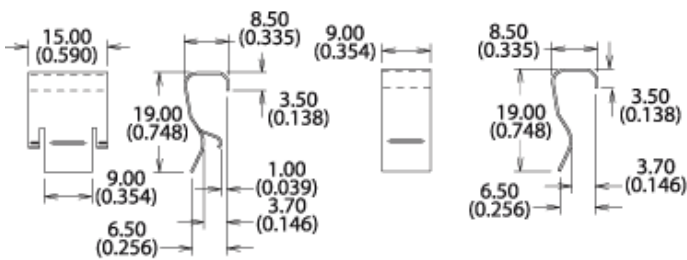

For TO-218 use CLIP 4473 or CLIP 4597
 CLIPS SOLD SEPARATELY

RoHS
 Compliance
 PENDING

CLIP 4473

CLIP 4597

