

NEW
DE Screw Terminal Type,
 High Energy Density Type



- ▶ High Energy Density
- ▶ Suitable for electric power storage
- ▶ Charge and discharge efficiency are higher than in batteries

Item	Characteristics	
Operating temperature range	-25 ~ +60°C	
Rated Working Voltage	2.5VDC	
Capacitance tolerance	-20 ~ +20% at 20°C	
Low temperature characteristics	Capacitance change	Within ±30% of initial value at +20°C (-25 to +60°C)
	Internal resistance	Less than 400% of initial at +20°C
Endurance (60°C)	Test time	1000 hours
	Capacitance change	Within ±30% of initial value
	Internal resistance	Less than 300% of initial at specified value
Shelf life (60°C)	After 1000 hours no load test same as endurance	

● **DRAWING**

Unit : mm

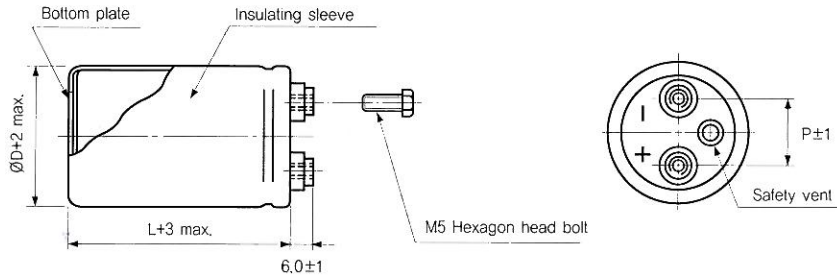

● **TWO LEGS ANGLE**

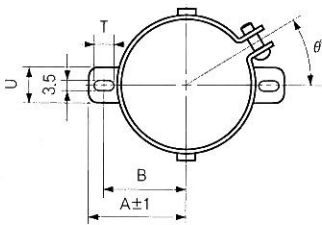

● **THREE LEGS ANGLE**

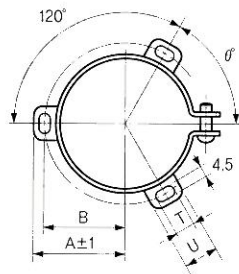

● **TWO LEGS ANGLE SIZE TABLE**

ØD	B	A	T	U	θ°	P
35	24	29	7	10	30	12.7
51	33.6	39.9	6	14	30	22
63.5	40.8	46.8	6	14	30	28.6

● **THREE LEGS ANGLE SIZE TABLE**

ØD	B	A	T	U	θ°	P
51	32.9	38.9	7	12	60	22
63.5	38.4	45.3	7	14	60	28.6
76.2	44.5	51.5	8	16	60	31.8

● **CHARACTERISTIC LIST & DIMENSIONS**

Rate Working Voltage	Capacitance (F)	Internal resistance (mΩ) at 1kHz	Leakage Current (mA Max.) after 30 minutes	Size Ø D × L (mm)
2.5	700	18	350	35×100
	1400	10	700	51×100
	2700	8	1350	63.5×100
	3000	5	1500	63.5×120
	5000	3	2500	76.2×120