

833HM

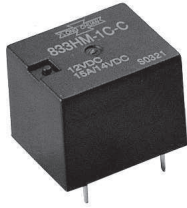

»» Features

- Sugar cube automotive relay.
- General purpose applications for automotive & car alarm system.
- Optional for flux-free or sealed washable type.
- Comply with RoHS-Directive 2002/95/EC, and ELV-Directive 2000/53/EC

»» Type List

Terminal style	Contact form	Designation	
		Flux tight	Sealed type washable
PCB terminal	1C (SPDT)	833HM-1C-C	833HM-1C-S
	1A (SPNO)	833HM-1A-C	833HM-1A-S
	1B (SPNC)	833HM-1B-C	833HM-1B-S

»» Ordering Information

833 H M - 1C - C
 1 2 3 4 5

- | | | | |
|--------|-----------------------------|-------|-------------------------------|
| 1. 833 | -- Basic series designation | 4. 1A | -- Single pole normally open |
| 2. H | -- High power type | 1B | -- Single pole normally close |
| 3. M | -- Automotive relay | 1C | -- Single pole double throw |
| | | 5. C | -- Flux tight |
| | | S | -- Sealed type washable |

»» Contact Rating

Resistive load	15A 14VDC
----------------	-----------

»» Coil Rating (DC)

Rated voltage (V)	Rated current $\pm 10\%$ at 23°C (mA)	Coil resistance $\pm 10\%$ at 23°C (Ω)	Max. continuous voltage at 85°C ⁽¹⁾	Pick up voltage(Max) at 23°C	Drop out voltage(Min) at 23°C	Power consumption at rated voltage
9	50.0	180	120 % of rated voltage	75 % of rated voltage	10 % of rated voltage	approx. : 0.45W
12	37.5	320				
24	18.8	1,280				

Note: (1) Continuous contact current at 10A.



833HM

»» Specification

Contact material	AgSnO alloy	
Contact voltage drop ⁽¹⁾	Typ. 100mV at 10A	
Operate time ⁽¹⁾	10ms Max.	
Release time ⁽¹⁾	5ms Max.	
Insulation resistance ⁽¹⁾	100MΩ Min. (DC 500V)	
Dielectric strength ⁽¹⁾	Between open contact: AC 500V , 50/60Hz 1 minute.	
	Between contact and coil: AC 500V , 50/60Hz 1 minute.	
Vibration resistance	Operating extreme	10~50Hz , amplitude 1.5mm
	Damage limits	10~50Hz , amplitude 1.5mm
Shock resistance	Operating extremes	10G
	Damage limits	100G
Life expectancy	Mechanical	10,000,000 operations (frequency 18,000 operations/hr)
	Electrical	30,000 operations (frequency 1,200 operations/hr)
Operating ambient temperature	-40 ~ +85°C (no freezing)	
Weight	approx. 10g	

Note : (1) Initial value

»» Outline Dimensions

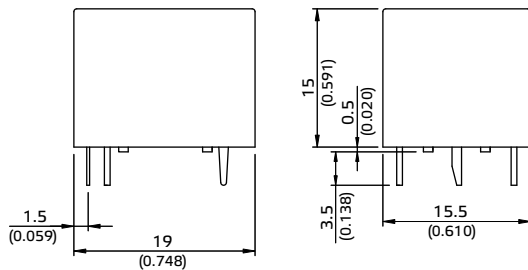

»» Wiring Diagram

BOTTOM VIEW

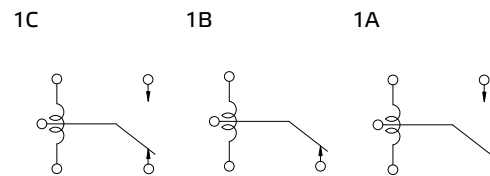

»» PC Board Layout

BOTTOM VIEW

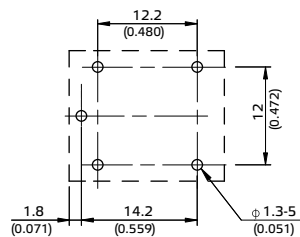

833HM



»» Engineering Data

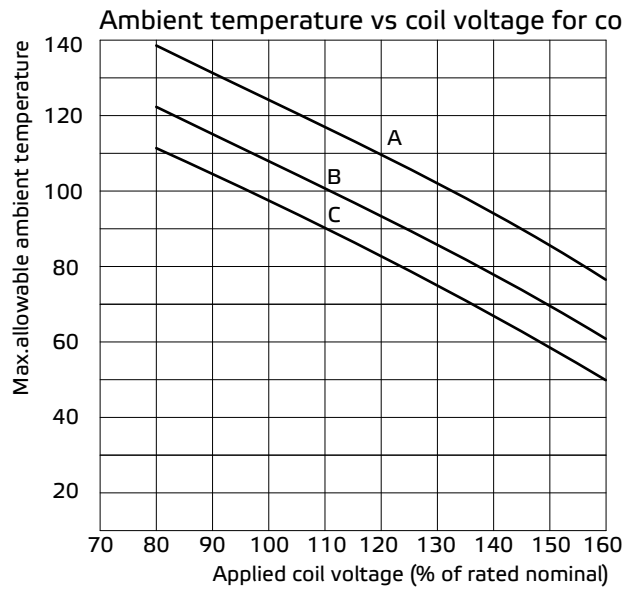
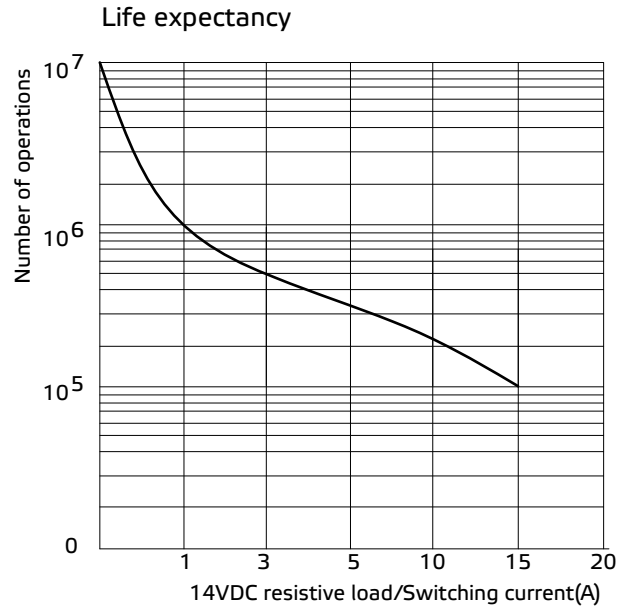
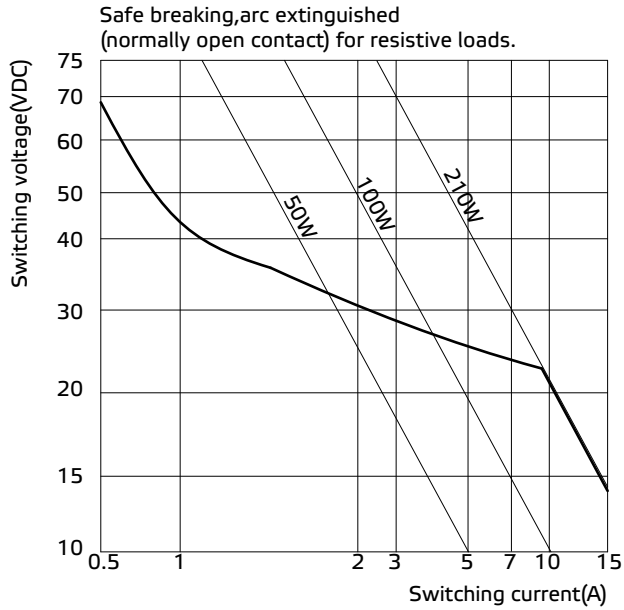

A:5A B:10A C:15A Contact load(resistive)
Maximum mean coil temperature=155°C

