

# ESKA Fuses

## Product Dimensions(mm)

| Part Number | A    | B    | C    | D    |
|-------------|------|------|------|------|
|             | Max. | Max. | Max. | Max. |
| LP-SM030    | 7.98 | 3.18 | 5.44 | 0.70 |
| LP-SM050/60 | 7.98 | 3.18 | 5.44 | 0.70 |
| LP-SM050/30 | 7.98 | 3.18 | 5.44 | 0.70 |
| LP-SM075    | 7.98 | 3.18 | 5.44 | 0.70 |
| LP-SM110/33 | 7.98 | 3.00 | 5.44 | 0.70 |
| LP-SM110/24 | 7.98 | 3.00 | 5.44 | 0.70 |
| LP-SM110/15 | 7.98 | 3.00 | 5.44 | 0.70 |
| LP-SM125    | 7.98 | 3.00 | 5.00 | 0.70 |
| LP-SM130/33 | 9.50 | 3.00 | 6.71 | 0.70 |
| LP-SM130/15 | 9.50 | 3.00 | 6.71 | 0.70 |
| LP-SM150/33 | 9.50 | 3.00 | 6.71 | 0.70 |
| LP-SM150/15 | 9.50 | 3.00 | 6.71 | 0.70 |
| LP-SM185    | 9.50 | 3.00 | 6.71 | 0.70 |
| LP-SM200    | 9.50 | 3.00 | 6.71 | 0.70 |
| LP-SM250    | 9.50 | 3.00 | 6.71 | 0.70 |
| LP-SM260    | 7.98 | 3.18 | 5.44 | 0.70 |
| LP-SM300    | 7.98 | 3.18 | 5.44 | 0.70 |

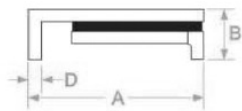

Side View

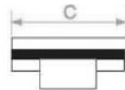

End View

## Part Marking System



## Electrical Characteristics

| Part Number | $I_H$ | $I_T$ | $V_{max}$ | $I_{max}$ | $T_{trip}$ |         | $Pd_{typ}$ | $R_{min}$    | $R_{max}$    | $R_{1max}$   |
|-------------|-------|-------|-----------|-----------|------------|---------|------------|--------------|--------------|--------------|
|             | (A)   | (A)   | (V)       | (A)       | Current(A) | Time(S) | (W)        | ( $\Omega$ ) | ( $\Omega$ ) | ( $\Omega$ ) |
| LP-SM030    | 0.30  | 0.60  | 60        | 10        | 1.5        | 4.0     | 1.9        | 0.700        | 1.300        | 4.800        |
| LP-SM050/60 | 0.50  | 1.00  | 60        | 10        | 2.5        | 4.0     | 1.9        | 0.350        | 0.600        | 1.400        |
| LP-SM050/30 | 0.50  | 1.00  | 30        | 10        | 2.5        | 4.0     | 1.9        | 0.350        | 0.600        | 1.400        |
| LP-SM075    | 0.75  | 1.50  | 30        | 40        | 8.0        | 3.0     | 1.9        | 0.290        | 0.400        | 1.000        |
| LP-SM110/33 | 1.10  | 2.20  | 33        | 40        | 8.0        | 2.0     | 1.9        | 0.100        | 0.190        | 0.480        |
| LP-SM110/24 | 1.10  | 2.20  | 24        | 40        | 8.0        | 2.0     | 1.9        | 0.100        | 0.190        | 0.480        |
| LP-SM110/15 | 1.10  | 2.20  | 15        | 40        | 8.0        | 2.0     | 1.9        | 0.100        | 0.190        | 0.480        |
| LP-SM125    | 1.25  | 2.50  | 15        | 40        | 8.0        | 2.0     | 1.6        | 0.070        | 0.120        | 0.250        |
| LP-SM130/33 | 1.30  | 2.60  | 33        | 40        | 8.0        | 4.0     | 2.1        | 0.080        | 0.130        | 0.280        |
| LP-SM130/15 | 1.30  | 2.60  | 15        | 40        | 8.0        | 4.0     | 2.1        | 0.080        | 0.130        | 0.280        |
| LP-SM150/33 | 1.50  | 3.00  | 33        | 40        | 8.0        | 5.0     | 2.1        | 0.060        | 0.110        | 0.250        |
| LP-SM150/15 | 1.50  | 3.00  | 15        | 40        | 8.0        | 5.0     | 2.1        | 0.060        | 0.110        | 0.250        |
| LP-SM185    | 1.85  | 3.70  | 15        | 40        | 8.0        | 5.0     | 2.1        | 0.045        | 0.080        | 0.165        |
| LP-SM200    | 2.00  | 4.00  | 15        | 40        | 8.0        | 12.0    | 2.1        | 0.045        | 0.065        | 0.125        |
| LP-SM250    | 2.50  | 5.00  | 15        | 40        | 8.0        | 25.0    | 1.9        | 0.025        | 0.052        | 0.085        |
| LP-SM260    | 2.60  | 5.20  | 6         | 40        | 8.0        | 20.0    | 1.9        | 0.025        | 0.052        | 0.075        |
| LP-SM300    | 3.00  | 6.00  | 6         | 40        | 8.0        | 35.0    | 1.9        | 0.015        | 0.033        | 0.048        |