

Descriptions:

- Green light source, fast response
- Long life, easy installation
- Colour temperature 6500K
- LED model number: OSXXZ3E1E1E, 140deg

Features:

- High lumen output
- Big emitting angle
- Superior ESD protection
- Superior UV resistance

Applications

- Small Space Lighting
- Mechanical Equipment Lights

Absolute maximum rating (Ta=25°C)

Item	Symbol	Value	Unit
Operating supply range	V _{dc}	11.4	V
Input Current (DC)	I _i	600	mA
Power dissipation	P _A	6.8	W
Operating temperature	T _{ope}	-10~+40	°C
Storage temperature	T _{stg}	-20~+80	°C

Electrical - Optical characteristics (Ta=25°C)

Item	Symbol	Min.	Typ.	Max.	Unit
LED module power	P _m	—	4.8	6.8	W
Input voltage (DC)	V _i	—	10	11.4	V
Product input current	I _f	—	480	600	mA
Beam pattern	BP	—	120	—	Deg
PCB diameter	L _{mod.}	—	28	—	mm
Net weight	Wei.	---	6	---	g

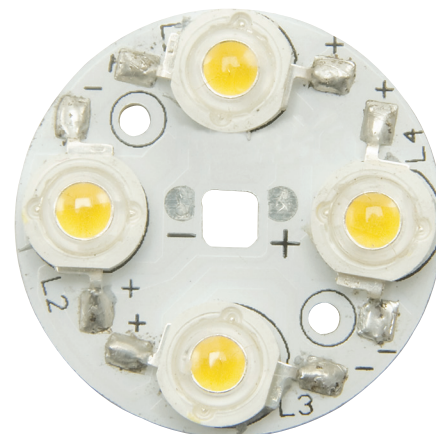

Outline dimensions:

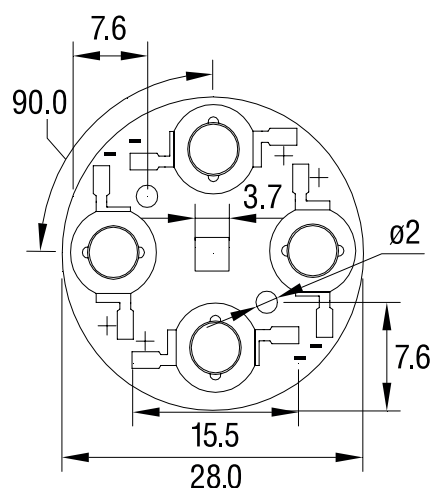

Unit: mm

Tolerance: ±0.3mm

Circuit:

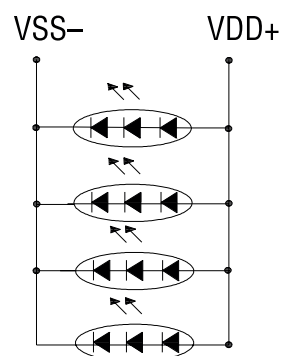

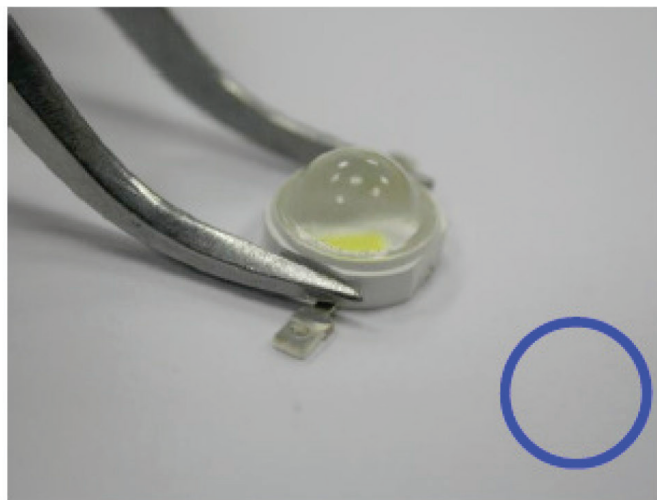
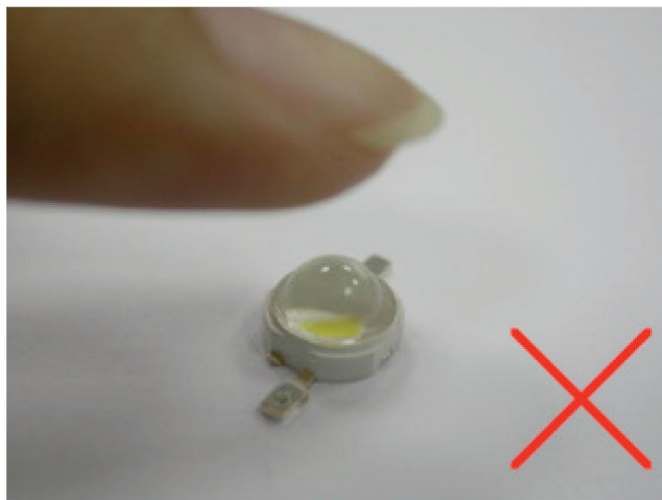
Product handling

- Please do not use a force of over 3kgf impact or pressure on the silicone lens, otherwise it will cause a catastrophic failure.
- The LEDs should only be picked up by making contact with the sides of the LED body.
- Avoid touching the silicone lens especially by sharp tools such as tweezers.
- Avoid leaving fingerprints on the silicone lens.
- Please store the LEDs away from dusty areas or seal the product against dust.
- When populating boards in SMT production, there are basically no restrictions regarding the form of the pick and place nozzle, except that mechanical pressure on the silicone lens must be prevented.
- Please do not mould over the silicone lens with another resin. (epoxy, urethane, etc)