

Features:

- Single chip
- Super high brightness of surface mount LED
- Compact package outline (L x W x T) of 3.2mm x 1.6mm x 0.8mm
- Compatible to IR reflow soldering

Applications

- Backlighting (switches, keys, etc.)
- Marker lights (e.g. steps, exit ways, etc.)

Outline dimensions:

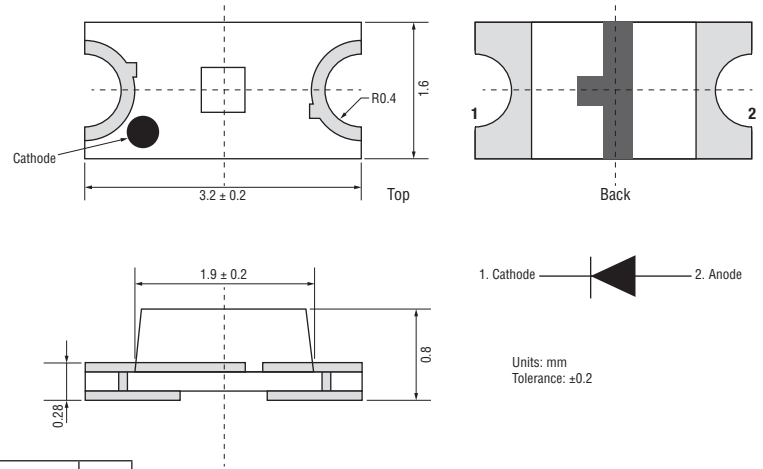

Absolute maximum rating (Ta=25°C)

Item	Symbol	Value		Unit
		WT/MT/BL/TG	YG/YL/OR/HR	
DC forward current	I _F	30	30	mA
Pulse forward current*	I _{FP}	100	100	mA
Reverse voltage	V _R	5	5	V
Power dissipation	P _D	108	78	mW
Operating temperature	Topr	-40 to +85		°C
Storage temperature	Tstg	-40 to +85		°C
Lead soldering temperature	Tsol	260°C/5sec		-

*Pulse width max. 0.1ms. Duty ratio max. 1/10

Directivity:

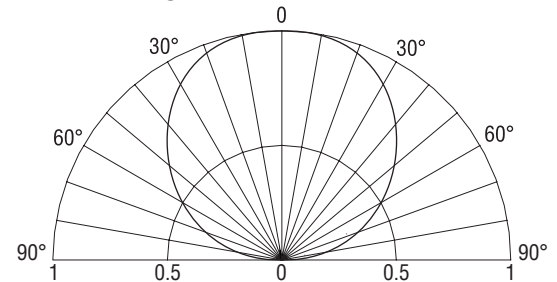

Electrical – Optical characteristics (Ta=25°C)

Order code	MPN	Colour		V _F (V)			I _R (μA)	I _v (mcd)			λ _D (nm)			2θ _{1/2} (deg)
				Min.	Typ.	Max.	Max.	Min.	Typ.	Max.	Min.	Typ.	Max.	Typ.
				I _F =20mA			V _R =5V	I _F =20mA						
56-3152	OSW51206C1C	White	W5	3.0	-	3.6	100	400	450	-	X=0.29, Y=0.29	120		
56-3153	OSM51206C1C	Warm White	M6	3.0	-	3.6	100	400	450	-	X=0.44, Y=0.41	120		
56-3155	OSK51206C1C	Pink	K5	2.8	-	3.6	100	60	90	-	X=0.38, Y=0.18	120		
56-3151	OSB51206C1C	Blue	B5	3.0	-	3.6	100	80	100	-	460 465 475	120		
56-3154	OSG51206C1C	Pure Green	G5	2.9	-	3.6	100	300	350	-	520 525 530	120		
56-3149	OSG81206C1C	Yellow Green	G8	1.8	-	2.6	100	20	45	-	565 570 575	120		
56-3148	OSY51206C1C	Yellow	Y5	1.8	-	2.6	100	60	90	-	585 590 595	120		
56-3150	OSO51206C1C	Orange	O5	1.8	-	2.6	100	100	120	-	600 605 610	120		
56-3147	OSR51206C1C	Red	R5	1.8	-	2.6	100	120	150	-	620 625 630	120		

Notes: V_f tolerance: ±0.05V

Dominant wavelength tolerance: ±1nm

Luminous intensity is NIST reading

Luminous intensity tolerance: ±10%

Optical and electrical characteristics:

TYPICAL ELECTRICAL/OPTICAL CHARACTERISTIC CURVES

