

Specifications

Pitch:	2.00mm
Type:	Straight Pin
Poles:	2 to 12
Rated Voltage:	100V
Rated Current:	2A
Operational Temperature:	-25°C to +85°C
Withstand Voltage:	800V AC for 60s
Insulation Resistance:	1000MΩ
Contact Resistance:	20MΩ
Recommended PC Board Thickness:	1.6mm
Housing Material:	Nylon 66

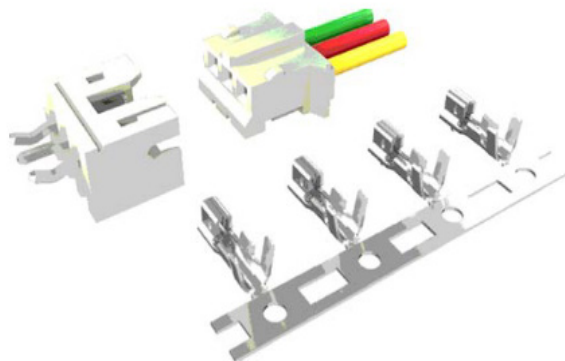

Order Code	Poles	$A = (N+1) * 2.00$	$B = (N-1) * 2.00 \pm 0.25$
65-6633	2	6.00	2.00
65-6634	3	8.00	4.00
65-6635	4	10.00	6.00
65-6636	5	12.00	8.00
65-6637	6	14.00	10.00
65-6638	8	18.00	14.00
65-6639	10	22.00	18.00
65-6640	12	26.00	22.00

Note: N = No. of contact

Male Right Angle

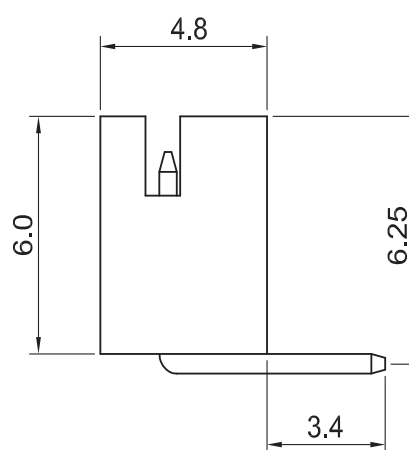
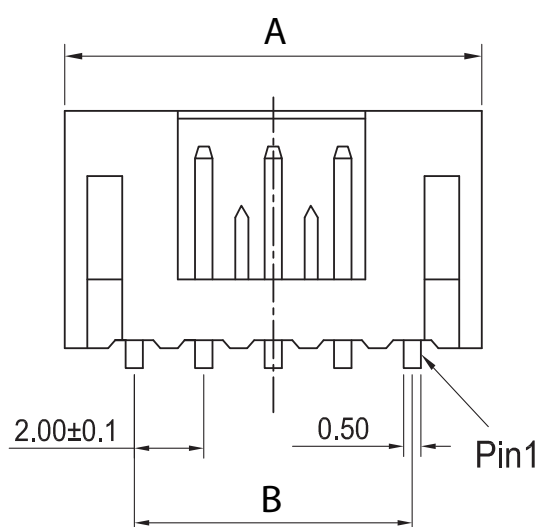

Straight Pin

For further information on pricing, delivery, and long-term stock agreements please get in touch with your local business development contact. Telephone our main office on **01206 751166** or email **Sales@Rapidonline.com**.

The information contained in this datasheet is subject to change without notice and replaces all data sheets previously supplied.

