

Specifications

Pitch:	2.5mm
Type:	Kinked Pin
Poles:	2 to 12
Rated Voltage:	250V
Rated Current:	3A
Operational Temperature:	-25°C to +85°C
Withstand Voltage:	500V AC for 60s
Insulation Resistance:	1000MΩ
Contact Resistance:	30MΩ
Recommended PC Board Thickness:	1.6mm
Housing Material:	Nylon 66

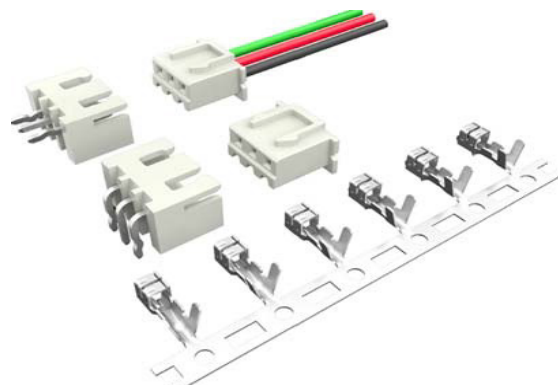

Order Code	Poles	$A = (N+1) * 2.5$	$B = (N-1) * 2.5$
65-6550	2	7.5	2.5
65-6651	3	10.0	5.0
65-6652	4	12.5	7.5
65-6653	5	15.0	10.0
65-6654	6	17.5	12.5
65-6655	8	22.5	17.5
65-6656	10	27.5	22.5
65-6657	12	32.5	27.5

Note: N = No. of contact

Male Vertical Type

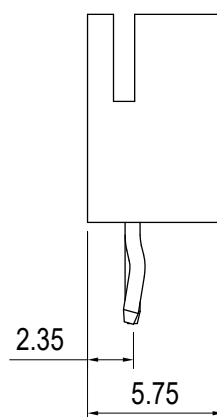
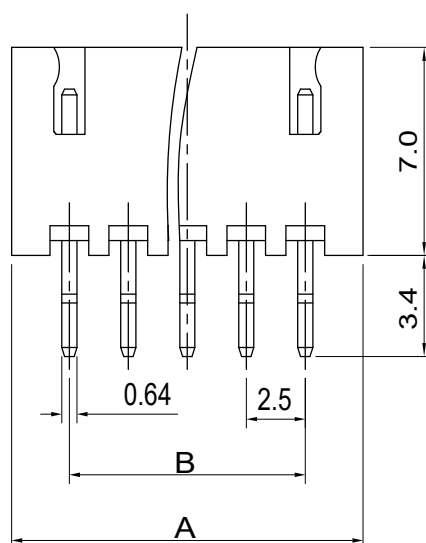

Kinked Pin

For further information on pricing, delivery, and long-term stock agreements please get in touch with your local business development contact. Telephone our main office on **01206 751166** or email **Sales@Rapidonline.com**.

The information contained in this datasheet is subject to change without notice and replaces all data sheets previously supplied.

