

### Specifications

Pitch:	2.54mm
Type:	R/A Header
Poles:	2 to 12
Rated Voltage:	250V
Rated Current:	3A
Operational Temperature:	-25°C to +85°C
Withstand Voltage:	1000V AC for 60s
Insulation Resistance:	1000MΩ
Contact Resistance:	30MΩ
Contact Material:	Copper Alloy
Contact Plating:	Tin Plating Over Nickel
Housing Material:	Nylon

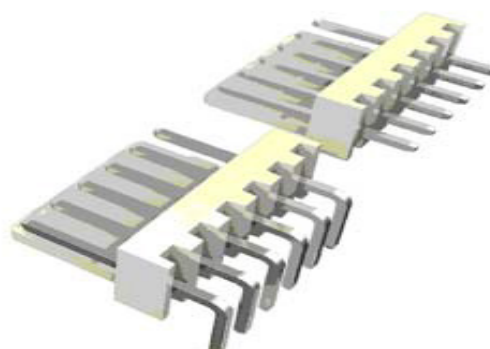

Order Code	Poles	$A = N * 2.54$	$B = (N-1) * 2.54 \pm 0.25$
65-6701	2	5.08	2.54
65-6702	3	7.62	5.08
65-6703	4	10.16	7.62
65-6704	5	12.07	10.16
65-6705	6	15.24	12.07
65-6706	8	20.32	15.24
65-6707	10	25.04	20.32
65-6708	12	30.48	30.48

**Note:** N = No. of contact

### Male Right Angle

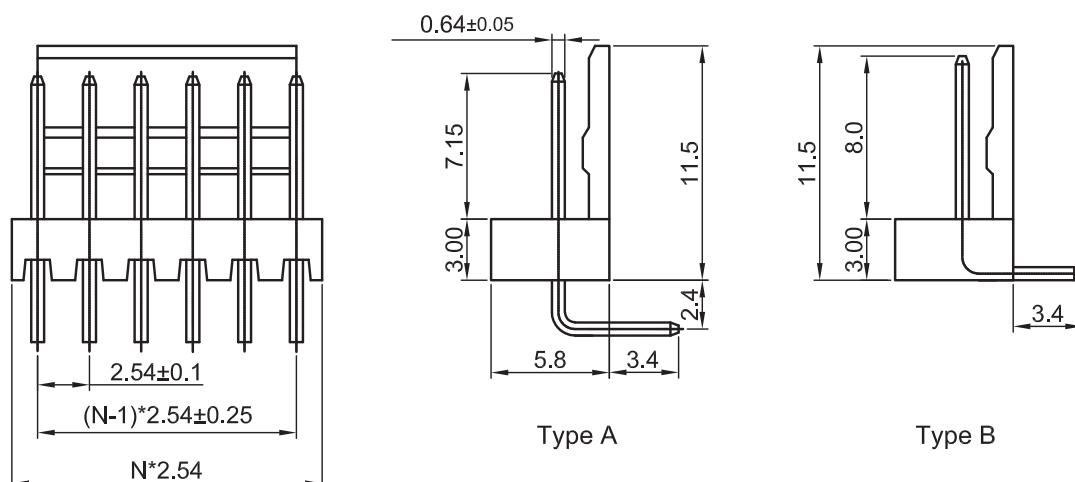

For further information on pricing, delivery, and long-term stock agreements please get in touch with your local business development contact. Telephone our main office on **01206 751166** or email **Sales@Rapidoonline.com**.

The information contained in this datasheet is subject to change without notice and replaces all data sheets previously supplied.

