

Material & Finish

Insulator material:	Thermoplastic Flame retardant to UL94V-0
Contact material:	Phosphor bronze, gold plated over nickel
Shell material:	Tin plated steel

Electrical Characteristics

Contact current rating:	5A
Dielectric withstand voltage:	1000V for 1 minute
Contact resistance:	10mΩ max. initial
Insulation resistance:	1000MΩ min.

Environmental Characteristics

Temperature Range:	-45°C to +105°C
Operating temperature:	0°C to +85°C



Order code	Type	Male/Female	A ±0.2	B ±0.2	C ±0.3	D
15-0400	15-way High Density 'D' Plug	M	30.81	24.99	16.92	19.28
15-0405	15-way High Density 'D' Socket	F	30.81	24.99	16.92	19.28
15-0410	26-way High Density 'D' Plug	M	39.14	33.32	25.25	27.51
15-0206	15-way High Density 'D' Plug	M	30.81	24.99	16.92	19.28
15-0207	15-way High Density 'D' Socket	F	30.81	24.99	16.92	19.28

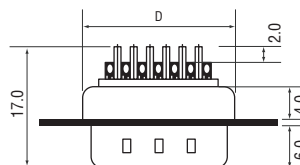
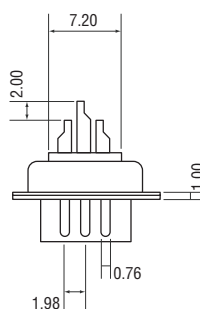
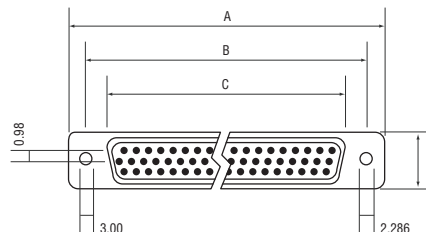
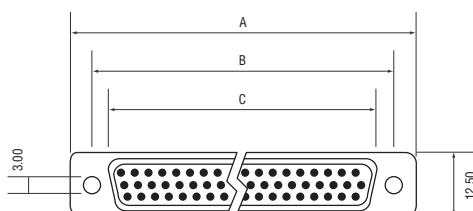

General Tolerance		Angle Tolerance	
x.	±0.60	x.	±5%
.x	±0.38	.x	±3%
.xx	±0.25	.xx	±2%

Measurements are in mm
unless stated otherwise.

For further information on pricing, delivery, and long-term stock agreements please get in touch with your local business development contact. Telephone our main office on **01206 751166** or email **Sales@Rapidonline.com**.

The information contained in this datasheet is subject to change without notice and replaces all data sheets previously supplied.

