

Specification

Manufacturer model: SCT019

Product name: Split core current transformer

Characteristics:

1. Installation method: suspended
2. Material of core: Permalloy
3. Operating temperature: $-25^{\circ}\text{C} \sim +60^{\circ}\text{C}$
4. Storage temperature: $-30^{\circ}\text{C} \sim +90^{\circ}\text{C}$
5. Dielectric strength: 3500V AC/min 5mA(secondary/shell)



Dimensions: (in:mm)

opening and closing way: pull plug type

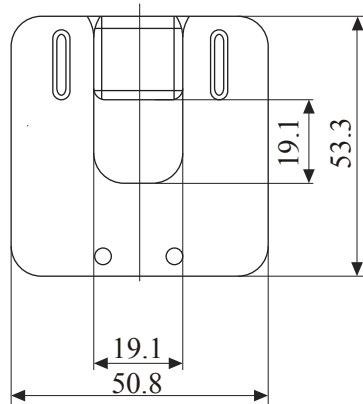

Front view

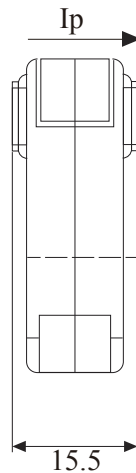

Side view

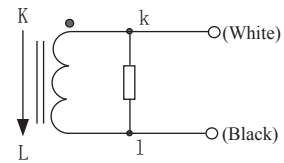

Connection diagram

Basic technical parameter table:

Input current	Output voltage	Accuracy	Work frequency	Weight
100A AC	0.333V	1%	20Hz-1KHz	91g

Note: 0.5mm² black and white twisted pair. Line length 2 meters.

Voltage output type does not allow short circuit.

The above parameters are typical values, and the actual values are based on the measured products.