

Preset potentiometers

Order code	Manufacturer code	Description
67-0400	WR085H01	100 OHMS MIN. CARBON PRESET
67-0402	WR085H022	200 OHMS MIN. CARBON PRESET
67-0404	WR085H047	500 OHMS MIN. CARBON PRESET
67-0405	n/a	n/a
67-0406	WR085H1	1K MINIATURE CARBON PRESET
67-0407	n/a	200 OHMS RESIN MOULDED TRIMMER
67-0408	WR085H2.2	2K MINIATURE CARBON PRESET
67-0410	WR085H4.7	5K MINIATURE CARBON PRESET
67-0412	WR085H10	10K MINIATURE CARBON PRESET
67-0414	WR085H22	20K MINIATURE CARBON PRESET
67-0415	n/a	n/a
67-0416	WR085H47	50K MINIATURE CARBON PRESET
67-0417	n/a	1K RESIN MOULDED TRIMMER
67-0418	WR085H100	100K MINIATURE CARBON PRESET
67-0420	WR085H220	200K MINIATURE CARBON PRESET
67-0422	WR085H470	500K MINIATURE CARBON PRESET
67-0424	WR085H1M	1M MINIATURE CARBON PRESET

Preset potentiometers	Page 1 of 4
The enclosed information is believed to be correct, Information may change 'without notice' due to product improvement. Users should ensure that the product is suitable for their use. E. & O. E.	Revision A 04/07/2003

APPEARANCE

DRAWING

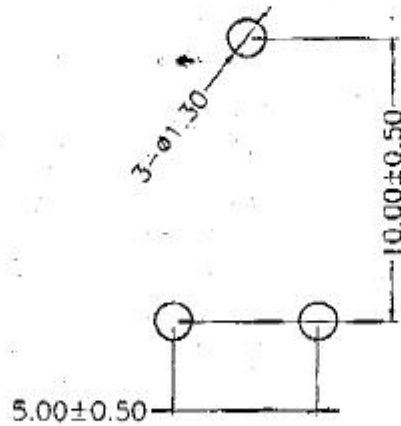
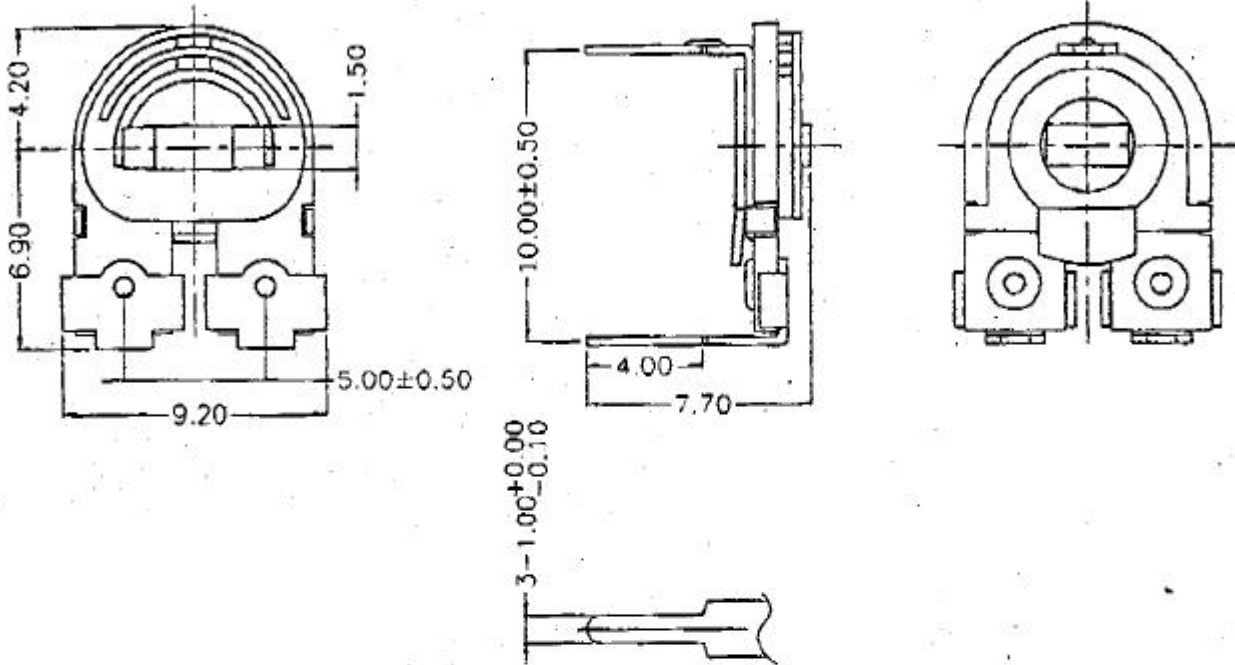

P.C.B LAYOUT

DRAWN	廖星村	17-04-2000	MODEL NO	WR-085 SERIES		
CHECKED	区球	17-4-2000	SCALE	DRAWING NO	REV	SHEET/OF
APPROVED	廖星村	2014-00	4:1	WY-013	P	

PRODUCT SPECIFICATIONS

Product Name:	Ø8mm Phenolic Carbon Film Type Semi-Fixed Potentiometer
Model No.:	WR-085 SERIES

I.

ELECTRICAL CHARACTERISTICS

1.1 Nominal Resistance:	100Ω ~ 1MΩ
1.2 Resistance Tolerance:	<input type="checkbox"/> ±10% <input type="checkbox"/> ±20% <input type="checkbox"/> ±30%
1.3 Residual Resistance	Max. 5% of Nominal Resistance, but under 30Ω
1.4 Resistance Taper	Linear (B)
1.5 Rated Power	0.1W
1.6 Operating Voltage	50V Max.
1.7 Rotational Life	Max. ±15% change in resistance after 100 unloaded rotations.
1.8 Load Life	Max. ±5% change in resistance after 3 hours loaded.

Prepared By	Checked By	Approved By	Document No.
<i>Jennifer</i> 29-08-02	<i>林</i> 29-8-02	<i>Leo Jan</i> 30-8-02	002-30-08-2002
			Version No.
			A2

PRODUCT SPECIFICATIONS

II.

MECHANICAL CHARACTERISTICS

2.1	Rotational Angle	270° ± 20°
2.2	Rotational Torque	80 ~ 300 g. cm.
2.3	Stop-end Strength	500g. cm minimum
2.4	Mechanical Strength	Bakelite Base not to be broken down under a force of 1 Kg.

III.

CLIMATIC CHARACTERISTICS

3.1	Operating Temp.	-5 °C ~ 40°C
3.2	Temp. Characteristics	Resistance change within +5 ~ 30% after 5 hours at 70°C.
3.3	Humidity Char.	Maximum resistance change within 20% after 350 hours loaded at 40°C and R. H. 90%.

IV.

SOLDERING CONDITIONS

4.1	Temperature	250°C
4.2	Time	2 seconds

Prepared By	Checked By	Approved By	Document No.
Jennifer 29-08-02	林 29-08-02	Leo Jan 30-8-02	002-30-08-2002
			Version No.
			A2