

U.I. Lapp GmbH	DATASHEET	
	Conductor end sleeves insulated	61801860 14.11.2013

Conductor end sleeves with insulation for cabinet builders , according to DIN or German colour code, CSA approved, halogen-free



Halogen-free

Application range

Control cabinets and equipment wiring

Benefits

Funnel-shaped opening makes it easy to slip them onto the strands
The conductor is permanently connected to the collar by crimping

Norm references / Approvals

All DIN conductor end-sleeves are in accordance with DIN 46228 Part 4
CSA approved, File-Number: LR 105629-1

Remark

K = short; N = medium; HL = large; L = extra large; Other sizes and colours are available upon request
Photographs are not to scale and do not represent detailed images of the respective products.

*Under some circumstances the end sleeves withstand temperatures under -5 °C. Please contact Lapp Kabel to clarify the specific application area.

Technical Data

Article designation:	AHI DIN L 16/18
For mm ² :	16
AWG:	6
Colour:	blue
l1 mm:	29
l2 mm:	18
d 1 mm:	6
s1 mm:	0.2
d 2 mm:	8.8
s2 mm:	0.4
Pieces / PU:	100
Note:	Halogen-free
Material:	Copper/PP Surface: tin-plated
Temperature range:	-5 °C to +105 °C*



Product Management	Document: Conductor end sleeves insulated	1 / 2
--------------------	---	-------

U.I. Lapp GmbH	DATASHEET	 LAPP GROUP
	Conductor end sleeves insulated	61801860 14.11.2013

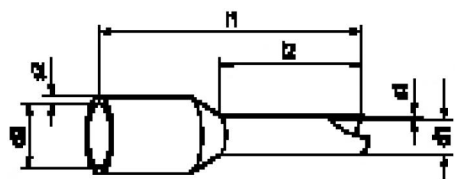

Product Management	Document: Conductor end sleeves insulated	2 / 2
--------------------	---	-------