

Modular Einbaubuchsen, 90° Modular Jacks, 90°

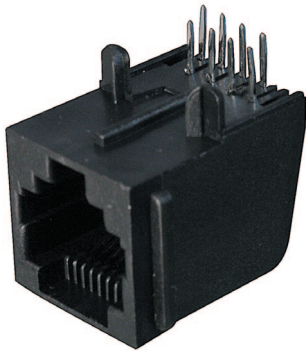

Gehäuse
Polyester, glasfaserverstärkt

Kontakte
Phosphorbronze

Kontaktfläche
6µ" Gold

Betriebstemperaturbereich
-40°C bis +85°C

Stromennbelastung
1.5A

Betriebsspannung
125V AC eff

Housing
Glass filled polyester

Contacts
Phosphorbronze

Contact finish
6µ" gold plating

Operating temperature
-40°C to +85°C

Current rating
1.5A

Voltage rating
125V AC rms

| Dimensions | | | | |
|-----------------|-------|-------|-------|------|
| No. of contacts | A | B | C | D |
| 4 (RJ11) | 13.72 | 11.18 | 7.62 | 3.81 |
| 6 (RJ12) | 15.75 | 13.21 | 10.16 | 6.35 |
| 8 (RJ45) | 17.78 | 15.24 | 11.43 | 8.89 |

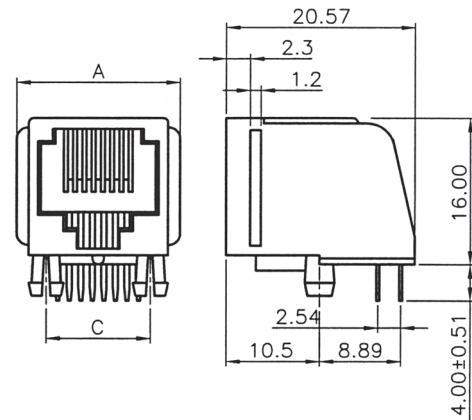
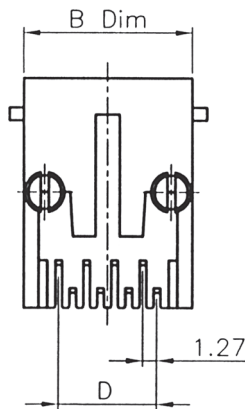
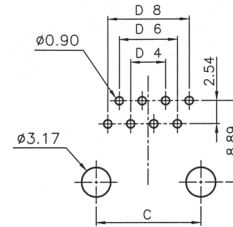

Bestellcode : **A** - **2004** - **x**
Ordercode :

Bitte „x“ durch die unten geeignete Option ersetzen
Please replace „x“ with appropriate option listed below

1.

1.

Polzahl
0 -4 polig (RJ11)
1 -6 polig (RJ12)
2 -8 polig (RJ45)

No. of contacts
0 -4 poles (RJ11)
1 -6 poles (RJ12)
2 -8 poles (RJ45)

D-Sub / Hoods
Centronics

Multiflex

Modular

USB

Switches

Powercords
Powersockets

MiniDIN

DIN4161x
Hardmetric

Sockets + Strips
Jumper