

Modular Einbaubuchsen, 180°, Top entry
Modular Jacks, 180°, top entry

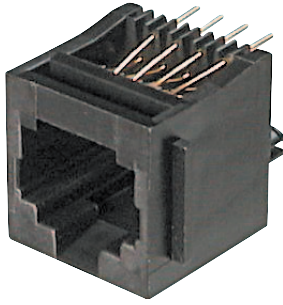

Gehäuse
Polyester, glasfaserverstärkt

Kontakte
Phosphorbronze

Kontaktoberfläche
6µ" Gold

Betriebstemperaturbereich
-40°C bis +85°C

Stromennbelastung
1.5A

Betriebsspannung
125V AC eff

Housing
Glass filled polyester

Contacts
Phosphorbronze

Contact finish
6µ" gold plating

Operating temperature
-40°C to +85°C

Current rating
1.5A

Voltage rating
125V AC rms

No. of contacts	Dimensions			
	A	B	C	D
4 (RJ11)	13.97	11.43	7.62	3.81
6 (RJ12)	16.00	13.46	10.16	6.35
8 (RJ45)	17.84	15.36	11.43	8.89

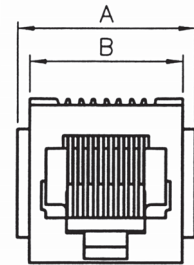
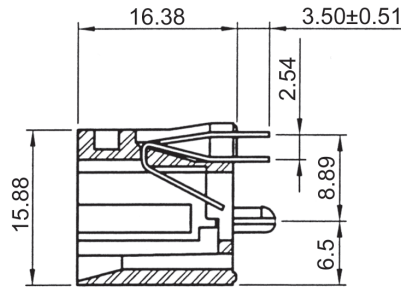
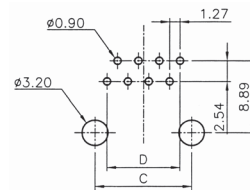

Bestellcode : **A** - **2014** - **x**
 Ordercode :

Bitte „x“ durch die unten geeignete Option ersetzen
 Please replace „x“ with appropriate option listed below

1.

- 1.**
- Polzahl**
- 0 -4 polig (RJ11)
 - 1 -6 polig (RJ12)
 - 2 -8 polig (RJ45)

- No. of contacts**
- 0 -4 poles (RJ11)
 - 1 -6 poles (RJ12)
 - 2 -8 poles (RJ45)

D-Sub / Hoods
Centronics

Multiflex

Modular

USB

Switches

Powercords
Powersockets

MiniDIN

DIN4161x
Hardmetric

Sockets + Strips
Jumper