

**Modular Einbaubuchsen, 180°, Top entry**  
**Modular Jacks, 180°, top entry**

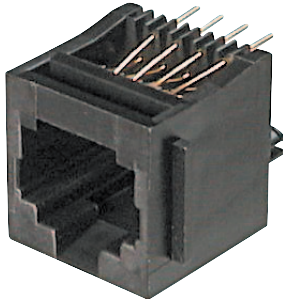

**Gehäuse**  
Polyester, glasfaserverstärkt

**Kontakte**  
Phosphorbronze

**Kontaktoberfläche**  
6µ" Gold

**Betriebstemperaturbereich**  
-40°C bis +85°C

**Stromennbelastung**  
1.5A

**Betriebsspannung**  
125V AC eff

**Housing**  
Glass filled polyester

**Contacts**  
Phosphorbronze

**Contact finish**  
6µ" gold plating

**Operating temperature**  
-40°C to +85°C

**Current rating**  
1.5A

**Voltage rating**  
125V AC rms

No. of contacts	Dimensions			
	A	B	C	D
4 (RJ11)	13.97	11.43	7.62	3.81
6 (RJ12)	16.00	13.46	10.16	6.35
8 (RJ45)	17.84	15.36	11.43	8.89

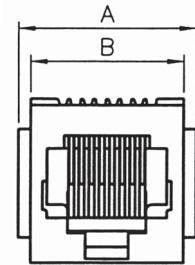
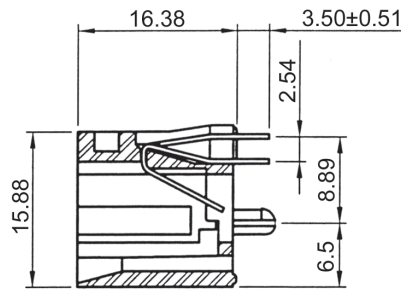
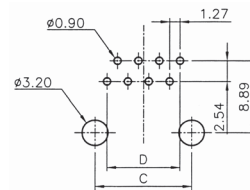

Bestellcode : **A** - **2014** - **x**  
 Ordercode :

Bitte „x“ durch die unten geeignete Option ersetzen  
 Please replace „x“ with appropriate option listed below

1.

- 1.**
- Polzahl**
- 0 -4 polig (RJ11)
  - 1 -6 polig (RJ12)
  - 2 -8 polig (RJ45)

- No. of contacts**
- 0 -4 poles (RJ11)
  - 1 -6 poles (RJ12)
  - 2 -8 poles (RJ45)

D-Sub / Hoods  
Centronics

Multiflex

Modular

USB

Switches

Powercords  
Powersockets

MiniDIN

DIN4161x  
Hardmetric

Sockets + Strips  
Jumper