

(CONTACTS-1)x2.54

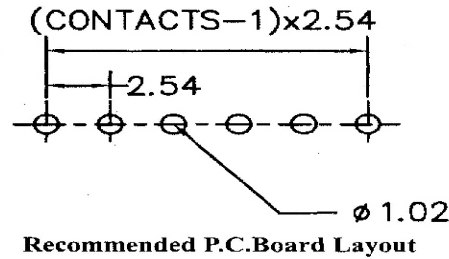
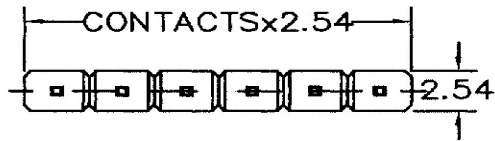

SPECIFICATIONS

Current Rating: 3 Amperes

Insulation Resistance: 1000M Ω Min

Dielectric Withstanding: 600V AC/DC

Contact Resistance: 20m Ω Max.

Operating Temperature: -40 $^{\circ}$ c to +105 $^{\circ}$ c

MATERIALS

Contact Material: Copper Alloy

Contact Plating: Gold / Tin over Nickel

Insulator: Glass Filled Polyester (UL 94V-0)

P.B.T or Nylon-6T

All materials must be RoHS compliant.

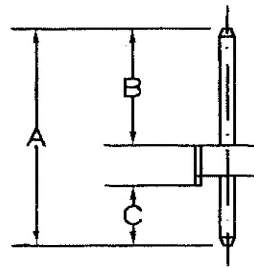
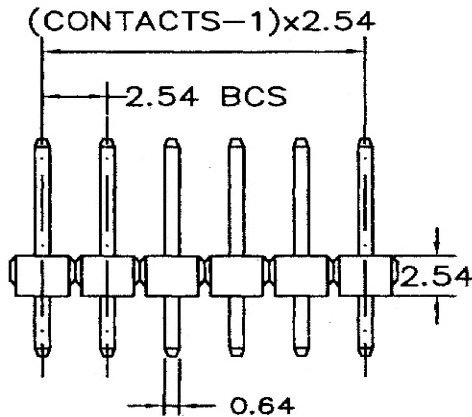

Terminal Code	Dimensions(mm)		
	A	B	C
PA	10.20	5.20	2.50
XPB	10.80	5.80	2.50
PC	11.60	5.80	3.30
PD	12.60	6.80	3.30
PE	14.00	8.20	3.30
PF	14.80	9.00	3.30
PG	17.90	12.10	3.30
XP PH	19.80	14.00	3.30
PJ	21.60	15.80	3.30
PK	22.80	17.00	3.30
PL	24.90	19.10	3.30
NF	11.60	6.00	3.10
NG	11.80	6.00	3.30
NH	12.60	7.00	3.10
NJ	13.50	8.00	3.00
NK	14.20	8.70	3.00
NL	16.00	10.50	3.00
NM	18.00	12.50	3.00
NN	20.00	14.50	3.00
TK	14.50	8.90	3.10
TL	11.30	5.50	3.30
TF	11.80	5.70	3.60

Datenblatt passend zu folgenden Artikelnummern

10120500 / 10120502 / 10120504 / 10120506 / 10120508 / 10120510

10120182 / 10120183 / 10120184