



INSTRUCTIONS FOR:
**VACUUM CLEANER INDUSTRIAL DUST FREE WET/DRY, 35L
1200W/230V PLASTIC DRUM, M CLASS FILTRATION, SELF
CLEANING FILTER, AUTO START**
MODEL NO: **DFS35M**

Thank you for purchasing a Sealey product. Manufactured to a high standard, this product will, if used according to these instructions, and properly maintained, give you years of trouble free performance.

IMPORTANT: PLEASE READ THESE INSTRUCTIONS CAREFULLY. NOTE THE SAFE OPERATIONAL REQUIREMENTS, WARNINGS & CAUTIONS. USE THE PRODUCT CORRECTLY AND WITH CARE FOR THE PURPOSE FOR WHICH IT IS INTENDED. FAILURE TO DO SO MAY CAUSE DAMAGE AND/OR PERSONAL INJURY AND WILL INVALIDATE THE WARRANTY. KEEP THESE INSTRUCTIONS SAFE FOR FUTURE USE.



Refer to
Instruction
Manual

1. SAFETY

1.1. ELECTRICAL SAFETY

WARNING! It is the responsibility of the owner and the operator to read, understand and comply with the following:

You must check all electrical products, before use, to ensure that they are safe. You must inspect power cables, plugs, sockets and any other connectors for wear or damage. You must ensure that the risk of electric shock is minimised by the installation of appropriate safety devices. A Residual Current Circuit Breaker (RCCB) should be incorporated in the main distribution board. We also recommend that a Residual Current Device (RCD) is used. It is particularly important to use an RCD with portable products that are plugged into a supply which is not protected by an RCCB. If in any doubt consult a qualified electrician. You may obtain a Residual Current Device by contacting your Sealey dealer.

You must also read and understand the following instructions concerning electrical safety.

1.1.1. The **Electricity at Work Act 1989** requires that all portable electrical appliances, if used on business premises, are tested by a qualified electrician, using a Portable Appliance Tester (PAT), at least once a year.

1.1.2. The **Health & Safety at Work Act 1974** makes owners of electrical appliances responsible for the safe condition of those appliances and the safety of the appliance operators. **If in any doubt about electrical safety, contact a qualified electrician.**

1.1.3. Ensure that the insulation on all cables and on the appliance is safe before connecting it to the power supply. See 1.1.1. and 1.1.2. and use a Portable Appliance Tester.

1.1.4. Ensure that cables are always protected against short circuit and overload.

1.1.5. Regularly inspect power supply cables and plugs for wear or damage and check all connections to ensure that none is loose.

1.1.6. **Important:** Ensure that the voltage marked on the appliance matches the power supply to be used and that the plug is fitted with the correct fuse - see fuse rating at right.

1.1.7. **DO NOT** pull or carry the appliance by the power cable.

1.1.8. **DO NOT** pull the plug from the socket by the cable.

1.1.9. **DO NOT** use worn or damaged cables, plugs or connectors. Immediately have any faulty item repaired or replaced by a qualified electrician. When a BS 1363/A UK 3 pin plug is damaged, cut the cable just above the plug and **dispose of the plug safely.**

Fit a new plug according to the following instructions (UK only).

a) **Connect the GREEN/YELLOW earth wire to the earth terminal 'E'.**

b) **Connect the BROWN live wire to the live terminal 'L'.**

c) **Connect the BLUE neutral wire to the neutral terminal 'N'.**

d) After wiring, check that there are no bare wires, that all wires have been correctly connected, that the cable outer insulation extends beyond the cable restraint and that the restraint is tight.

Double insulated products, which are always marked with this symbol , are fitted with live (brown) and neutral (blue) wires only.

To rewire, connect the wires as indicated above - **DO NOT** connect either wire to the earth terminal.

1.1.10. Products which require more than 13amps are supplied without a plug. In this case you must contact a qualified electrician to ensure that a suitably rated supply is available. We recommend that you discuss the installation of an industrial round pin plug and socket with your electrician.

1.1.11. If an extension reel is used it should be fully unwound before connection. A reel with an RCD fitted is preferred since any appliance plugged into it will be protected. The cable core section is important and should be at least 1.5mm², but to be absolutely sure that the capacity of the reel is suitable for this product and for others which may be used in the other output sockets, we recommend the use of 2.5mm² section cable. If an extension reel is to be used outdoors, ensure it is marked for outdoor use.

1.2. GENERAL SAFETY

- ✓ Disconnect the cleaner from the power supply before servicing, changing accessories, or performing any maintenance.
- ✓ Use only genuine parts and accessories. Unauthorised parts and accessories may be dangerous and will invalidate your warranty.
- ✓ Maintain the cleaner in good condition. Use an authorised agent for servicing. Keep machine clean, but **DO NOT** use solvents.
- ✓ For dry vacuuming ensure the cartridge filter is firmly in place before operating the cleaner.
- ✗ **DO NOT** operate the unit without the cartridge filter in place (except when wet vacuuming). **Using the cleaner without a cartridge filter may cause damage to the vacuum cleaner and will invalidate your warranty.**
- ✓ Wear protective clothing and gloves.
- ✗ **DO NOT** allow children or untrained persons to operate the cleaner.
- ✗ **DO NOT** place attachments close to your face (especially eyes, ears, etc). **DO NOT** point the hose end at other persons or animals.
- ✗ **DANGER! DO NOT** vacuum hot or glowing ash, cigarette ends, inflammable, explosive, corrosive or other dangerous substances.
- ✗ **DO NOT** operate the unit without the dust bag or optional cartridge filter (except when wet vacuuming).
- ✗ **DO NOT** use when the filter system is damaged.

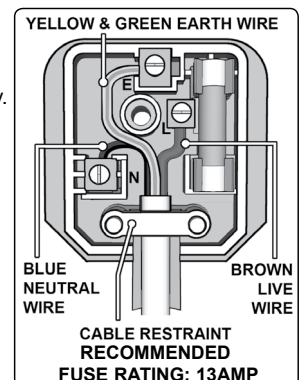

- ✗ **DO NOT** leave machine running unattended. Turn power supply OFF, and DO NOT leave the vicinity until motor has come to a complete stop.
- ✗ **DO NOT** operate the cleaner while under the influence of drugs, alcohol or impairing medication, or if you are tired.
- ✗ **DO NOT** use the cleaner in the rain or in very damp conditions.
- ✗ **DO NOT** use the cleaner for a task it is not designed to perform.
- ✓ When not in use, store the cleaner indoors, in a safe, dry, childproof location.
- **WARNING! The warnings, cautions and instructions in this manual cannot cover all possible conditions and situations that may occur. It must be understood by the operator that common sense and caution are factors which cannot be built into this product, but must be applied by the operator.**

NOTE: This appliance can be used by children aged from 8 years and above and persons with reduced physical, sensory or mental capabilities or lack of experience and knowledge if they have been given supervision or instruction concerning use of the appliance in a safe way and understand the hazards involved. Children shall not play with the appliance. Cleaning and user maintenance shall not be made by children without supervision.

2. INTRODUCTION

High powered unit suitable for use with air power tools and standard power tools. Certified for M class dust extraction in accordance with EU regulations, which protects the operator from dust particles hazardous to health. Supplied with Ø36mm flexible hose, multi-diameter tool adaptor, Crevice tool, power tool cord clamps, M-Class bag filter, M-Class cartridge filter and foam filter. Can be set to continuous suction or in conjunction with a pneumatic tool via the air outlet or power tool via a 2000W rated, electronically controlled outlet. Fitted with a self-cleaning filter technology designed to prevent filter blockages whilst in use. Fitted with four castors for manoeuvrability. Wet & Dry floor cleaning kit is available, order Model No. PC35ACC1.

3. SPECIFICATION

| | |
|--------------------------------|---------------|
| Model No: | DFS35M |
| Motor Power: | 1200W |
| Supply: | 230V |
| Maximum Vacuum Pressure: | 220mbar |
| Air Flow: | 180m³/hr |
| Drum Size: | .35ltr |
| Drum Type: | Plastic |
| Weight: | 11.5kg |
| Hose Ø: | .10-35mm |
| Power Tool Capacity: | 2000W |

4. CONTENTS

- 4.1. Unpack the carton carefully.
- 4.2. Locate the two side clasps which hold the motor housing in place.
- 4.3. Undo the clasps, remove the motor housing and take out the loose items from the drum.
- 4.4. Check and identify each component as listed below. If anything is missing or damaged please contact your Sealey stockist immediately.

5. ASSEMBLY

- 5.1. Ensure the electrical supply is disconnected.
- 5.2. Undo the clasps.
- 5.3. Lift off the motor housing assembly (fig.1).
- 5.4. For dry vacuum cleaning use the locking cartridge filter supplied.
- 5.5. For dry vacuum cleaning and containment use the vacuum bag supplied.
- 5.6. For wet vacuum cleaning fit the supplied foam filter.

NOTE: DO NOT operate the cleaner without a filter fitted as this will damage the vacuum cleaner and invalidate your warranty.

- 5.7. Replace the motor housing onto the container.
- 5.8. Align the motor housing with the clasps and snap closed by hooking the top of the clasp into the location in the motor housing and pressing the handles down over centre.



6. CONTROLS

6.1. Function symbols

6.1.1. For use as Wet & Dry Cleaner:

6.1.1.1. Depress Selector Switch (fig.2.A) and Power Switch (fig.2.B).

6.2. For use with an electric power tool.

6.2.1. Leave Selector Switch (fig.2.A) in raised position and depress the Power Switch (fig.2.B).

6.2.2. In this position, any single electric tool can be connected (up to a maximum of 2000W). Powering the tool will switch the vacuum cleaner on. When the tool is switched off, the vacuum cleaner will run for a further 8/10 seconds. After this the filter cleaning process will operate.

6.3. For use with an air tool.

6.3.1. Leave Selector Switch (fig.2.A) in raised position and depress the Power Switch (fig.2.B).

6.3.2. Connect the air supply to the air inlet connector (fig.2) and the tool to the air outlet connector (fig.2). A quick fit connector is included. When airflow to the tool is detected, the cleaner will operate. When the tool is switched off, the vacuum cleaner will run for a further 8/10 seconds. After this the filter cleaning process will operate.

NOTE: Continuous operation of the self cleaning system for more than 60 seconds may cause the thermal protection to trip, resetting after 20 minutes. (For fuller filter cleaning see section 9.)

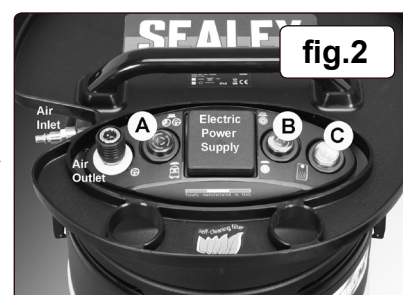

- 6.3.3. The warning lamp (fig.2.C) will illuminate when a high vacuum situation is detected. This could be caused by a blocked hose or nozzle, blocked filter or a full bag.
- 6.4. If the exhaust air speed drops below 20m/sec the warning lamp (fig.2.C) illuminates (in accordance with IEC/EN 60335-2-69).

7. DRY VACUUMING

- **WARNING! Ensure you read, understand and apply Section 1 'Safety Instructions'. Reminder: DO NOT vacuum hazardous substances, hot ashes or embers. Use of an incorrect cartridge filter will invalidate your warranty.**
- 7.1. **Category M Cartridge Filter. To pickup dust of Class M the dust bag MUST be installed in the appliance. To vacuum Class 'M' dust ALWAYS use the filter element.**
 - 7.1.1. Ensure the machine is unplugged from the power supply.
 - 7.1.2. Remove the motor housing and with the raised rim uppermost fit the filter cartridge tube down over the filter basket and push fully home. Place the locking disc onto the top of the filter and turn the locking bar until the latch drops into the slot in the top of the filter cage. Continue turning clockwise until the filter is fully locked down.
 - 7.1.3. Reposition the motor housing onto the drum body, and clip in place.
 - 7.1.4. Insert the larger end of the flexible hose into the front inlet on the container and lock in place. Push the required attachment, when applicable, onto the free end of the hose.
 - 7.1.5. Plug into the power supply.
 - 7.1.6. With the selector switch "A" in position , switch "B" to the 'On' (position 'I'). See 6.1.1 for introduction of a power tool.
 - 7.1.7. When you have completed vacuuming, press the switch "B" to 'Off' (position 'O').

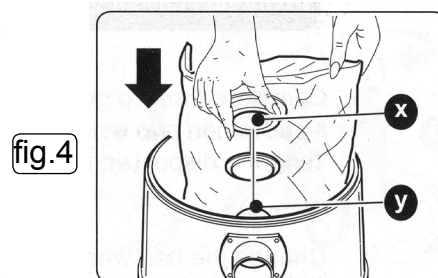
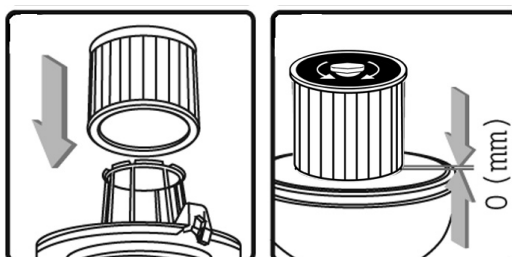

- **WARNING! Ensure you read, understand and apply Section 1 'Safety Instructions'. Reminder: DO NOT vacuum hazardous substances, hot ashes or embers.**
- 7.2. **Category M Containment Bag Filter. Never reuse the bag always replace it.**
 - 7.2.1. Ensure the machine is unplugged from the power supply.
 - 7.2.2. Remove the motor housing. Insert the Category M bag into the drum and fit the plastic socket "x" over the drum internal "y" spigot (fig.4).
 - 7.2.3. Reposition the motor housing onto the drum body, and clip in place.
 - 7.2.4. Insert the larger end of the flexible hose into the front inlet on the container drum. Push the required attachment, when applicable, onto the free end of the hose.
 - 7.2.5. Plug into the power supply.
 - 7.2.6. With the selector switch "A" in position , switch "B" to the 'On' (position 'I'). See 6.1.1 for introduction of a power tool.
 - 7.2.7. When you have completed vacuuming, press the switch "B" to 'Off' (position 'O').
 - 7.2.8. When the bag is 3/4 full or vacuuming efficiency drops, remove the bag and seal the opening with the attached plug. Dispose of the bag in accordance with local regulations. **DO NOT** re-use.
 - 7.2.9. Avoid using the bag for sharp or damp materials.

8. WET VACUUMING

The Category M filter is NOT for liquids. Vacuuming liquids is only allowed where there is no chance that dust will be sucked up.

- **WARNING! Ensure you read, understand and apply Section 1 'Safety Instructions'. Reminder: Remove the plug from power supply before opening unit. DO NOT vacuum solvents, explosives, inflammable and/or hazardous liquids such as petrol, oil, spirits, paint, thinners, acids etc.**
 - 8.1. Ensure the machine is unplugged from the power supply. Make sure the drum is clean and free from dust and dirt.
 - 8.2. Remove the cartridge filter and fit a foam filter (NOT suitable for Class M dust) over the filter basket. Replace the motor housing onto the container.
 - 8.3. Fit the crevice nozzle to the flexible hose.
 - 8.4. Ensure the switch "B" is 'Off' (position 'O') before plugging into the power supply.
 - 8.5. With the selector switch "A" in position , switch "B" to the 'On' (position 'I'). See 6.1.1. for introduction of a power tool.
- Note:** To vacuum large quantities of liquid, from a sink or tank etc, **DO NOT** immerse the nozzle completely in the liquid, leave a gap (fig.6) at the top of the nozzle opening to allow an air inflow. The machine is fitted with a float valve which stops the suction action when the tank has reached its maximum capacity. The user will notice an increase in motor speed. When this happens, turn off the machine, disconnect from power supply, remove the head from the container and empty the liquid into a suitable receptacle or drain. To continue vacuuming, refit the head and proceed. After wet vacuuming, turn the machine off and unplug from the power supply. Empty the container, clean and dry the inside and outside before storage.

Remember! After wet vacuuming the foam filter must be removed and a cartridge filter must be fitted before dry vacuuming again.

- **WARNING! Not designed for liquid storage. Always empty liquids after use before storing.**

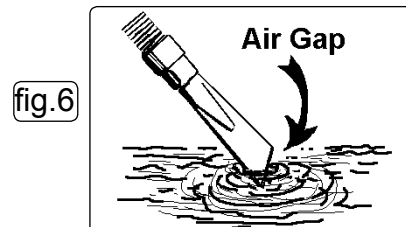
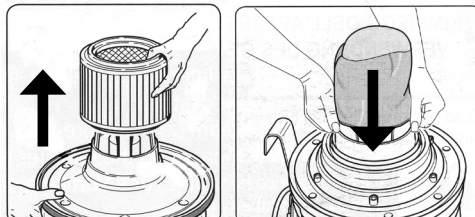
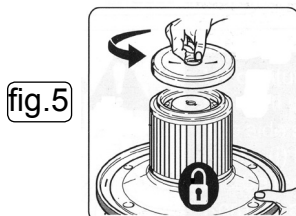

9. FILTER CLEANING

- 9.1. Handle the filter carefully when cleaning or installing. Unlock and carefully remove the cartridge filter and inspect it for damage. A filter that has small holes or tears in it will not perform efficiently and should be replaced.
- 9.2. To clean a dry filter, tap it inside a waste bin. (The cartridge filter is designed for dry vacuuming only). Should the filter be inadvertently wetted it should be rinsed **from the inside** and allowed to air dry for 24 hours.
- * **DO NOT** use the filter wet as the filter will clog quickly and be very difficult to clean.
- 9.3. Fit a new/cleaned filter over the filter basket
- 9.4. Lock in place as described in 7.1.2. (0mm clearance).

fig.7

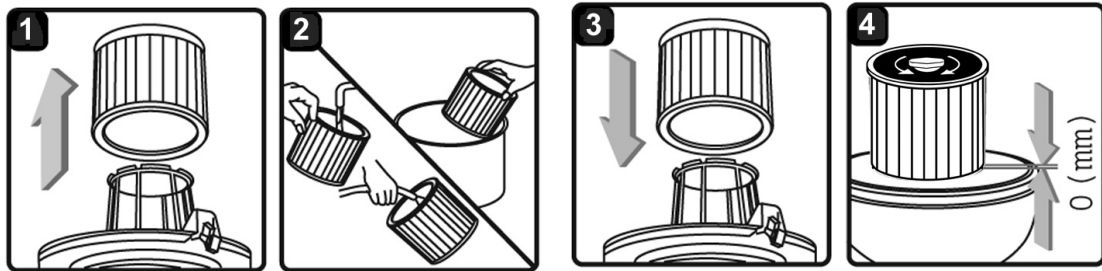

10. MAINTENANCE

- 10.1. Ensure the machine is unplugged from the power supply.
- 10.2. Disconnect the hose from the drum container.
- 10.3. Undo the clasps and remove motor housing from the drum container.
- 10.4. Clear out any dirt or debris from the drum container and hoses. Frequently clean the seat where the safety float slides and periodically inspect it to check its integrity.
- 10.5. Clean the foam filter by washing it in a mild soapy solution.
- 10.6. Check the power cable to make sure that it is not damaged.

11. CONSUMABLES

Locking Cartridge Filter (Must be used for dry vacuuming) Model No: DFS35CF

Foam Filter Model No: DFS35FF

IMPORTANT! IF THE MACHINE IS USED WITHOUT A FILTER FITTED THIS MAY CAUSE DAMAGE TO THE MOTOR AND YOUR GUARANTEE WILL BE INVALIDATED. ALWAYS KEEP A SPARE CARTRIDGE FILTER HANDY.

Category M Dust Bags (Pack of 5) Model No. DFS35PB

12. TROUBLESHOOTING

| Symptom | Possible causes | Solutions |
|-------------------------------------------------------------------------|------------------------------------------------------------|-------------------------------------------------------------------------------------------------------------------------------------|
| Vacuum will not operate | No power supply | Check power supply - cable, breakers, fuses. |
| | Faulty power cable | Unplug and check the power cable. If damaged have it replaced by your local Sealey stockist. |
| | Container full | Empty container |
| Dust expelled from the motor cover | Cartridge filter missing or damaged | Fit cartridge filter or replace damaged filter |
| Reduced efficiency and increased motor/speed vibration/orange light (C) | There is a blockage in the nozzle/hose/drum inlet/ filter. | See 7.1.4. Check nozzle, hose and container inlets and clear any blockages found. Remove filter and clean it or install new filter. |

Parts support is available for this product. To obtain a parts listing and/or diagram, please log on to www.sealey.co.uk, email sales@sealey.co.uk or telephone 01284 757500.

Environmental Protection



Recycle unwanted materials instead of disposing of them as waste. All tools, accessories and packaging should be sorted, taken to a recycling centre and disposed of in a manner which is compatible with the environment.

When the product becomes completely unserviceable and requires disposal, drain off any fluids (if applicable) into approved containers and dispose of the product and the fluids according to local regulations.



WEEE Regulations

Dispose of this product at the end of its working life in compliance with the EU Directive on Waste Electrical and Electronic Equipment (WEEE). When the product is no longer required, it must be disposed of in an environmentally protective way. Contact your local solid waste authority for recycling information.

NOTE: It is our policy to continually improve products and as such we reserve the right to alter data, specifications and component parts without prior notice.

IMPORTANT: No liability is accepted for incorrect use of this product.

WARRANTY: Guarantee is 12 months from purchase date, proof of which will be required for any claim.



Sole UK Distributor, Sealey Group.
Kempson Way, Suffolk Business Park,
Bury St. Edmunds, Suffolk.
IP32 7AR



01284 757500



01284 703534



www.sealey.co.uk



sales@sealey.co.uk