

Weller® FT

FILTER SYSTEMS

WFE



Betriebsanleitung - Operating Instructions - Mode d'emploi - Istruzioni per l'uso - Manual de uso - Manual do utilizador - Gebruiksaanwijzing - Instruktionsbok - Betjeningsvejledning - Käyttöohjeet - Οδηγίες Λειτουργίας - Kullanım kılavuzu - Návod k použití - Instrukcja obsługi - Üzemeltetési utasítás - Návod na používanie - Navodila za uporabo - Kasutusjuhend - Naudojimo instrukcija - Lietošanas instrukcija - Ръководство за работа - Manual de exploatare - Naputak za rukovanje

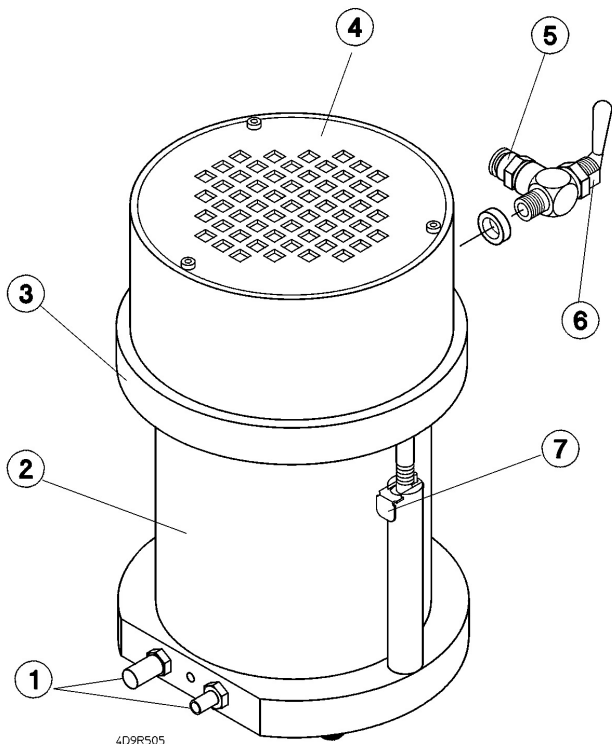

1. Anschlussnippel für FE-LötKolben
2. Hauptfilterkartusche
3. Vakuumgehäuse
4. Abdeckung für Abluftfilter
5. Druckluftanschluß
6. Absperrventil
7. Lift für Filterwechsel

1. Raccord pour fer à souder FE
2. Cartouche filtrante principale
3. Carter à vide
4. Couverture pour le filtre à air sortant
5. Raccord d'air comprimé
6. Robinet d'arrêt
7. Elévateur pour le changement de filtre

1. Aansluitnippel voor FE-soldeerbout
2. Hoofdfilterpatron
3. Vacuümkamer
4. Afdekkap voor afvoerluchtfilter
5. Persluchtaansluiting
6. Afsluiter
7. Lift voor filterwissel

1. Nippolo di collegamento per stilo brasatore FE
2. Cartuccia filtro principale
3. Involucro sotto vuoto
4. Copertura per il filtro dell'aria di scarico
5. Collegamento aria compressa
6. Valvola di chiusura
7. Leva per sostituzione filtro

1. Connector nipple for FE soldering bit
2. Main filter cartridge
3. Vacuum casing
4. Cover for exhaust air filter
5. Compressed air connection
6. Cut-off valve
7. Lifting device for changing filters

1. Anslutningsnippel för FE-lödkolv
2. Huvudfilterpatron
3. Vakuumhus
4. Lock för frånluftfilter
5. Tryckluftanslutning
6. Avstängningsventil
7. Lyft för filterbyte

Thank you for placing your trust in our company by purchasing the Weller WFE soldering fume extraction unit. Production was based on stringent quality requirements which guarantee the perfect operation of the device.

1. Caution!

Please read these Operating Instructions and the attached safety information carefully prior to initial operation. Failure to observe the safety regulations results in a risk to life and limb.

The manufacturer shall not be liable for damage resulting from misuse of the machine or unauthorised alterations.

The Weller WFE soldering fume extraction unit corresponds to the EC Declaration of Conformity in accordance with the basic safety requirements of Directives 2004/108/EC, 2006/95/EC and 2011/65/EU (RoHS).

2. Description

The Weller WFE soldering fume extraction unit is equipped with a maintenance-free compressed air converter for vacuum generation and is therefore ideally suited to continuous industrial operation. The compressed air converter is adequately designed to extract the soldering fumes from 2 Weller Fumex-Extraction soldering bits. The vacuum hoses of the FE soldering bits are connected directly to the WFE soldering fume extraction unit. To operate the WFE cleaned, dry compressed air (3.5 bar - 6 bar) is required. The compressed air can be switched off using a control valve on the unit's compressed air connection.

A built-in lifting device for changing the filters allows trouble-free replacement of the filter cartridge and preliminary filters without the aid of tools.

The 3-stage filter installed, comprising fine particulate air filter F7, Class E12 particulate filter and wide band gas filter (50% activated carbon; 50% Puratex) is ideally suited in this configuration to the extraction of soldering fumes. The particulate filter and the gas filter are contained in the main filter cartridge. Both filter elements are disposable filters and the fine particulate air filter (preliminary filter) can be changed several times before the main filter cartridge has to be replaced.

Together with the exhaust air filter (activated carbon), which absorbs odours caused by compressed air, the WFE is used as a circulating air unit. It is not necessary to draw off the exhaust air.

Warning:

When using extraction equipment, the legal limits with regard to contaminants in the workplace must be observed and regularly checked by the operator of the extraction equipment.

Technical data

Operating pressure:	3.5 - 6 bar of cleaned, dry compressed air
Compressed air connection:	AD 6 mm hose
Height:	200 mm
Diameter:	140 mm
Weight:	2.7 kg
Noise level:	39 dBA at 1 m intervals
Air consumption:	30 l/min
3-stage filter:	Fine particulate air filter F7 Class E12 particulate filter Wide band gas filter: 50% activated carbon, 50% Puratex

3. Commissioning

Place the FE soldering bit in the safety rest. The WFE-P soldering fume extraction unit is equipped for the connection of 2 Weller FE soldering bits (5). On connection of an FE soldering bit, the vacuum hose is attached to the open connector nipple. The second connector remains closed. Only take off the closure cap on connection of a second vacuum hose.

Insert the compressed air hose, external diameter 6 mm (PUN-6 x 1) into the compressed air connection (5) of the WFE as far as it will go.

If the compressed air supply is correct (3.5 - 6 bar, clean oil-free) connect the WFE to the compressed air supply system and, if necessary, open the control valve (6).

Maintenance

Before maintenance work is undertaken, the unit must be switched to its unpressurised state.

In order to guarantee trouble-free operation of the unit, the vacuum tube and extraction hose of the FE soldering bit must be cleaned regularly. If heavily soiled, the extraction tube can be placed in a gas-tight sealed container in cleaning alcohol (spirit) until the flux residues have dissolved.

Warning: When using cleaning agents, the legal safety provisions with regard to their handling must be observed. The cleaning agent must be treated as hazardous waste and must be disposed of in accordance with the prevailing local regulations.

If the extraction performance of a cleaned FE soldering bit is no longer adequate, the filters must be checked. The preliminary filter can be changed several times before the main filter has to be replaced.

When original WELLER filters are used in the prescribed manner, the service lives of the particulate filter and the wide band gas filter are designed to be approximately equal.

To change the filters, the two release buttons (7) for the lifting device must be pressed simultaneously. The built-in lifting device lifts up the vacuum casing (3) and exposes the main filter cartridge (2). The main filter cartridge and the preliminary filter below it can then be replaced without the use of tools (see also exploded-view drawing).

To change the exhaust air filter, the cover (4) on the top of the unit must be screwed off. The exhaust air filter cartridge can then be taken out of the vacuum casing (3).

Warning: When inserting filters, take care to follow the correct sequence and fit them in the appropriate position. The soiled filters must be treated as hazardous waste.

4. Operating information

The WFE soldering fume extraction unit is not suitable for the extraction of flammable gas.

Warning: Only remove the compressed air hose from the unit in its unpressurised state.

To remove the compressed air hose, press the unlocking ring of the rapid-fitting pipe union and pull out the hose.

5. List of accessories (Europe only)

5 26 162 99	FE 80 soldering bit 80W
5 25 153 99	FE 50 soldering bit 50W
5 32 152 99	FE 50M Magnastat soldering bit 50W
5 29 106 99	FE 25 soldering bit 25W
5 25 125 99	FE retrofit kit for LR-21, LR-82, TCP-S
5 29 125 70	FE retrofit kit for MLR-21
5 13 125 99	FE retrofit kit for DS-22, DS-80
5 15 030 99	AK-20 rest for soldering bit with FE add-on
5 15 076 99	KHE stop-and-go rest

6. Scope of supply

The WFE-P is equipped with:

- 1 fine particulate air filter F7
- 1 main filter cartridge consisting of Class E12 particulate filter and gas filter:
 - 50% activated carbon, 50% Puratex
- 1 exhaust air filter
- 1 PUN 6 x 1 compressed air hose
- 1 set of operating instructions
- 1 safety information

Illustration: exploded-view drawing - see page 48

Subject to technical alterations and amendments!

See the updated operating instructions at www.weller-tools.com.

- 5 70 073 99 **DK**
- 5 70 043 99 **L**
- 5 70 072 99 **GH**
- 5 70 070 99 **GB**
- 5 70 040 99 **D**
- F**

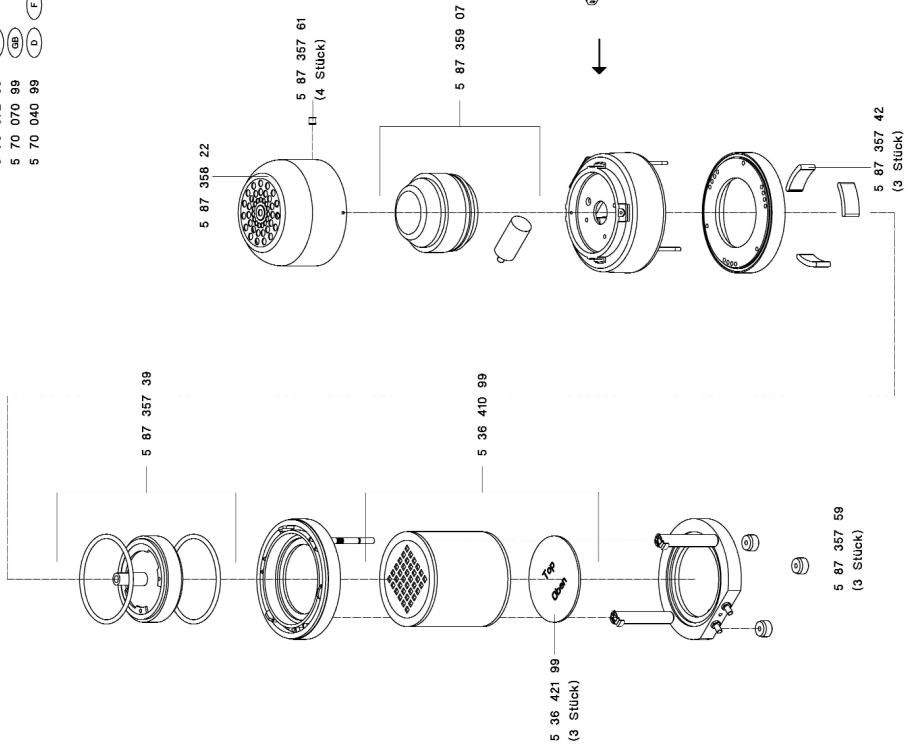

WFE P. (2)
JDR796/1

GERMANY**Weller Tools GmbH**

Carl-Benz-Str. 2
74354 Besigheim
Phone: +49 (0) 7143 580-0
Fax: +49 (0) 7143 580-108

GREAT BRITAIN**Apex Tool Group**

(UK Operations) Ltd
4th Floor Pennine House
Washington, Tyne & Wear
NE37 1LY
Phone: +44 (0) 191 419 7700
Fax: +44 (0) 191 417 9421

FRANCE**Apex Tool France SNC**

25 Av. Maurice Chevalier
77832 Ozoir-la-Ferrière
Phone: +33 (0) 1.64.43.22.00
Fax: +33 (0) 1.64.43.21.62

ITALY**Apex Tool S.r.l.**

Viale Europa 80
20090 Cusago (MI)
Phone: +39 (02) 9033101
Fax: +39 (02) 90394231

SWITZERLAND**Apex Tool Switzerland Sàrl**

Crêt-St-Tombet 15
2022 Bevaix
Phone: +41 (0) 24 426 12 06
Fax: +41 (0) 24 425 09 77

AUSTRALIA**Apex Tools - Australia**

P.O. Box 366
519 Nurigong Street
Albury, N. S. W. 2640
Phone: +61 (2) 6058-0300
Fax: +61 (2) 6021-7403

CANADA**Apex Tools - Canada**

5925 McLaughlin Rd. Mississauga
Ontario L5R 1B8
Phone: +1 (905) 501-4785
Fax: +1 (905) 387-2640

CHINA**Apex Tool Group**

A-8 Building, No. 38 Dongfang Road,
Heqing Industrial Park, Pudong
Shanghai 201201
Phone: +86 (21) 60 88 02 88
Fax: +86 (21) 60 88 02 89

USA**Apex Tool Group, LLC**

14600 York Rd. Suite A
Sparks, MD 21152
Phone: +1 (800) 688-8949
Fax: +1 (800) 234-0472

T005 56 112 12 / 03.2015

T005 56 112 09 / 09.2013

www.weller-tools.com

Weller[®]FT
FILTER SYSTEMS