

Weller®

WFE P (2)

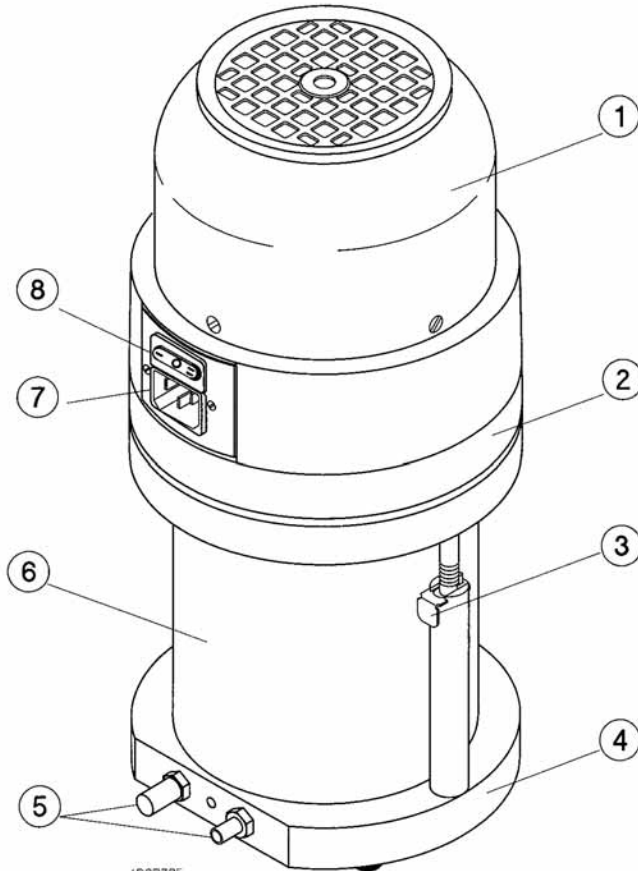

Betriebsanleitung - Mode d'emploi - Gebruiksaanwijzing - Istruzioni per l'uso - Operating Instructions - Instruktionsbok - Manual de uso - Betjeningsvejledning - Manual do utilizador - Käyttöohjeet - Οδηγίες Λειτουργίας - Kullanim kılavuzu - Návod k použití - Instrukcja obsługi - Üzemeltetési utasítás - Návod na používanie - Navodila za uporabo - Kasutusjuhend - Naudojimo instrukcija - Lietošanas instrukcija - Ръководство за работа - Manual de exploatare - Naputak za rukovanje



4D9R795

4D9R795
28 01 03/eis

1. Abdeckhaube
2. Pumpengehäuse
3. Lift für Filterwechsel
4. Vakuumgehäuse
5. Anschlußnippel für FE-LötKolben
6. Hauptfilterkartusche
7. Netzanschlubelement
8. 2-stufiger Netzschalter

1. Capot
2. Carter de pompe
3. Système pour le changement de filtre
4. Carter à vide
5. Raccord pour fer à souder FE
6. Cartouche filtrante principale
7. Élément de raccordement secteur
8. Interrupteur secteur à 2 positions

1. afdekkap
2. pomphuis
3. lift voor filterwissel
4. vacuümkamer
5. aansluitnippel voor FE-soldeerbout
6. hoofdfilterpatroon
7. stroomaansluitelement
8. 2-traps netschakelaar

1. Cofano di copertura
2. Involucro pompa
3. Dispositivo di sollevamento per sostituzione filtro
4. Involucro del vuoto
5. Ugello di collegamento per brasatore FE
6. Cartuccia filtro principale
7. Alimentatore
8. Interruttore di rete a 2 posizioni

1. Covering hood
2. Pump casing
3. Lifting device for changing filters
4. Vacuum casing
5. Connector nipple
6. Main filter cartridge
7. Mains connection element
8. 2-setting mains switch

1. Hölje
2. Pomphus
3. Lyft för filterbyte
4. Vakuumhus
5. Anslutningsnippel till FE-lödkolvar
6. Huvudfilterpatron
7. Nätslutningselement
8. 2-stegsnätströmbrytare

WFE P (2)



Thank you for placing your trust in our company by pur the Weller WFE P. Production was based on stringent quality requirements which guarantee the perfect operation of the device.



1. Caution!

Please read these operating instructions and the attached safety information carefully prior to initial operation. Failure to observe the safety regulations results in a risk to life and limb.

The manufacturer shall not be liable for damage resulting from misuse of the machine or unauthorised alterations.

The Weller WFE P corresponds to the EC Declaration of Conformity in accordance with the basic safety requirements of Directives 2004/108/EC and 2006/95/EC.

2. Description

The Weller WFE P is a solder fume extractor designed for one or two Weller FE soldering guns. Thanks to a maintenance-free pump drive and low noise operation, the equipment is ideal for continuous-duty industrial applications in the workplace.

Please note that the pump is not maintenance free and unsuitable for 24 hour continuous duty.

The vacuum hoses of the FE soldering bits are connected directly to the WFE P soldering fume extraction unit. A built-in thermal cut-out protects the unit against overload. A built-in lifting device for changing the filters allows trouble-free replacement of the filter cartridge and preliminary filters without the aid of tools.

The 3-stage filter installed, comprising fine particulate air filter F7, Class E12 particulate filter and wide band gas filter (50% activated carbon; 50% Puratex) is ideally suited in this configuration to the extraction of soldering fumes. The particulate filter and the gas filter are contained in the main filter

cartridge. Both filter elements are disposable filters and the fine particulate air filter (preliminary filter) can be changed several times before the main filter cartridge has to be replaced.

Warning:

When using extraction equipment, the legal limits with regard to contaminants in the workplace must be observed and regularly checked by the operator of the extraction equipment.

3. Commissioning

Place the FE soldering bit in the safety rest. The WFE P soldering fume extraction unit is equipped for the connection of 2 Weller FE soldering bits (5). On connection of an FE soldering bit, the vacuum hose is attached to the open connector nipple. The second connector remains closed. Only take off the closure cap on connection of a second vacuum hose.

Before commissioning, check the mains voltage against the information on the type plate. If the mains voltage is correct, connect the WFE P to the mains (7) and switch on 2-setting mains switch (8):

1st setting: 1 FE soldering iron

2nd setting: 2 FE soldering irons

Maintenance

Before maintenance work is undertaken, the unit must be disconnected from the mains by pulling out the mains plug.

In order to guarantee trouble-free operation of the unit, the vacuum tube and extraction hose of the FE soldering bit must be cleaned regularly. If heavily soiled, the extraction tube can be placed in a gas-tight sealed container in cleaning alcohol (spirit) until the flux residues have dissolved.

Technical data

Mains voltage:	230V AC
Power consumption:	70 W
Max. vacuum:	30.000 Pa
Max. carrying capacity:	30 l./min.
Noise level:	40 dB(A) at 1m intervals
Protection category:	1
Dimensions:	140 x 295 diameter x height
Capacity:	max. 2 FE soldering irons
3-stage filter:	Fine particulate air filter F7 Class E12 (formerly H13) particulate filter Wide band gas filter: 50% activated carbon, 50% Puratex

Warning:

When using cleaning agents, the legal safety provisions with regard to their handling must be observed. The cleaning agent must be treated as hazardous waste.

If the extraction performance of a cleaned FE soldering bit is no longer adequate, the filters must be checked. The preliminary filter can be changed several times before the main filter has to be replaced.

When original Weller filters are used in the prescribed manner, the service lives of the particulate filter and the wide band gas filter are designed to be approximately equal.

To change the filters, the two release buttons (3) for the lifting device must be pressed simultaneously. The built-in lifting device lifts up the pump casing (2) and exposes the main filter cartridge (6). Following this, the main filter cartridge and the preliminary filter below it can be replaced without the use of tools (see also exploded-view drawing).

Before the new main filter cartridge is fitted it should be marked with the date of installation. The unit should be installed in reverse sequence.

Warning:

When inserting filters, take care to follow the correct sequence and fit them in the appropriate position. The soiled filters must be treated as hazardous waste.

4. Operating information

The pump casing (2) simultaneously acts as a heat sink and consequently heats up. Excessive heating is prevented by a built-in thermal cut-out.

The WFE P soldering fume extraction unit is not suitable for the extraction of flammable gases.

5. List of accessories

FE soldering iron for soldering fume extraction

T005 33 150 99	FE 50 soldering iron set 50 W
T005 32 152 99	FE 50M Magnastat soldering iron 50 W
T005 33 151 99	FE 75 soldering iron set 80 W
T005 26 162 99	FE 80 soldering iron 80 W
T005 29 162 99	WSP 80 FE soldering iron 80 W

Supplementary parts

T005 29 167 99	FE accessory for WSP 80
T005 29 177 99	FE accessory for WMP
T005 25 125 99	FE accessory for LR 21, LR 82, TCP S
T005 13 125 99	FE accessory for DS 22, DS 80, DSX 80
T005 28 126 99	FE accessory for WSF P5/8
T005 36 352 99	Locking clip for FE soldering iron
T005 25 410 00	Replacement hose for all FE soldering irons (by the metre)
T005 29 186 99	FE accessory kit with suction pipes ø 6 mm for WSP 80, WP 80, MLR 21, MLR 80, WMP
T005 29 185 99	FE accessory kit with suction pipes ø 4.5 mm for WMRP and WSP 80, WP 80, MLR 21, MLR 80, WMP
T005 87 448 75	Clip set for FE accessory pipe ø 4.5 mm
T005 87 448 76	Clip set for FE accessory pipe ø 6 mm
T005 15 156 99	WDH 50 stand for soldering iron WMRP with accessory kit
T005 15 076 99	Stop and go iron stand KHE
T005 15 065 99	Cable clip for AK 20
T005 15 066 99	Cable clip for KH 20/23
T005 36 412 00	Fine particulate air filter F7

6. Scope of supply

The WFE P is equipped with:

- 1 fine particulate air filter F7
- 1 main filter cartridge consisting of Class E12 particulate filter and gas filter:
 - 50% activated carbon, 50% Puratex
- 1 mains cable
- 1 set of operating instructions
- 1 Safety Information

Illustration: exploded-view drawing - see page 47

Subject to technical alterations and amendments!

See the updated operating instructions at www.weller-tools.com.

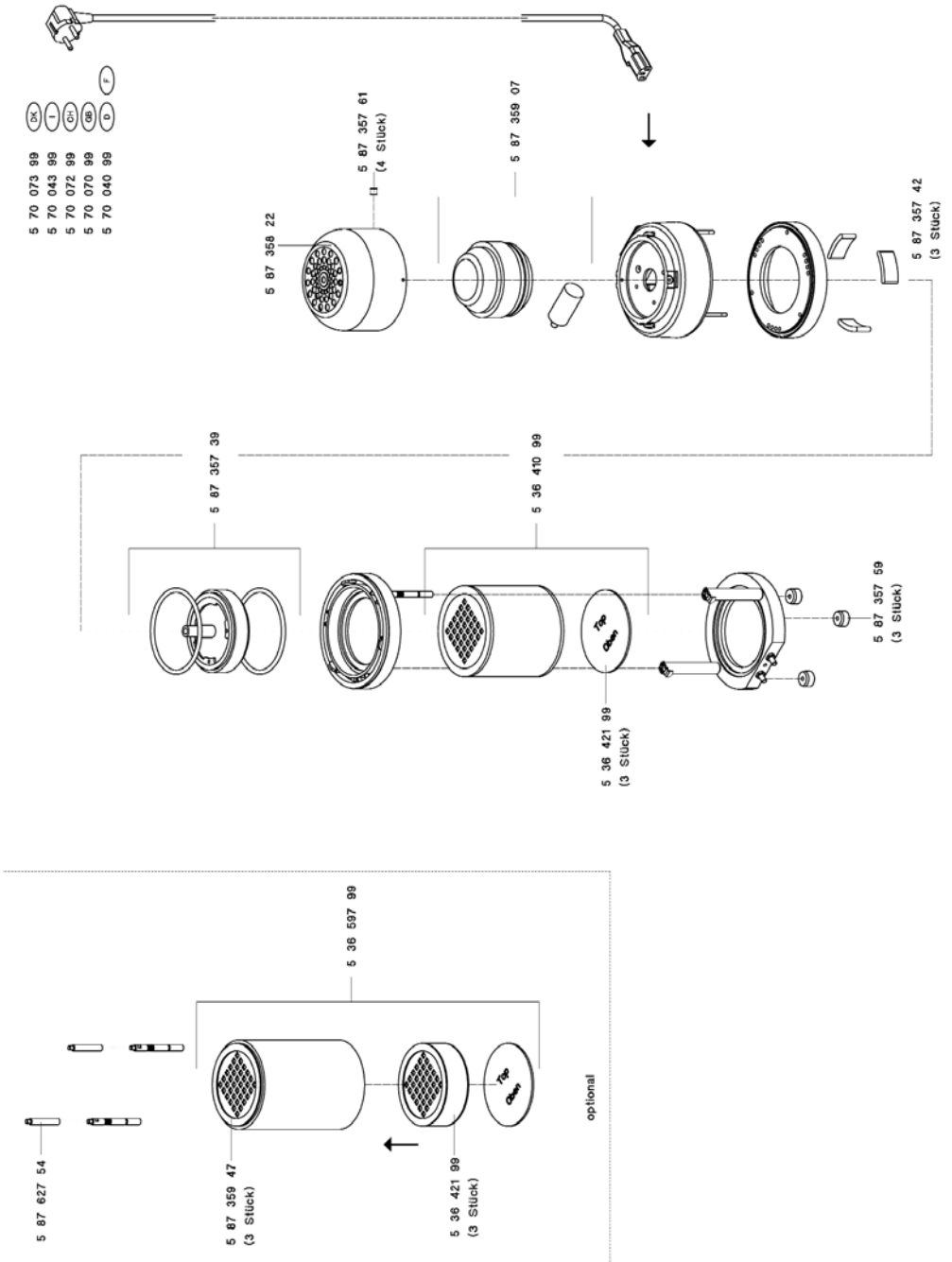

GERMANY**Weller Tools GmbH**

Carl-Benz-Str. 2
74354 Besigheim
Phone: +49 (0) 7143 580-0
Fax: +49 (0) 7143 580-108

GREAT BRITAIN**Apex Tool Group**

(UK Operations) Ltd
4th Floor Pennine House
Washington, Tyne & Wear
NE37 1LY
Phone: +44 (0) 191 419 7700
Fax: +44 (0) 191 417 9421

FRANCE**Apex Tool Group S.N.C.**

25 av. Maurice Chevalier
77832 Ozoir-la-Ferrière
Phone: +33 (0) 1.64.43.22.00
Fax: +33 (0) 1.64.43.21.62

ITALY**Apex Tool S.r.l.**

Viale Europa 80
20090 Cusago (MI)
Phone: +39 (02) 9033101
Fax: +39 (02) 90394231

SWEDEN**Apex Tool Group AB**

Fabriksgratan 4
531 30 Lidköping
Phone: +46 (0) 510 77 71 20

INDIA**Apex Power Tools India Pvt. Ltd.**

Regus business centre,
Level 2, Elegance, Room no. 214,
Mathura Road, Jasola,
New Delhi - 110025

AUSTRALIA**Apex Tools**

P.O. Box 366
519 Nurigong Street
Albury, N. S. W. 2640
Phone: +61 (2) 6058-0300
Fax: +61 (2) 6021-7403

CANADA**Apex Tools - Canada**

5925 McLaughlin Rd. Mississauga
Ontario L5R 1B3
Phone: +1 (905) 501-4785
Fax: +1 (905) 387-2640

CHINA**Apex Tool Group**

2nd Floor, Area C, 177 Bi Bo Road
Pudong New Area
Shanghai 201203 P.R.C.
Phone: +86 (21) 60 88 03 20

USA**Apex Tool Group, LLC**

14600 York Rd. Suite A
Sparks, MD 21152
Phone: +1 (800) 688-8949
Fax: +1 (800) 234-0472

T005 56 055 15 / 02.2016

T005 56 055 14 / 02.2012

www.weller-tools.com**Weller®**