

LITHION BGX300

Rapid

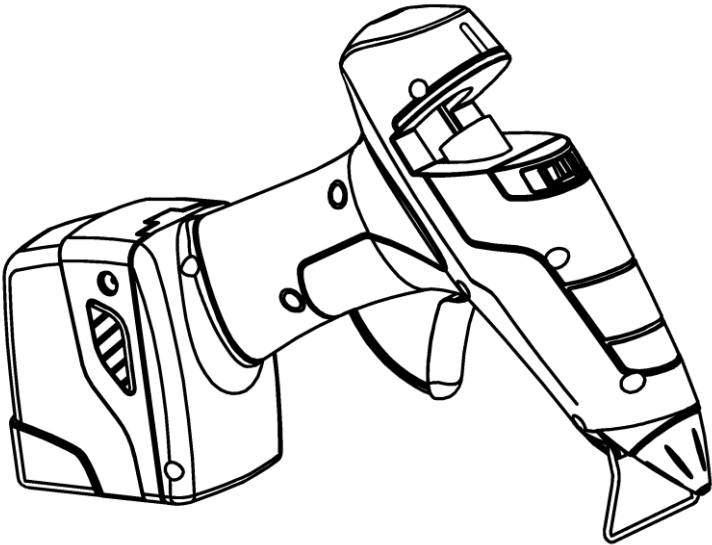

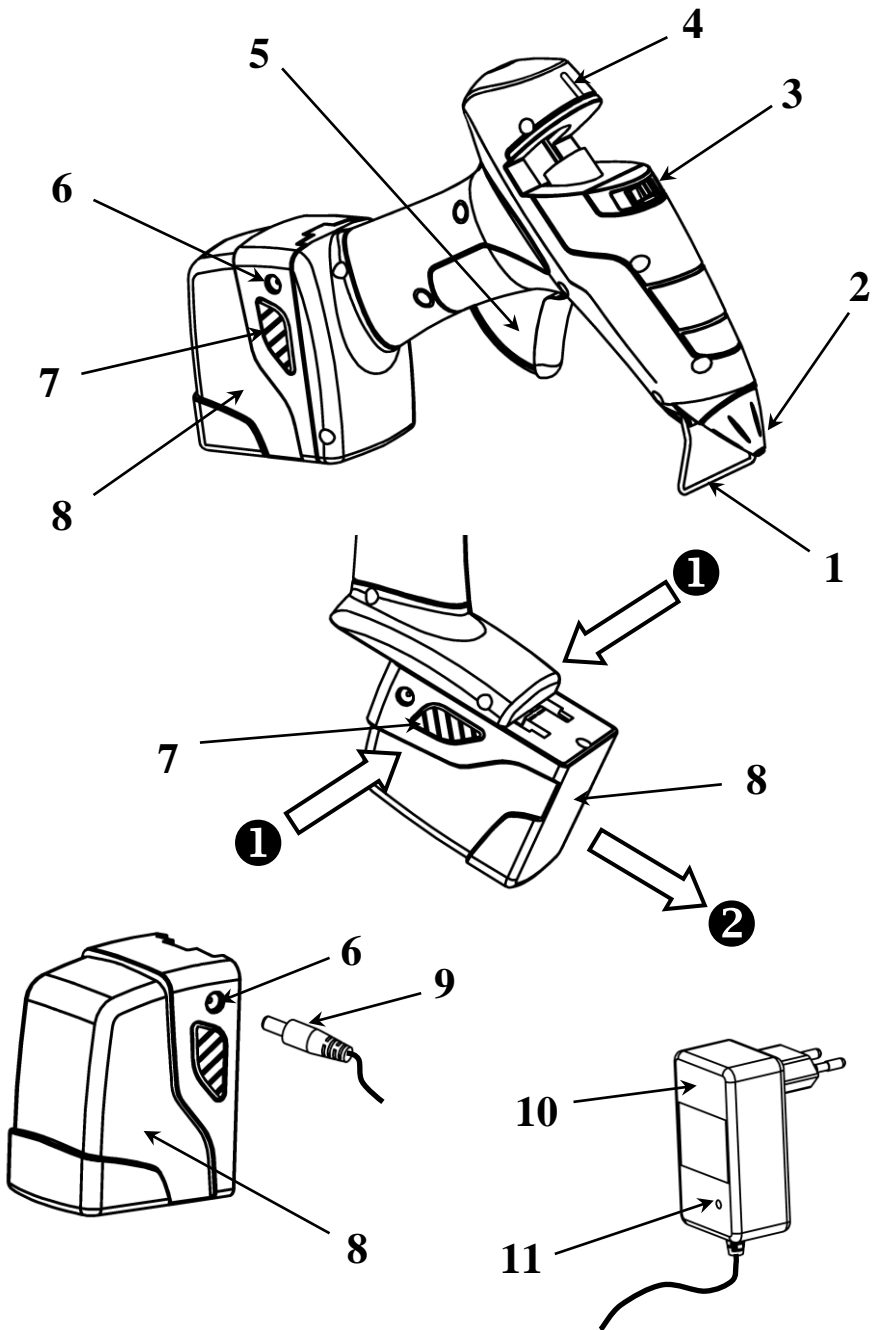



Safety instructions:



Warning! Read carefully before using the glue gun – hot melt applicator.

Failure to follow the warnings and instructions listed below may result in electric shock, fire and/or serious injury. Save all warnings and instructions for future reference.



Work area safety:

- Keep work area clean and well lit. Cluttered or dark areas invite accidents.
- Do not operate tool in explosive atmospheres, such as in the presence of flammable liquids, gases or dust.
- When applying at a height, take all the necessary precautions to ensure that the glue does not run onto the operator or onto any object.
- When you have finished using the tool, wait until it has cooled before to store it.

Electrical safety:



- Do not use or store the tool in damp or wet conditions. Do not expose it to water or other fluid substances in any way.
- Never pull the cord to unplug the charger.
- The appliance must be disconnected from the supply means when removing the battery.
- Do not use the tool if any part is damaged or defective.

Personal safety:

- Both the glue and the nozzle of the tool can reach temperatures up to 200°C (400°F).
- Avoid all skin contact. If burnt, plunge the burn under cold water. Never attempt to remove solidified glue from burnt skin without medical assistance.
- This appliance is not intended for use by persons (Including children) with reduced physical, sensory or mental capabilities, or lack of experience and knowledge, unless they have been given supervision or instruction concerning use of the appliance by a person responsible for their safety. Children should be supervised to ensure that they do not play with the appliance.

Batteries safety:

- Never attempt to open for any reason.
- Do not expose the battery to water and any other liquids.
- Do not expose the battery to heat.
- The battery is to be disposed of safely.
- Do not store in locations where the temperature may exceed 40°C.
- Charge only at ambient temperature between 10°C and 40°C.
- Charge only using the charger provided with the tool.

Charger safety:



- The charger is double insulated; therefore no earth wire is required. Always check that the mains voltage corresponds to the voltage on the rating plate.



- The charger is intended for indoor use only.
- Use your charger only to charge the battery in the tool with which it was supplied. Other batteries could burst, causing personal injury and damage.
- Do not expose the charger to water.
- Do not open the charger.
- Replace the charger if the wire is damaged.

Technical features:

Specifications:

- 1 – Tool support
- 2 – Nozzle
- 3 – On/off switch
- 4 – Tool LED light
- 5 – Trigger
- 6 – Socket
- 7 – Battery unlocking button.
- 8 – Battery
- 9 – Plug
- 10 – Charger
- 11 – Charger LED

Tool:

- Power rating: 30 W
- Battery life: ≈ 1 hour

Battery:

- Voltage: 7,4 V
- Capacity: 2600 mAh
- Time of charging: < 4 hours

Charger:

- Input: 100-240V 50-60Hz
- Output: 8,4 V cc
- Intensity: 1000 mA

- **Glue:** Rapid Ø12 mm

Operating instructions of tool:

- Removal and connection of the battery (8): To remove the battery (8), press the unlocking buttons (7) and slide the battery out of the machine. To connect the battery; slide it in the other direction until the connection clicks.
- Stand the tool upright on his support (1) and the battery (8). Never put the tool flat on a table.
- Start-up: switch the "on/off switch" (3) on "I" (on). The green LED (4) light come on.
- Leave the tool warming up several minutes.
- Feed glue sticks in to the rear of the tool.
- Place the nozzle of the tool against the surface and press gently on the trigger to extrude glue. Place the second element in contact with the glue, if need be adjust it and press parts together for an average of 10 seconds.
- Use only glue sticks recommended.
- Never pull/remove a glue stick from the tool once it has been fed into the tool. The resultant molten glue could create irreparable damage to the tool.
- Once finished, put the switch (3) on "0" (off).
- When the battery is discharged, the green LED light (4) will go out.

Operating instructions of charger:

- Do not use the tool whilst.
Ensure the tool is switched in the "off" position "0", or remove the battery out off the tool.
- Connect the charging point (9) of the charger into the socket (6) off the battery.
- Connect the charger (10) to the mains. → the LED (11) on the charger will turn red during the charge.
- When the battery is full charged, the LED (11) off the charger turn green.
- Disconnect the plug (9) out off the socket (6) and unplug the charger (10) from the mains.
- During the process of charging, the charger can become warm: this is normal.

Protecting the environment:



Separate Collection. Do not dispose of power tools into household waste!

According to the European Directive 2002/96CE on waste electrical and electronic equipment

- Should you find one day that your tool needs replacement, or if it is of no further use to you, do not dispose of it with household waste. Bring it to a separate collection centre for recycling.
- Battery: the batteries are recyclables.
The battery can be recharged many times. At the end of their useful life, run the battery down completely, then remove it from the tool, and take it to a local recycling station.