

# PTC

470|640



# BOSCH

**de** Originalbetriebsanleitung

**en** Original instructions

**fr** Notice originale

**es** Manual original

**pt** Manual original

**it** Istruzioni originali

**nl** Oorspronkelijke gebruiksaanwijzing

**da** Original brugsanvisning

**sv** Bruksanvisning i original

**no** Original driftsinstruks

**fi** Alkuperäiset ohjeet

**el** Πρωτότυπο οδηγιών χρήσης

**tr** Orijinal işletme talimatı

**pl** Instrukcja oryginalna

**cs** Původní návod k používání

**sk** Pôvodný návod na použitie

**hu** Eredeti használati utasítás

**ru** Оригинальное руководство по

эксплуатации

**uk** Оригінальна інструкція з

експлуатації

**kk** Пайдалану нұсқаулығының

түпнұсқасы

**ro** Instrucțiuni originale

**bg** Оригинална инструкция

**mk** Оригинално упатство за работа

**sr** Originalno uputstvo za rad

**sl** Izvirna navodila

**hr** Originalne upute za rad

**et** Algpärane kasutusjuhend

**lv** Instrukcijas oriģinālvalodā

**lt** Originali instrukcija

**ar** تعليمات التشغيل الأصلية



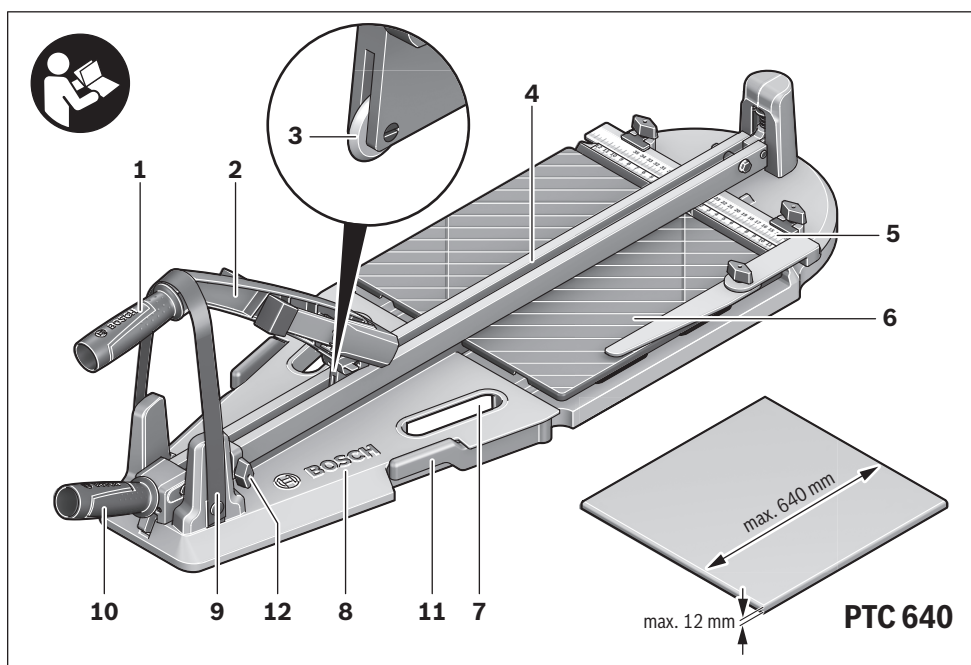
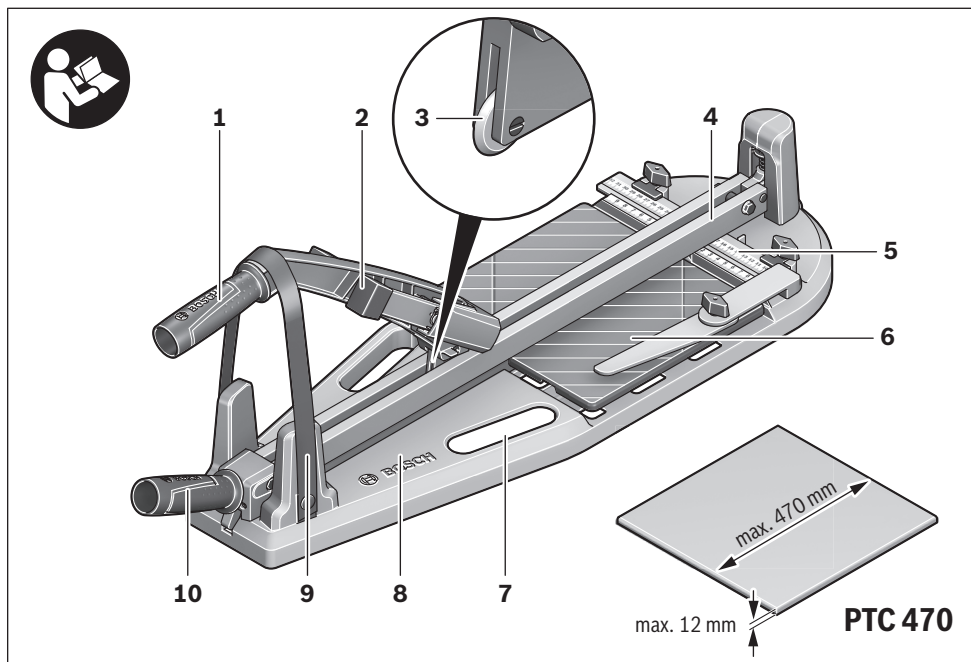

1

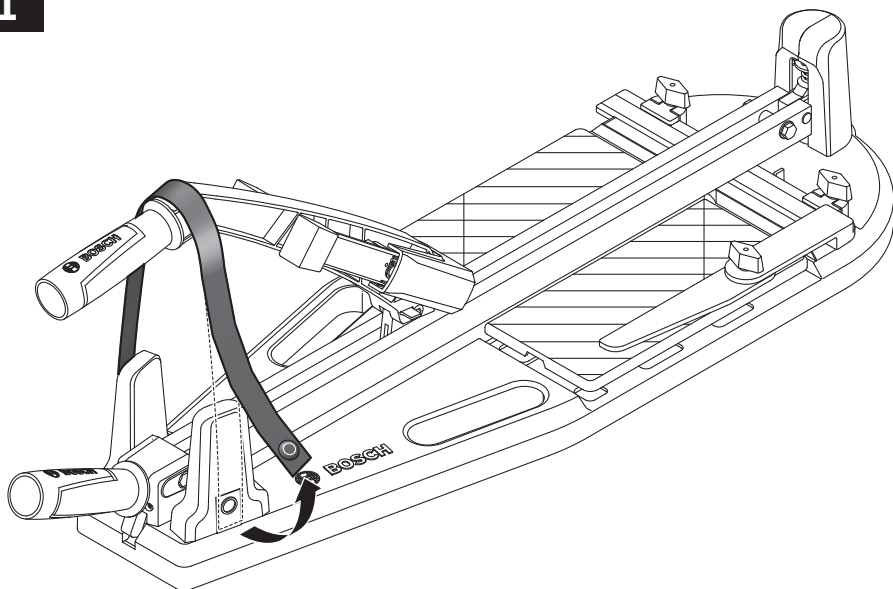

2

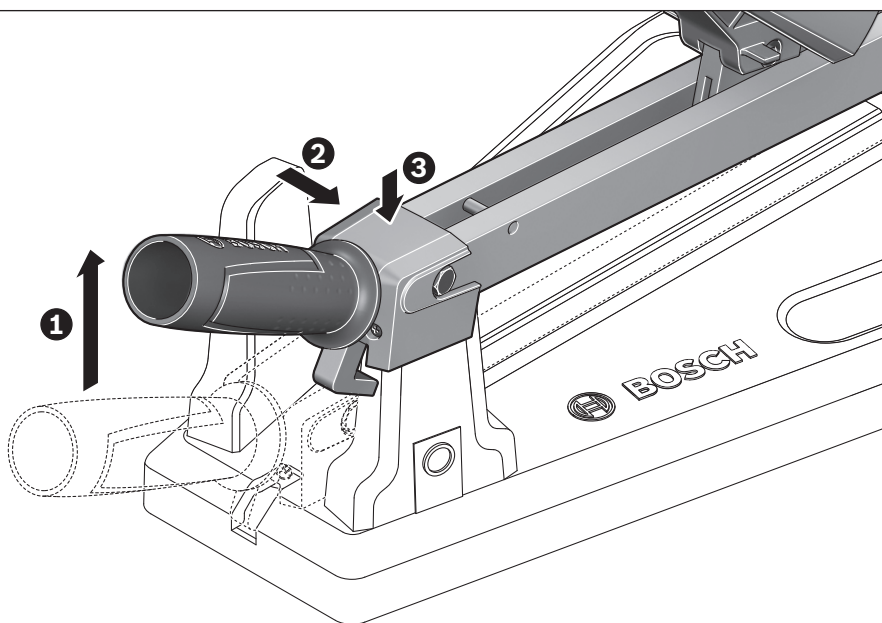

3a

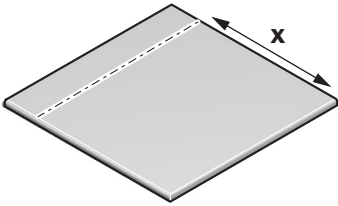

3b

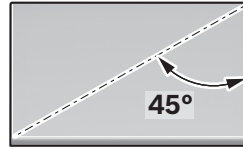

4a

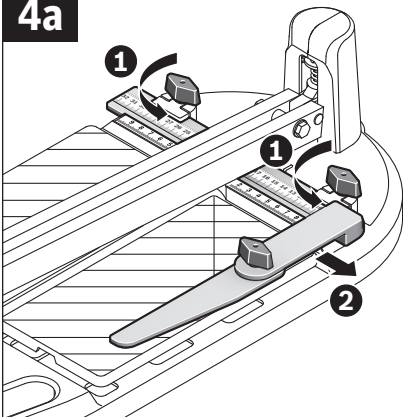

4b

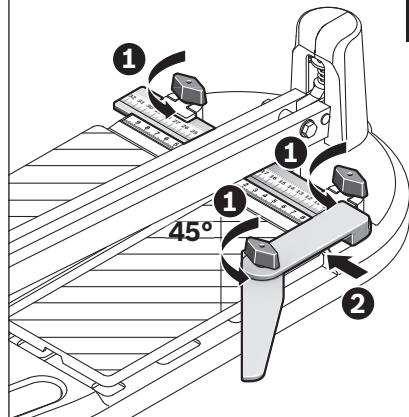

5a

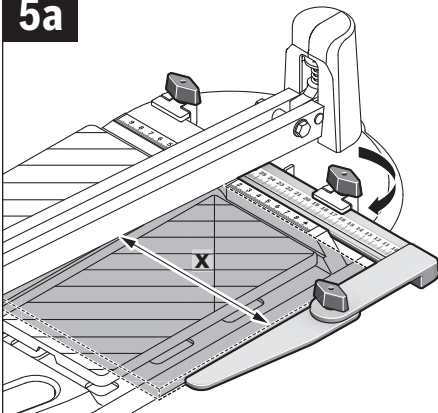

5b

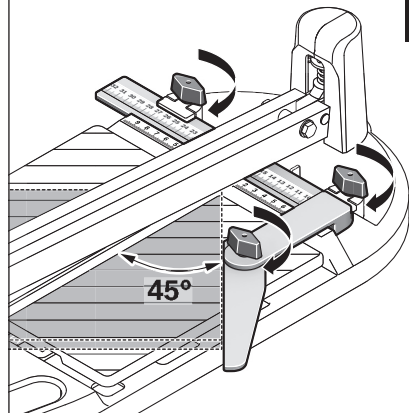

6

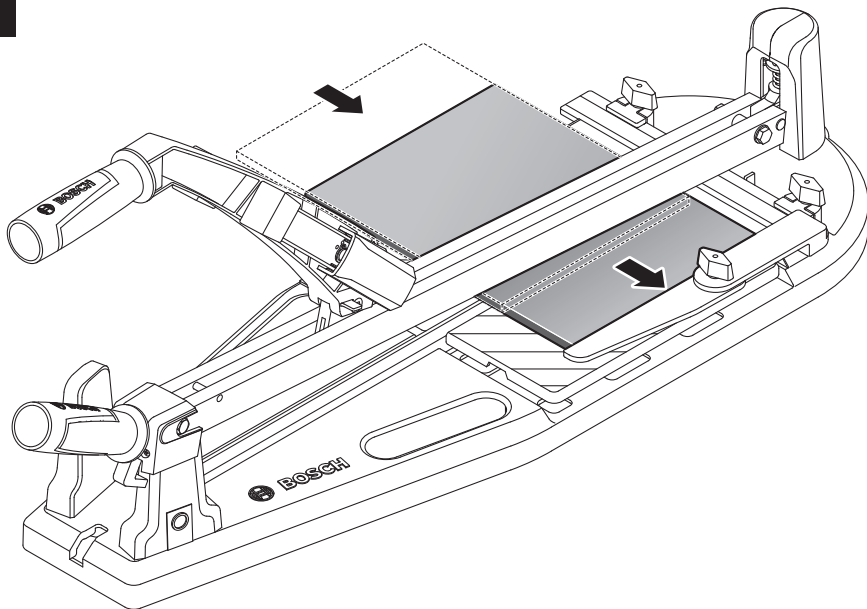

7

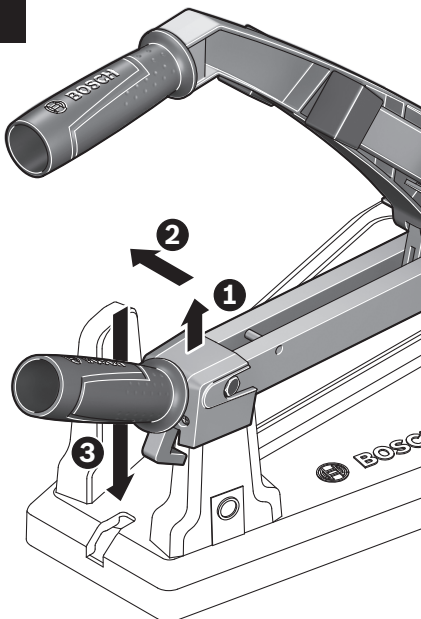

8

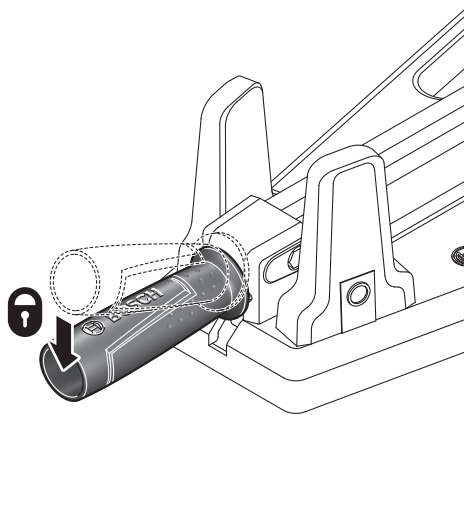

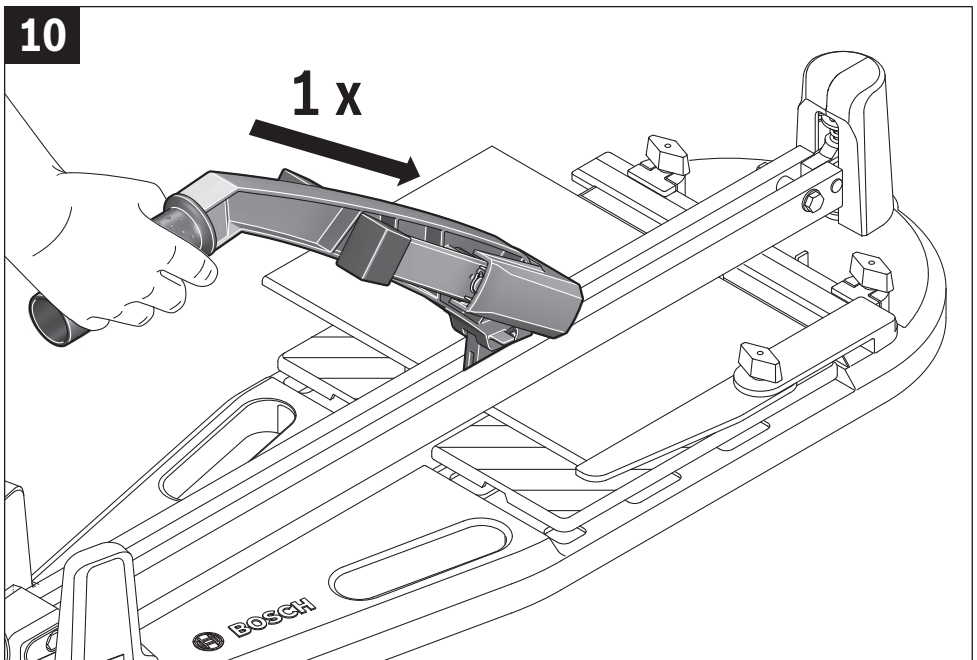
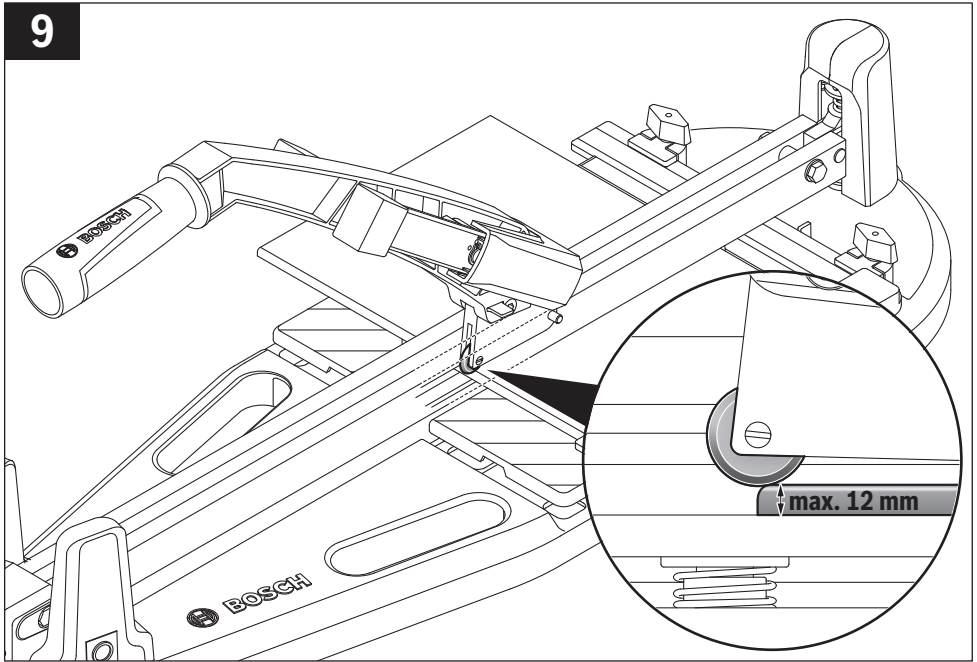

11a

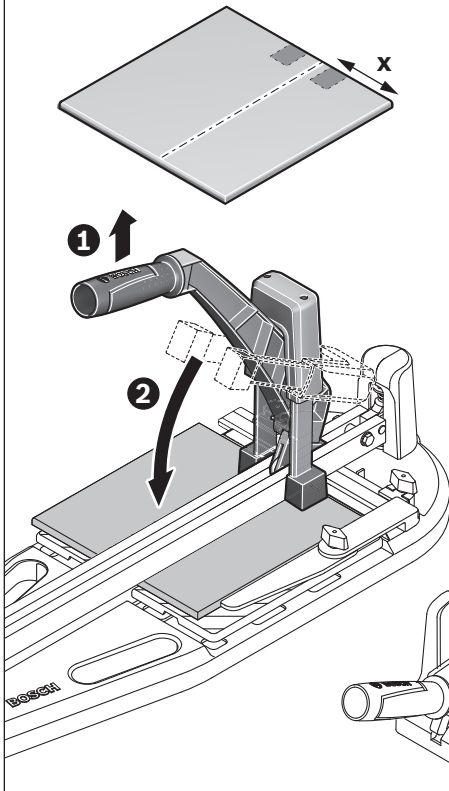

11b

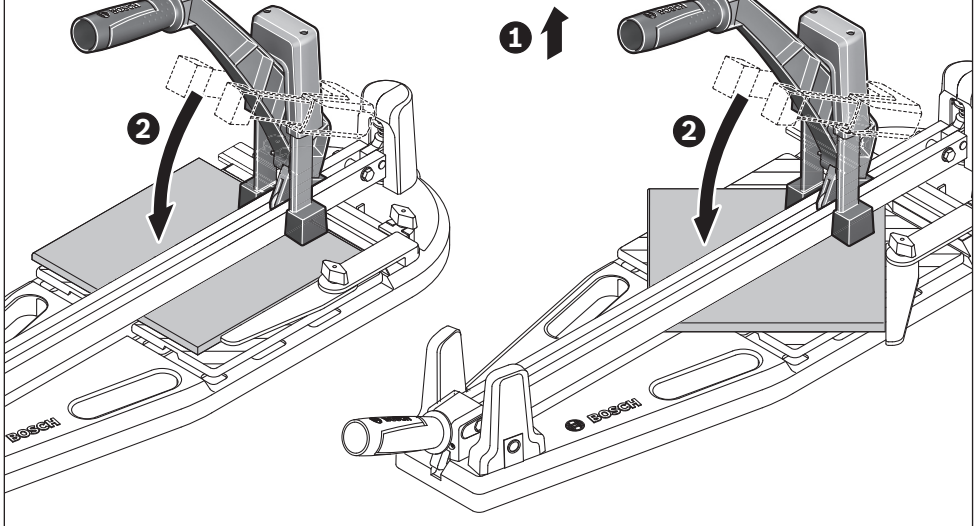
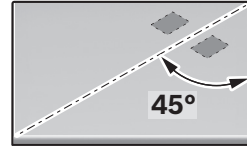

12

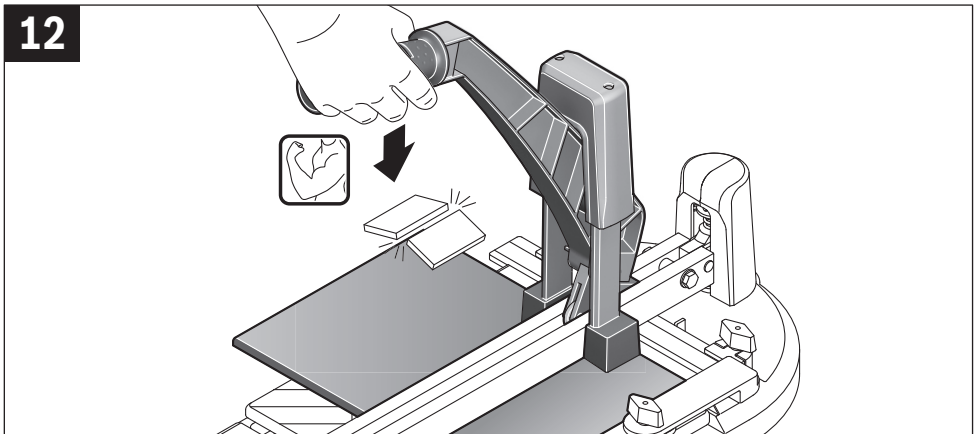

13

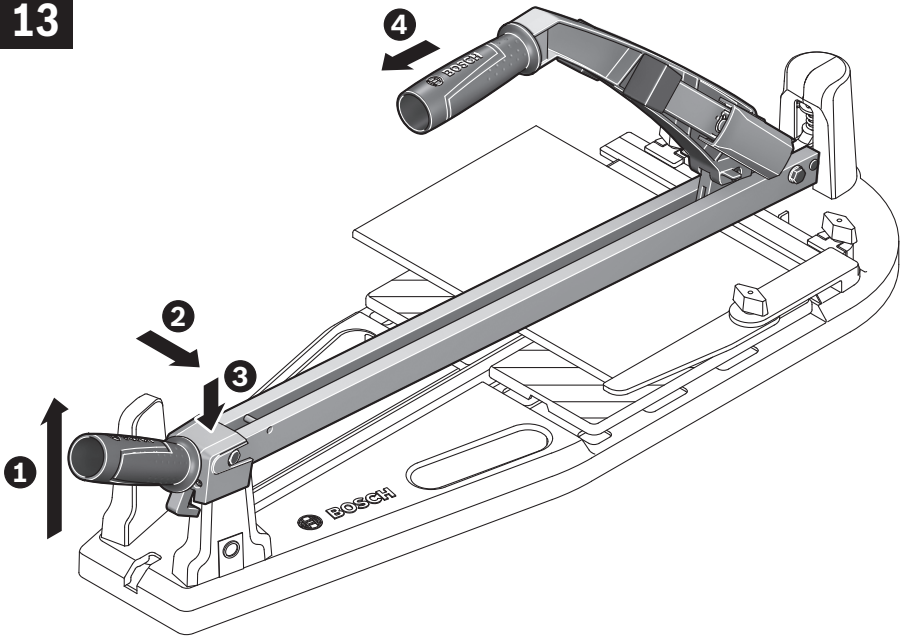

14

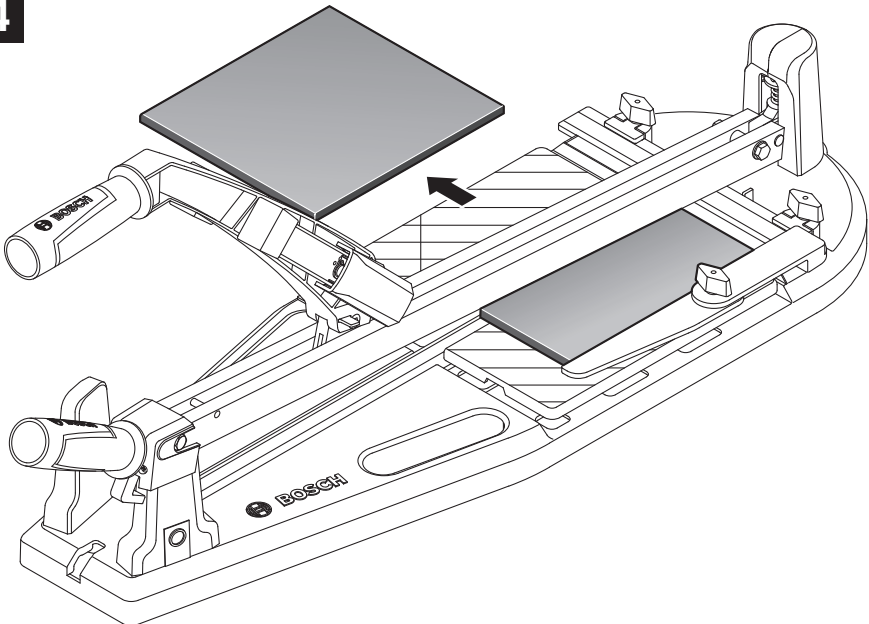



15

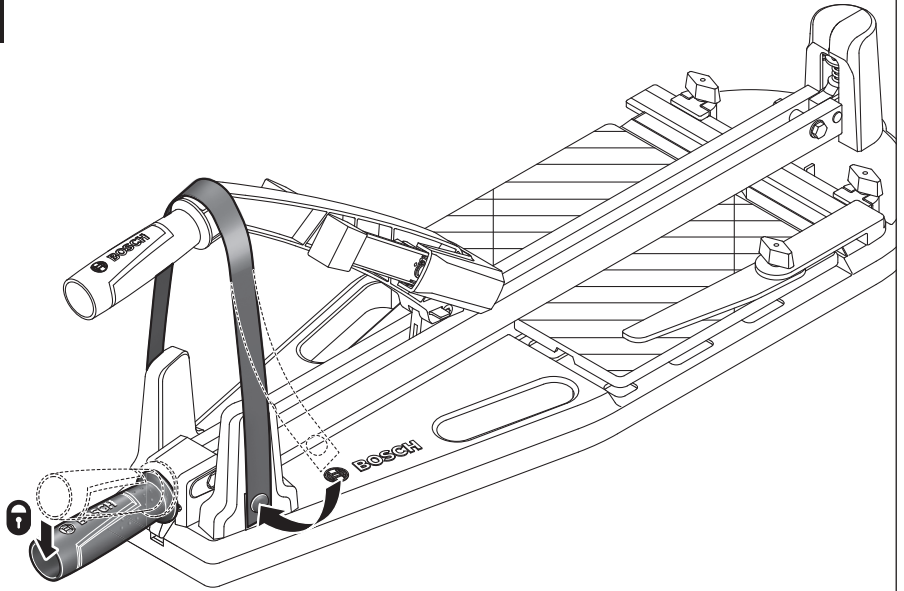

16

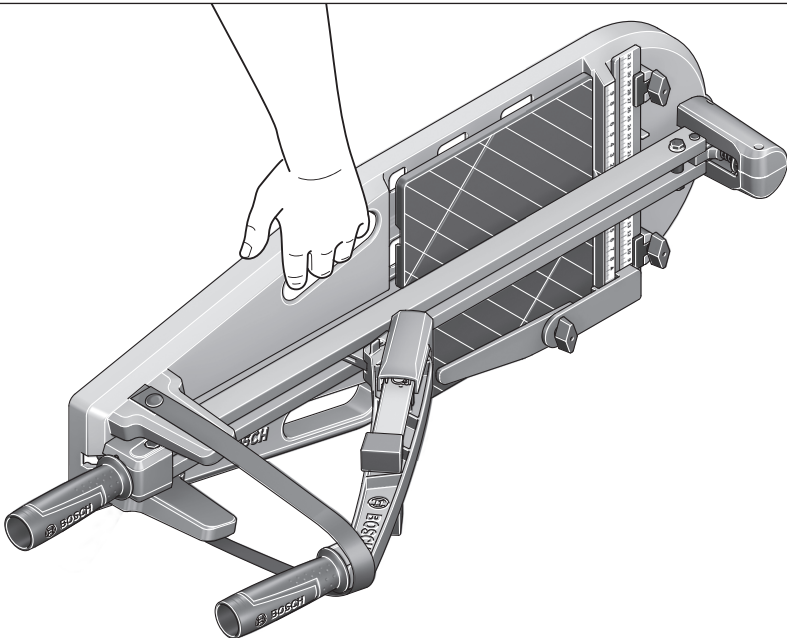

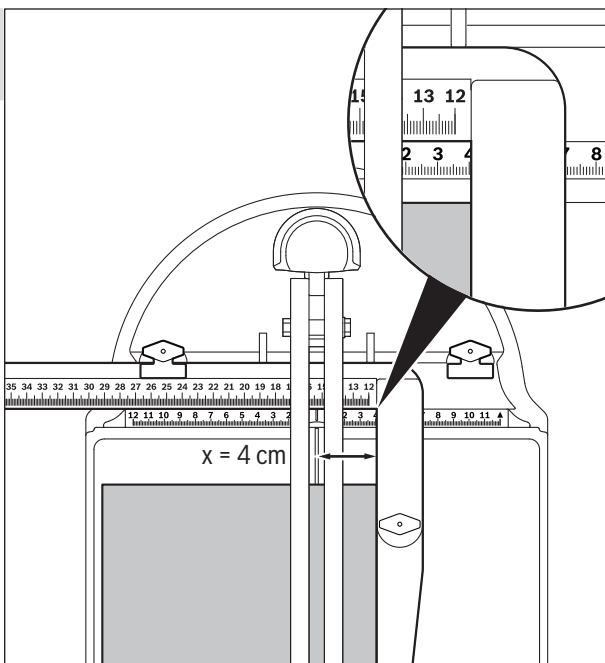
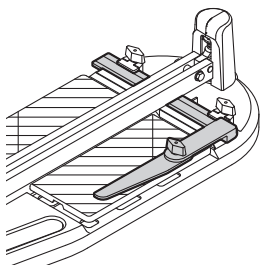
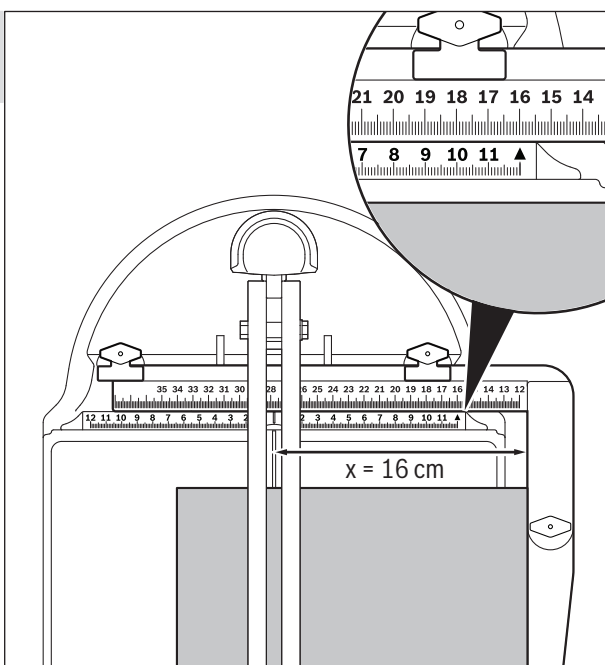
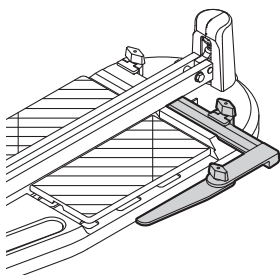
**A****B**

## C

## PTC 640

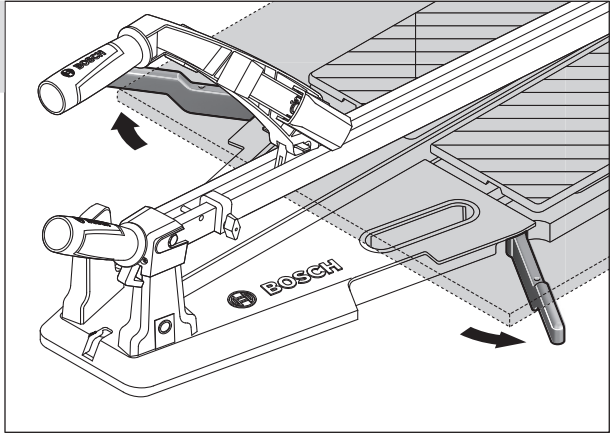
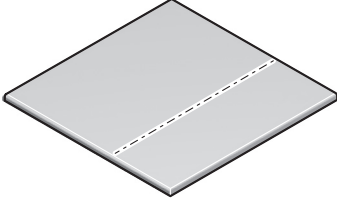

## D

## PTC 640

de Serienschnitt  
 en Serial cut  
 fr Coupe en série  
 es Corte en serie  
 pt Corte em série  
 it Taglio in serie  
 nl Seriesnede  
 da Seriesnit  
 sv Serieskärning  
 no Seriekutt  
 fi Sarjaleikkuu  
 el Κοπή σειράς  
 tr Seri kesme  
 pl Cięcia seryjne  
 cs Sériové řezání  
 sk Sériové rezanie

hu Sorozatos vágás  
 ru Серийный разрез  
 uk Серійне різання  
 kk Сериялық кесік  
 ro Tăieri în serie  
 bg Рязане в серия  
 mk Сериски резови  
 sr Serijski rez  
 sl Serijsko rezanje  
 hr Serijski rez  
 et Seeriaviisiline lõikamine  
 lv Sērijveida griešana  
 lt Serijinis pjovimas  
 ar القطع القياسي

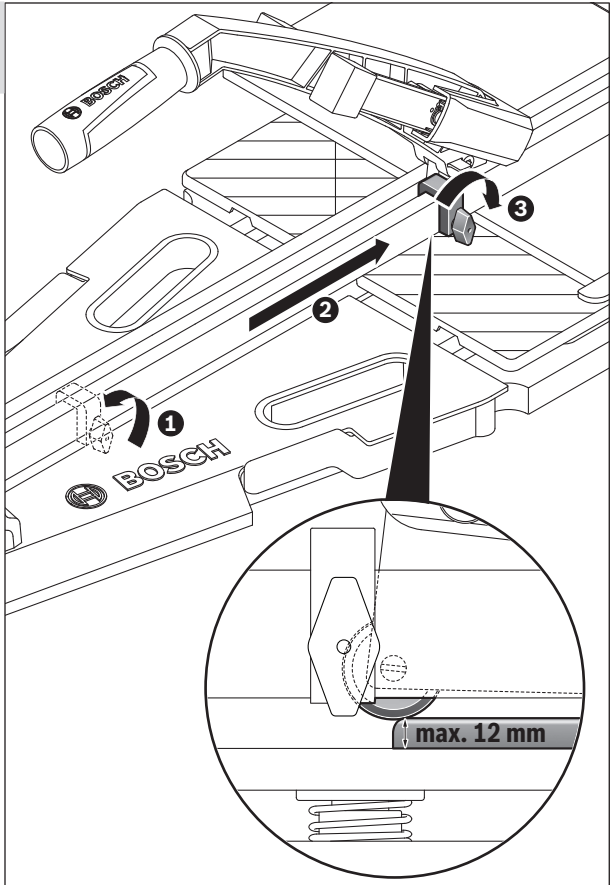
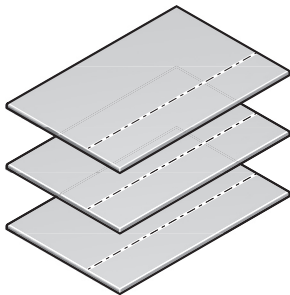

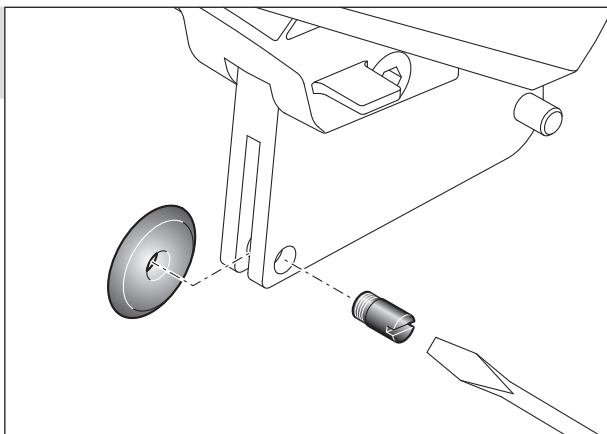
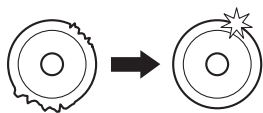
**E**

| Problem  | Ursache  | Abhilfe  | siehe Grafik |
|--|--|--|--------------|
| Fliese bricht nicht entlang der Schnittlinie             | Anpressdruck beim Ritzen der Fliese zu gering (z.B. bei „harten“ Fliesen wie Feinsteinzeug, Bodenfliesen oder frostsicheren Fliesen) | Beim Ritzen mehr Druck auf den Ritz- und Brechhebel <b>1</b> ausüben         |              |
|  | Führungsschiene <b>4</b> nicht arretiert   | Feststellhebel <b>10</b> zum Arretieren nach unten drücken                   | <b>8</b>     |
|  | Schneiderad <b>3</b> stumpf  | Schneiderad <b>3</b> auswechseln   | <b>E</b>     |
| Fliese bricht falsch bei parallelem Schnitt              | Brechstempel <b>2</b> nicht am Ende der Fliese aufgesetzt  | Brechstempel <b>2</b> ganz am Ende der Fliese aufsetzen                      | <b>11a</b>   |
| Fliese bricht falsch bei diagonalem Schnitt              | Brechstempel <b>2</b> am Ende der Fliese aufgesetzt  | Brechstempel <b>2</b> ein Stück vor den Linealen/Anschlag <b>5</b> aufsetzen | <b>11b</b>   |
| Fliese liegt nicht stabil auf der Auflagefläche <b>6</b> | Fliese ist breiter als die Auflagefläche <b>6</b>  | PTC 640:<br>Auflageverbreiterungen <b>11</b> ausklappen                      | <b>C</b>     |
| Schneiderad <b>3</b> hakt/ruckelt beim Ritzen            | Anpressdruck beim Ritzen der Fliese zu hoch  | Beim Ritzen weniger Druck auf den Ritz- und Brechhebel <b>1</b> ausüben      |              |

## Wartung und Service

Geben Sie bei allen Rückfragen und Ersatzteilbestellungen bitte unbedingt die 10-stellige Sachnummer laut Typenschild des Fliesenschneiders an.

### Kundendienst und Anwendungsberatung

Der Kundendienst beantwortet Ihre Fragen zu Reparatur und Wartung Ihres Produkts sowie zu Ersatzteilen. Explosionszeichnungen und Informationen zu Ersatzteilen finden Sie auch unter:

**www.bosch-pt.com**

Das Bosch-Anwendungsberatungs-Team hilft Ihnen gerne bei Fragen zu unseren Produkten und deren Zubehör.

**www.bosch-do-it.de**, das Internetportal für Heimwerker und Gartenfreunde.

**www.1-2-do.com**

In der Heimwerker-Community 1-2-do.com können Sie Produkttester werden, Ideen sammeln oder sich mit anderen Heimwerkern austauschen.

**www.dha.de**, das komplette Service-Angebot der Deutschen Heimwerker Akademie.

### Deutschland

Robert Bosch GmbH

Servicezentrum Elektrowerkzeuge

Zur Luhne 2

37589 Kalefeld – Willershäusen

Unter [www.bosch-pt.de](http://www.bosch-pt.de) können Sie online Ersatzteile bestellen oder Reparaturen anmelden.

Kundendienst: Tel.: (0711) 40040480

Fax: (0711) 40040481

E-Mail: [Servicezentrum.Elektrowerkzeuge@de.bosch.com](mailto:Servicezentrum.Elektrowerkzeuge@de.bosch.com)

Anwendungsberatung: Tel.: (0711) 40040480

Fax: (0711) 40040482

E-Mail: [Anwendungsberatung.pt@de.bosch.com](mailto:Anwendungsberatung.pt@de.bosch.com)

### Österreich

Unter [www.bosch-pt.at](http://www.bosch-pt.at) können Sie online Ersatzteile bestellen.

Tel.: (01) 797222010

Fax: (01) 797222011

E-Mail: [service.elektrowerkzeuge@at.bosch.com](mailto:service.elektrowerkzeuge@at.bosch.com)

### Schweiz

Unter [www.bosch-pt.com/ch/de](http://www.bosch-pt.com/ch/de) können Sie online Ersatzteile bestellen.

Tel.: (044) 8471511

Fax: (044) 8471551

E-Mail: [AfterSales.Service@de.bosch.com](mailto:AfterSales.Service@de.bosch.com)

### Luxemburg

Tel.: +32 2 588 0589

Fax: +32 2 588 0595

E-Mail: [outillage.gereedschap@be.bosch.com](mailto:outillage.gereedschap@be.bosch.com)

### Entsorgung

Fliesenschneider, Zubehör und Verpackungen sollen einer umweltgerechten Wiederverwertung zugeführt werden.

**Änderungen vorbehalten.**

## English

### Safety Notes

#### General Safety Rules



**Read all safety warnings and all instructions enclosed with the tile cutter.** Failure to comply with the safety warnings and instructions can cause severe injury.

**Save these instructions.**

## Safety Warnings for Tile Cutters

- ▶ **Use the tile cutter only for cutting the materials listed under Intended Use.** Marble or granite as well as tiles with a rough surface structure and natural stone tiles cannot be cut.
- ▶ **Keep your fingers clear of the movable parts of the tile cutter.** Danger of fingers being crushed or contused and considerably injured.
- ▶ **Wear protective gloves when cutting tiles.** Sharp edges develop on broken tiles and can cause injuries to the operator.
- ▶ **When transporting the tile cutter, use only the handles, tighten all loose components (fences, rulers), press down the locking lever to lock the guide rail, and fix the transport safety-lock (see figures 15 and 16).** There is a risk of injury if it falls down.

- 1 Scoring and breaking lever
- 2 Breaking stamp
- 3 Cutting wheel
- 4 Guide rail
- 5 Rulers/Fence
- 6 Supporting surface
- 7 Carrying handle
- 8 Base plate
- 9 Transport safety-lock
- 10 Locking lever
- 11 Support extension (PTC 640)
- 12 Stop for serial cut (PTC 640)

**Accessories shown or described are not part of the standard delivery scope of the product. A complete overview of accessories can be found in our accessories program.**

## Technical Data

| Tile cutter                                |    | PTC 470 | PTC 640 |
|--|----|---------|---------|
| Article number                             |    | ... 3.. | ... 4.. |
| 3 603 M04 ...                              |    |         |         |
| Max. cutting height                        | mm | 12      | 12      |
| Max. cutting length of rip cuts            | mm | 470     | 640     |
| Mitre/Bevel Angle                          |    |         |         |
| Horizontal                                 | °  | 0–45    | 0–45    |
| Weight according to EPTA-Procedure 01/2003 | kg | 7,4     | 9,1     |

## Product Description and Specifications

### Intended Use

The tile cutter is intended for cutting ceramic tiles.

### Product Features

The numbering of the product features refers to the illustrations on the graphics pages.

## Practical Advice

| Problem   | Cause  | Corrective Measure  | See graphic |
|---|--|---|-------------|
| Tile does not break cleanly                         | Too much pressure applied when scoring the tile (e.g. on "soft" tiles such as wall tiles or glazed tiles)                        | Apply less pressure to the scoring and breaking lever <b>1</b> when scoring |             |
|   | There is tile debris under the spring-mounted supporting surface <b>6</b>  | Remove tile debris  |             |
| Tile already breaks when scoring                    | Too much pressure applied when scoring the tile (e.g. on "soft" tiles such as wall tiles or glazed tiles)                        | Apply less pressure to the scoring and breaking lever <b>1</b> when scoring |             |
| Tile does not break along the cutting line          | Not enough pressure applied when scoring the tile (e.g. on "hard" tiles such as fine stoneware, floor tiles or frostproof tiles) | Apply more pressure to the scoring and breaking lever <b>1</b> when scoring |             |
|   | Guide rail <b>4</b> not locked   | Press down the locking lever <b>10</b> to lock it                           | <b>8</b>    |
|   | Cutting wheel <b>3</b> blunt   | Replace cutting wheel <b>3</b>  | <b>E</b>    |
| Tile breaks incorrectly when making a parallel cut  | Breaking stamps <b>2</b> not applied at the end of the tile  | Apply breaking stamps <b>2</b> right at the end of the tile                 | <b>11a</b>  |
| Tile breaks incorrectly when making a diagonal cut  | Breaking stamps <b>2</b> applied at the end of the tile  | Apply breaking stamps <b>2</b> slightly ahead of the rulers/fence <b>5</b>  | <b>11b</b>  |
| Tile not stable on the supporting surface <b>6</b>  | Tile is wider than the supporting surface <b>6</b>   | PTC 640:<br>Fold out the support extensions <b>11</b>                       | <b>C</b>    |
| Cutting wheel <b>3</b> snags/judders during scoring | Too much pressure applied when scoring the tile  | Apply less pressure to the scoring and breaking lever <b>1</b> when scoring |             |

## Maintenance and Service

In all correspondence and spare parts orders, please always include the 10-digit article number given on the type plate of the tile cutter.

### After-sales Service and Application Service

Our after-sales service responds to your questions concerning maintenance and repair of your product as well as spare parts. Exploded views and information on spare parts can also be found under:

**www.bosch-pt.com**

Bosch's application service team will gladly answer questions concerning our products and their accessories.

#### Great Britain

Robert Bosch Ltd. (B.S.C.)  
P.O. Box 98  
Broadwater Park  
North Orbital Road  
Denham  
Uxbridge  
UB 9 5HJ

At [www.bosch-pt.co.uk](http://www.bosch-pt.co.uk) you can order spare parts or arrange the collection of a product in need of servicing or repair.

Tel. Service: (0844) 7360109

E-Mail: [boschservicecentre@bosch.com](mailto:boschservicecentre@bosch.com)

#### Ireland

Origo Ltd.  
Unit 23 Magna Drive  
Magna Business Park  
City West  
Dublin 24  
Tel. Service: (01) 4666700  
Fax: (01) 4666888

#### Australia, New Zealand and Pacific Islands

Robert Bosch Australia Pty. Ltd.  
Power Tools  
Locked Bag 66  
Clayton South VIC 3169  
Customer Contact Center  
Inside Australia:  
Phone: (01300) 307044  
Fax: (01300) 307045  
Inside New Zealand:  
Phone: (0800) 543353  
Fax: (0800) 428570  
Outside AU and NZ:  
Phone: +61 3 95415555  
[www.bosch.com.au](http://www.bosch.com.au)

#### Republic of South Africa

**Customer service**  
Hotline: (011) 6519600

#### Gauteng – BSC Service Centre

35 Roper Street, New Centre  
Johannesburg  
Tel.: (011) 4939375  
Fax: (011) 4930126  
E-Mail: [bsctools@icon.co.za](mailto:bsctools@icon.co.za)

#### KZN – BSC Service Centre

Unit E, Almar Centre  
143 Crompton Street  
Pinetown  
Tel.: (031) 7012120  
Fax: (031) 7012446  
E-Mail: [bsc.dur@za.bosch.com](mailto:bsc.dur@za.bosch.com)

#### Western Cape – BSC Service Centre

Democracy Way, Prosperity Park  
Milnerton  
Tel.: (021) 5512577  
Fax: (021) 5513223  
E-Mail: [bsc@zsd.co.za](mailto:bsc@zsd.co.za)

#### Bosch Headquarters

Midrand, Gauteng  
Tel.: (011) 6519600  
Fax: (011) 6519880  
E-Mail: [rbsa-hq.pts@za.bosch.com](mailto:rbsa-hq.pts@za.bosch.com)

### Disposal

The tile cutter, accessories and packaging should be sorted for environmental-friendly recycling.

**Subject to change without notice.**

## Français

### Avertissements de sécurité

#### Indications générales de sécurité



**Veillez lire toutes les instructions et les consignes de sécurité livrées avec l'outil coupe carrelage.** Le non-respect des instructions et des consignes de sécurité peut provoquer de graves blessures.

**Garder précieusement ces instructions.**

#### Avertissements de sécurité pour scies à carrelage

- ▶ **N'utilisez la scie à carrelage que pour la coupe des matériaux indiqués dans le chapitre utilisation conforme.** Le marbre ou le granit ainsi que les carreaux présentant une surface rugueuse et les carreaux en pierre naturelle ne peuvent pas être coupés.
- ▶ **Ne posez pas vos doigts entre les parties en mouvement de l'outil coupe carrelage.** Vous pourriez vous coincer les doigts et être gravement blessé.