

IRWIN®

Merchandising Solutions

IRWIN provides you merchandising solutions that help you to maximise your sell through on your wall and we also give you the opportunity to gain additional sales by placing permanent secondary placements in your store.

The newly designed **Clamp Hook** allows you to merchandise any IRWIN bar clamp in a structured and clean way. To help the user to make the right choice during the purchase we have added the new user guiding system that explains which clamp should be used for which application. There are two different hooks, one can hold any IRWIN Quick-Grip® one handed bar clamp (10506376) and the second hook (10506375) is designed to merchandise any IRWIN Record Pro-Clamp.

The IRWIN **Clamping Tower** (DS0070000IR) is a universal metal merchandiser that can be, because of its triangular shape, equipped from all three sides with any IRWIN bar clamp.

The **Quick-Clamping Center** (DS0020800QU) is a permanent wooden merchandiser developed to display the IRWIN Quick-Grip® resin clamping family. Seven hooks can be individually attached to the wooden unit to hold any IRWIN Quick-Grip® one handed bar clamp. There is also space on the bottom of the merchandiser which allows you to put two shipper boxes of IRWIN Quick-Grip® Handi-Clamps™ on it.



Clamp Hook with Info Board for Quick-Grip® one handed bar clamps 10506376

Clamp Hook with Info Board for IRWIN Record Pro-Clamps 10506375

IRWIN Quick-Grip® Quick-Clamping Center DS0020800QU

IRWIN Clamping Tower DS0070000IR

CLAMPING MERCHANDISER SOLUTIONS

SKU	Description	Packaging Unit contains	Dimensions
10506375	Merchandising Hook with Info Board for IRWIN Pro-Clamps	6 hooks and 6 Info-Board Stickers	41x22x16 cm
10506376	Merchandising Hook with Info Board for IRWIN One Handed Bar Clamps	6 hooks and 6 Info-Board Stickers	41x22x23 cm
DS0020800QU	Secondary Merchandiser IRWIN One Handed Bar Clamps	Wooden Merchandiser and 7 hooks	75x36x145 cm
DS0070000IR	Clamping Tower IRWIN	Tower and 8 large and 4 small hooks	148,5x34,5 cm Foot Ø 58 cm

©2006
IRWIN
Industrial Tools

UK & Middle East, Africa, Asia
IRWIN Industrial Tool Company Ltd.
Parkway Works, Kettlebridge Road
Sheffield S9 3BL - England
Tel: +44 (0)114 244 90 66
Fax: +44 (0)114 256 17 88
www.irwin.co.uk

IRWIN®

Clamps and Vices



IRWIN®



TRUSTED BY PROFESSIONALS™

IRWIN®

QUICK-GRIP®

One Handed Bar Clamp Family

17 years ago we revolutionised the clamping industry by developing the first one handed bar clamp under the Quick-Grip® brand. Now we have done it again with Quick-Grip® XP. The world's first one handed bar clamp, with five patents pending, specifically designed for gluing applications.

The clamp offers "Xtreme Pressure" which is two and a half times greater than all of its competitors.

But also the well loved features of the original Quick-Grip® Quick-Change™ have been retained.

To give consistency we have also brought the whole Quick-Clamping range under the IRWIN® umbrella, maintaining the Quick-Grip® sub-brand.

Through differentiation on the Packaging and the Point Of Sale, we help the user to choose the right clamp for the right application. This will happen by implementing a clear good – better – best range architecture, using Bronze / Silver / Gold medals that state the average clamping force of the product.



IRWIN®

QUICK-GRIP® XP

Maximum Gripping Strength with One Hand



INCREASED CLAMPING DEPTH OF 95 mm vs. 75 mm of current Quick-Change™



QUICK-CHANGE™ SPREADER FUNCTION, no tool required



NERM = Non Explosive Release Mechanism

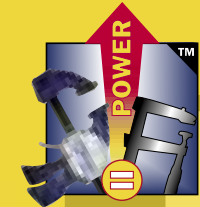

UP TO THREE TIMES MORE CLAMPING FORCE than other One Handed Bar Clamps

Clamp Cycle Performance Test:

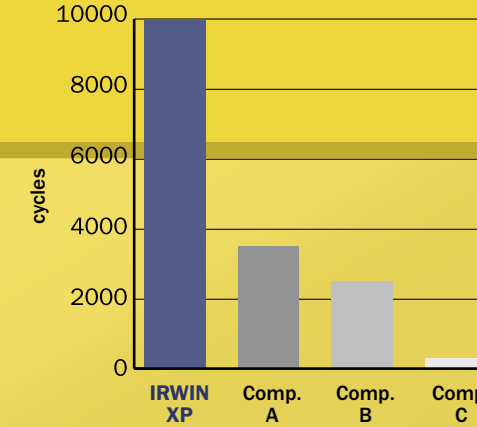

Clamps have been tested under equal conditions: Repeated load applied on force trigger mechanism with defined input force of 660N until Clamping force is reached (according to samples clamping force capabilities). After test sample holds clamping force for 1.5 seconds, the clamping force is released. Cycle number is equal to test samples reliability to reach the respective clamping force under testing conditions.

One Handed Bar Clamp Hold Load comparison, IRWIN Quick-Grip® XP vs. three competitors

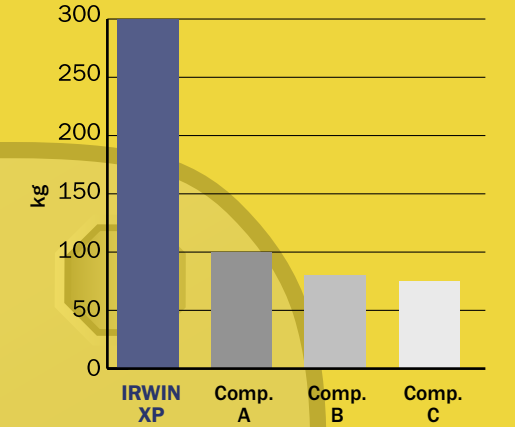

Clamps have been tested under equal conditions: a) Input force 660N (i.e.: When applying 660N on force trigger IRWIN Quick-Grip® XP generates 3000N clamping force) b) Clamping force is measured after 5 sec. with no input force on force trigger c) Clamping force is average of three measurements

FREE SLIDING I-BEAM BAR



QUICK-GRIP® XP ONE HANDED BAR CLAMP, CLAMPING DEPTH 95mm

SKU	Clamping range	Spreading range
10505942	6" / 150mm	216 - 420mm
10505943	12" / 300mm	216 - 570mm
10505944	18" / 450mm	216 - 720mm
10505945	24" / 600mm	216 - 870mm
10505946	36" / 900mm	216 - 1170mm
10505947	50" / 1250mm	216 - 1520mm

IRWIN®

QUICK-GRIP®

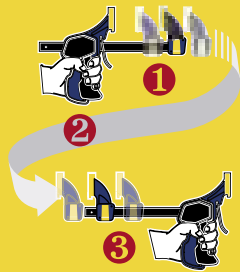

▶ QUICK-GRIP® QUICK-CHANGE™ ONE HANDED BAR CLAMP AND SPREADER IN SIX SIZES, CLAMPING DEPTH 84mm

SKU	Clamping range	Spreading range
T506QCEL7	6" / 150mm	195 - 360mm
T512QCEL7	12" / 300mm	195 - 515mm
T518QCEL7	18" / 455mm	195 - 665mm
T524QCEL7	24" / 605mm	195 - 820mm
T536QCEL7	36" / 910mm	195 - 970mm
T550QCEL7	50" / 1265mm	195 - 1125mm
T40150QC	Quick-Change™ Pads, pair	



▶ QUICK-GRIP® MINI ONE HANDED BAR CLAMP WITH STAY-ON PADS, CLAMPING DEPTH 55mm

SKU	Clamping range	Description
T546EL7	6" / 150mm	For smaller jobs and applications in tight areas. Non-marring, stay-on pads protect workpiece finish.
T5462EL7	6" / 150mm, pair	
T5412EL7	12" / 300mm	
T54122EL7	12" / 300mm, pair	

WOODWORKING

IRWIN®

QUICK-GRIP®

Micro

Perfect Size for hobby and craft applications. Converts to a spreader by reversing the clamp pads.



▶ QUICK-GRIP® MICRO ONE HANDED BAR CLAMP AND SPREADER, CLAMPING DEPTH 30mm

SKU	Clamping range
T53006EL7	4" / 115mm
T530062EL7	4" / 115mm, pair

Handi-Clamp™

Patented ratcheting mechanism provides variable clamping pressure. Quick-Release trigger allows for fast and easy positioning and release. The ideal clamp for jobs in workshop, house and garden. Specially designed jaws hold odd-shaped workpieces.



▶ QUICK-GRIP® HANDI-CLAMP™

SKU	Description
T59100ECD	Handi-Clamp™ 1 1/2" / 38mm, 20 pcs.
T59150ECD	Handi-Clamp™ 1 1/2" / 38mm, bulk pack 50 pcs.
T59200ECD	Handi-Clamp™ 2" / 50mm, 12 pcs.
T59250ECD	Handi-Clamp™ 2" / 50mm, bulk pack 50 pcs.
T59400ECD	Handi-Clamp™ 4" / 100mm, 12 pcs.
T59430ECD	Handi-Clamp™ 4" / 100mm, bulk pack 30 pcs.

WOODWORKING

IRWIN®

Record®

WOODWORKING

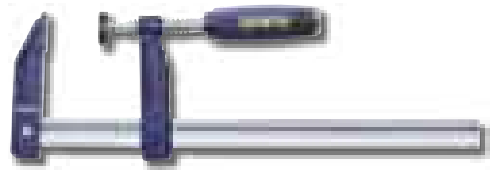

PRO CLAMPS S – CLAMPING DEPTH 80mm, BAR DIMENSION 25x6mm, AVERAGE CLAMPING FORCE 350kg

SKU	Product Description	Clamping Capacity
10503564	Pro-Clamp S200	200mm / 8"
10503565	Pro-Clamp S300	300mm / 12"
10503566	Pro-Clamp S400	400mm / 16"
10503567	Pro-Clamp S600	600mm / 24"
10503568	Pro-Clamp S800	800mm / 32"



PRO CLAMPS M – CLAMPING DEPTH 120mm, BAR DIMENSION 30x8mm, AVERAGE CLAMPING FORCE 450kg

SKU	Product Description	Clamping Capacity
10503569	Pro-Clamp M300	300mm / 12"
10503570	Pro-Clamp M400	400mm / 16"
10503571	Pro-Clamp M600	600mm / 24"
10503572	Pro-Clamp M800	800mm / 32"
10503573	Pro-Clamp M1000	1000mm / 40"

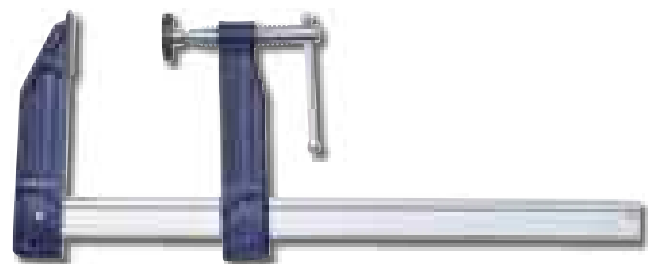

PRO CLAMPS L WITH TOMMY-BAR – CLAMPING DEPTH 140mm, BAR DIMENSION 35x9mm, AVERAGE CLAMPING FORCE 700kg

SKU	Product Description	Clamping Capacity
10503574	Pro-Clamp L400	400mm / 16"
10503575	Pro-Clamp L600	600mm / 24"
10503576	Pro-Clamp L800	800mm / 32"
10503577	Pro-Clamp L1000	1000mm / 40"
10503578	Pro-Clamp L1250	1250mm / 50"
10503579	Pro-Clamp L1500	1500mm / 60"

IRWIN®

Record®

Pro Clamp

WOODWORKING



TPE pads - snap fit to prevent loss. Provides excellent friction to the work surface; reduces marking of work piece.

Three component handle for higher torque transfer than wood, plus added comfort for the user (Small & Medium Range; Large Range with Tommy-bar).



I-beam / ribbed design, providing higher mechanical strength and less torsion.

Investment casting for higher strength.

Soft hexed handle for better ergonomics.

Zinc plated I-beam bar prevents rust and improves appearance.

Heads designed with flat feet so that clamp can stand horizontally and vertically.

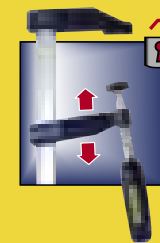

Patented floating lock needs less user intervention and eliminates slippage.

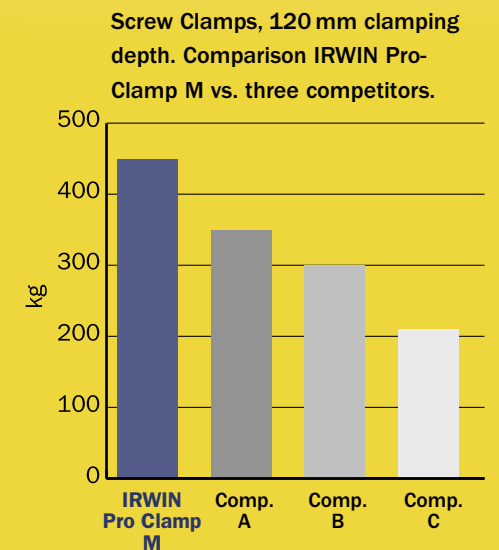

Tested by a German independent test laboratory. December 2004.

IRWIN®

Record®

Sash Clamp

The slide and head are guaranteed unbreakable and the slide is secured by a solid steel pin passing through one of the locating holes spaced along the steel bar.

The steel mainscrew applies pressure quickly and smoothly through a fast acting, hard wearing rolled thread. Slides and heads are flat bottomed so that the clamp will stand without support.

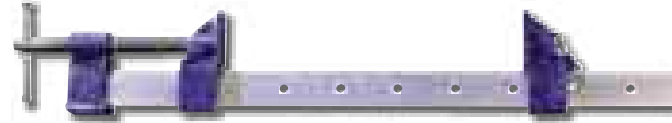

WOODWORKING

SASH CLAMPS – BAR DIMENSIONS 32x6mm, AVERAGE CLAMPING FORCE 500kg

SKU	Product Description	Clamping Capacity
T135/2	Sash Clamp 24"	600mm / 24"
T135/3	Sash Clamp 30"	750mm / 30"
T135/4	Sash Clamp 36"	900mm / 36"
T135/5	Sash Clamp 42"	1050mm / 42"
T135/6	Sash Clamp 48"	1200mm / 48"
T135/7	Sash Clamp 54"	1350mm / 54"
T135/9	Sash Clamp 66"	1650mm / 66"
TL135/4	Lengthening Bar 36"	900mm / 36"

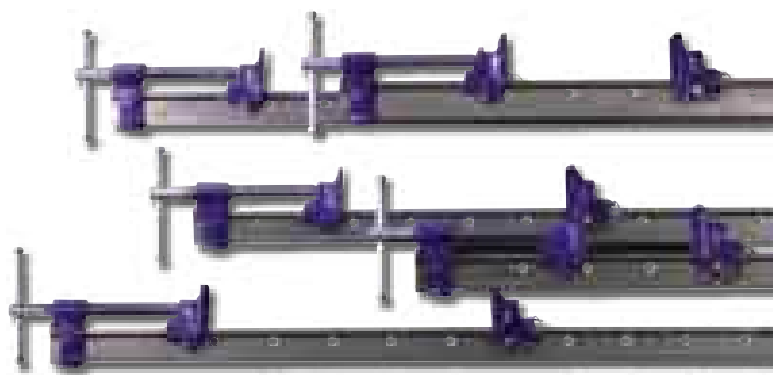

T-BAR CLAMPS – AVERAGE CLAMPING FORCE 1000kg

SKU	Product Description	Clamping Capacity
T136/5	T-Bar Clamp 42"	1050mm / 42"
T136/6	T-Bar Clamp 48"	1200mm / 48"
T136/7	T-Bar Clamp 54"	1350mm / 54"
T136/9	T-Bar Clamp 66"	1650mm / 66"
T136/11	T-Bar Clamp 78"	1950mm / 78"
TL136/6	Lengthening Bar 48"	1200mm / 48"

T-Bar Clamp

The T-Bar clamps are similar to the Sash Clamps, however they feature a very rigid 'T' section steel bar. These clamps resist twisting and distortion under high clamping pressures. The fixed head is furnished with drilled feet for bench mounting.

Clamp Heads

The cast grey iron head and slide with steel mainscrew can be fitted to a wooden batten 25mm thick by 38mm wide, and of any desired length. The timber is then drilled with two 11.1mm diameter holes producing a light duty bar clamp as strong and true as the timber you choose.

CLAMP HEADS

SKU	Product Description
TM130	Clamp Head

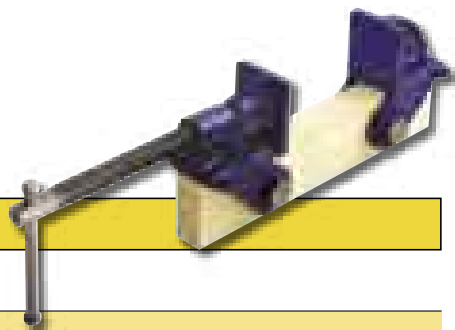

IRWIN®

Record®

Medium Duty G-Clamp 119

The range of G-Clamps is suitable for medium duty work. These clamps have an unusually thin frame for getting into tight corners and confined spaces, and because the frame is made from drop-forged steel, they are also very strong and rigid.

Heavy Duty G-Clamp 120

For both metal and woodworking applications, the IRWIN Record 120 is the most popular and widely used G-Clamp. The strong frame, manufactured from S.G. Ductile iron, is guaranteed unbreakable, and there is an additional safety feature of a 'fused' handle which will bend before the frame can be overstressed. The mainscrew is fitted with a steel swivel shoe to apply an even pressure on angled surfaces.

Extra Heavy Duty G-Clamp 121

These are the strongest G-Clamps you can buy with the Drop Forged Steel Frame giving a proof load of up to 15000lbs (6,800kg) on the largest size. The steel mainscrew has a large swivel shoe to cater for uneven surfaces and a fast acting thread that is rolled into the steel for strength and resilience.

They are recommended particularly for metalworking and fabrication work where very high clamping pressures are demanded.



WOODWORKING

FORGED G-CLAMPS – AVERAGE CLAMPING FORCE 400kg

SKU	Product Description	Clamping Capacity
T119/2	Medium Duty G-Clamp 2"	50mm / 2"
T119/3	Medium Duty G-Clamp 3"	75mm / 3"
T119/4	Medium Duty G-Clamp 4"	100mm / 4"
T119/6	Medium Duty G-Clamp 6"	150mm / 6"



WOODWORKING INDUSTRIAL

HEAVY DUTY G-CLAMPS – AVERAGE CLAMPING FORCE FROM 300 - 800kg

SKU	Product Description	Clamping Capacity
T120/3	Heavy Duty G-Clamp 3"	75mm / 3"
T120/4	Heavy Duty G-Clamp 4"	100mm / 4"
T120/6	Heavy Duty G-Clamp 6"	150mm / 6"
T120/8	Heavy Duty G-Clamp 8"	200mm / 8"
T120/10	Heavy Duty G-Clamp 10"	250mm / 10"
T 120/12	Heavy Duty G-Clamp 12"	300mm / 12"



EXTRA HEAVY DUTY G-CLAMPS – AVERAGE CLAMPING FORCE FROM 1000 - 2500Kg

SKU	Product Description	Clamping Capacity
T121/3	Extra Heavy Duty G-Clamp 3"	75mm / 3"
T121/4	Extra Heavy Duty G-Clamp 4"	100mm / 4"
T121/6	Extra Heavy Duty G-Clamp 6"	150mm / 6"
T121/8	Extra Heavy Duty G-Clamp 8"	200mm / 8"
T121/10	Extra Heavy Duty G-Clamp 10"	250mm / 10"
T121/12	Extra Heavy Duty G-Clamp 12"	300mm / 12"

IRWIN®

Record®

Quick-Release G-Clamp

The all-purpose G-Clamp for heavy duty woodworking and medium duty metalworking jobs is equipped with a spring supported moving jaw and saves up to 75% of time against a traditional G-Clamp. Due to the moveable jaw, the length of the thread is reduced to the minimum.

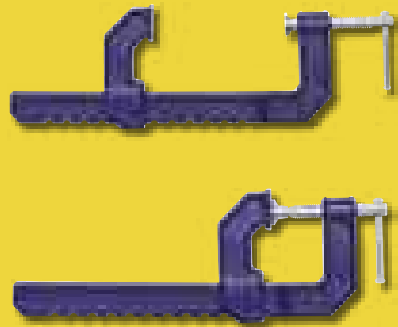

Deep Throat G-Clamp 122

This is a special heavy duty clamp with a 4"/100mm throat depth which is used for clamping well in from the edge of the work. The frame is cast from S.G. Ductile iron and guaranteed unbreakable. A hard wearing, fast acting thread is rolled into the steel mainscrew which is also fitted with a steel swivel shoe for uneven surfaces.



INDUSTRIAL

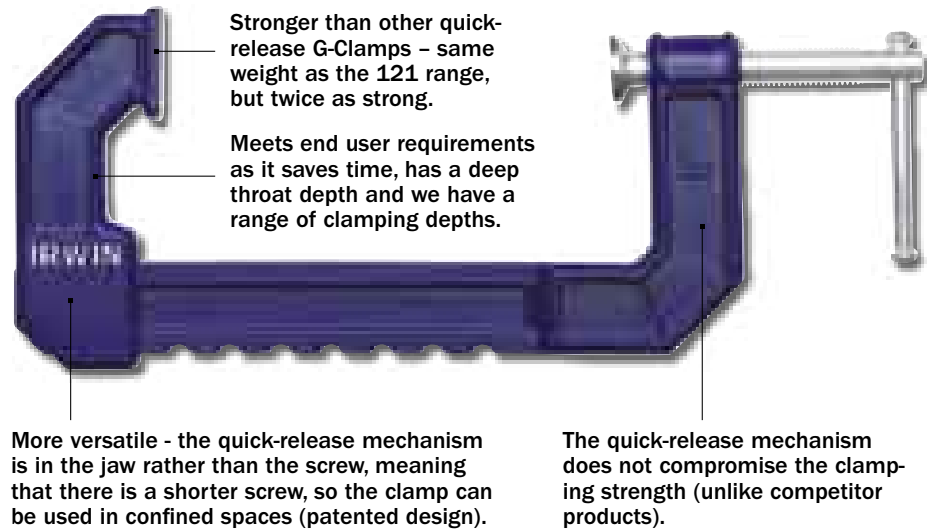

▶ QUICK-RELEASE G-CLAMPS – CLAMPING DEPTH 75mm, AVERAGE CLAMPING FORCE 1000kg

SKU	Product Description	Clamping Capacity
10504422	Quick-Release G-Clamp 150	150mm / 6"
10504423	Quick-Release G-Clamp 225	225mm / 9"

▶ QUICK-RELEASE G-CLAMPS – CLAMPING DEPTH 100mm, AVERAGE CLAMPING FORCE 1400kg

SKU	Product Description	Clamping Capacity
10504424	Quick-Release G-Clamp 300	300mm / 12"

▶ DEEP THROAT DUTY G-CLAMPS – CLAMPING DEPTH 100mm, AVERAGE CLAMPING FORCE 600kg

SKU	Product Description	Clamping Capacity
T122/4	Deep Throat G-Clamp 4"	100mm / 4"

IRWIN®

Record®

Corner Clamps

Accurate mitre clamping is provided by the light duty IRWIN Record Corner Clamps. There are two clamping capacities available in this range: 50mm/2" and 100mm/4 1/4" capacity. Thanks to the precision machined clamping surfaces and open design, these clamps are straight forward to operate and provide easy access for glueing and nailing. IRWIN Record mitre clamps are drilled with two countersunk holes for fixing to a wooden block, which can then be secured between the jaws of a bench vice.

Flooring Clamp

Designed to close up floor boards prior to nailing, this compact and robust clamp has two spring loaded cams which straddle the joist, holding the clamp firmly in position. Turning the handle then moves the shoe forward, pushing the floorboard into position. For standard 75mm/3" joists.

WOODWORKING



▶ MITRE CUTTING CORNER CLAMPS

SKU	Product Description	Clamping Capacity
TM140	Mitre Cutting Corner Clamp 2"	50mm / 2"
TM141	Mitre Cutting Corner Clamp 4 1/4"	100mm / 4 1/4"



▶ FLOORING CLAMPS

SKU	Product Description	Clamping Capacity
TMFC153	Flooring Clamp 3"	75mm / 3"

IRWIN®

Record®

Mechanics' Vices

Rigid and robust, the body and sliding jaw are cast from close-grained grey iron which is CNC manufactured on all friction surfaces for a smooth reliable action.

The jaws, handle and main screw are steel, the latter having a two-start rolled acme thread to speed the jaws from fully closed to fully open with a minimum of winding.

Workshop Vices

This type of vice features an integral anvil, which is ideal for professional tradesmen, or handymen at an affordable price. The failsafe stress bearing components help prevent damage to the vice mechanism. This vice features replaceable steel jaw plates, an integral anvil, and a steel mainscrew with two-start acme thread for a fast smooth operation. The safety stop helps prevent the jaw from falling out at maximum capacity.

Drill Press Vices

Quality and precision are the hallmarks of these IRWIN Record drill press vices, an ideal addition to the engineering workshop or tool room.

- Unique swivel jaw for any shape of workpiece.
- Cross drilled handle with tommy bar for extra leverage.
- Precision machined base and end face for stable horizontal or vertical mounting.
- Precision machined sides.
- Horizontal and vertical "V" grooved jaws for round section work.
- High quality cast body and sliding jaw of guaranteed strength.

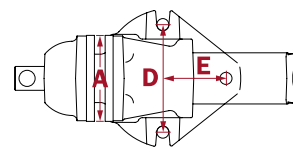

▲ = Weight
 A = Jaw width.
 B = Depth from top of jaw to top of slide.
 C = Max. jaw opening.
 D = Distance between centres of front fixing holes.
 E = Distance from mid-point between front of fixing hole centres to centre of rear fixing hole.
 F = Average clamping force

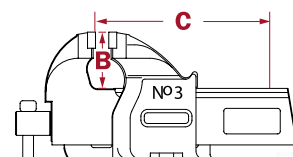

MECHANICS' VICES

SKU	Product Description	(kg)	A (mm)	B (mm)	C (mm)	D (mm)	E (mm)	F (kg)
T1	Mechanics' Vice 3" (75mm)	5.4	76	48	95	89	62	1000
T3	Mechanics' Vice 4" (100mm)	15	102	70	120	129	75	1500
T4	Mechanics' Vice 4-1/2" (115mm)	19	114	75	140	137	81	2000
T5	Mechanics' Vice 5" (125mm)	24	127	83	165	140	91	2500
T6	Mechanics' Vice 6" (150mm)	32	152	89	205	165	121	2500
T8	Mechanics' Vice 8" (205mm)	38	203	102	235	165	143	2500



WORKSHOP VICES

SKU	Product Description	(kg)	A (mm)	B (mm)	C (mm)	D (mm)	E (mm)	F (kg)
T4121100	Vice with Anvil	7.6	102	60	102	115	65	1000
T3TON-3VS	Vice with Anvil & SB	7.6	102	60	102	115	65	1000
T5TON-3VS	Vice with Anvil	15.75	102	70	120	165	143	1500
T6TON-3VS	Vice with Anvil	21.25	127	75	145	203	176	2000



DRILL PRESS VICES

SKU	Product Description	(kg)	A (mm)	B (mm)	C (mm)	D (mm)	F (kg)
T414	Drill Press Vice 4" (100mm)	5.2	100	32	75	125	1000
TPV3-B	Drill Press Vice 4" (100mm)	4.5	104	32	75	141	1000

INDUSTRIAL

IRWIN®

Record®

Quick-Release Fitters Vice

Designed for fitting, filing and large assembly work, this vice is standard equipment for many industrial and training workshops. The quick release mechanism disengages the main screw allowing rapid movement of the slide.

Quick-Release Engineers Vices

Made from S.G. Ductile iron of high impact resistance each vice has an integral anvil for shaping and beating, together with a quick-release mechanism for rapid slide adjustment. A number of factors will determine which Engineers Vice you choose, but a good rule-of-thumb to begin with is that the weight of the vice should compliment the weight of the work.

84-34 Lightest and smallest of the range, this is a natural development of the medium duty Fitters Vice built for similar but more demanding applications.

36 Next heaviest, (but a lightweight in its class) the 'streamline' shape of the 36 provides a wide throat under the jaws for large irregular work.

112 & 114 At 72lbs (32.7kg) and 86lbs (39.0kg) respectively, these are the heaviest vices in the IRWIN Record range.

Plain Screw Woodworking Vices

Manufactured in three capacities, these full size workshop vices are designed for bench mounting.

The cast grey iron body and front plate are precision machined to house two solid steel guide rods giving the vice a smooth, true parallel action free of side or cross movement.

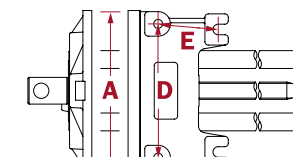

▲ = Weight
 A = Jaw width.
 B = Depth from top of jaw to top of slide.
 C = Max. jaw opening.
 D = Distance between centres of front fixing holes.
 E = Distance from mid-point between front of fixing hole centres to centre of rear fixing hole.
 F = Average clamping force

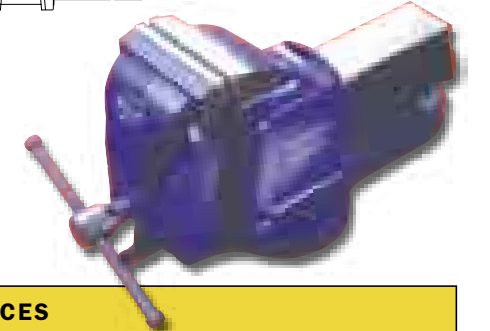
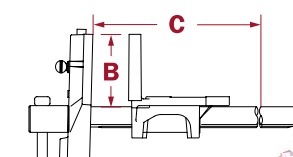

QUICK-RELEASE FITTERS VICES

SKU	Product Description	(kg)	A (mm)	B (mm)	C (mm)	D (mm)	E (mm)	F (kg)
T23	QR Fitters Vice 4-1/2" (115mm)	5.2	110	85	165	143	213	2000
T25	QR Fitters Vice 6" (150mm)	4.5	150	115	210	165	273	2500

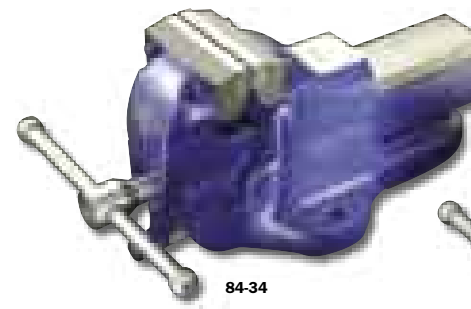

QUICK-RELEASE ENGINEERS VICES

SKU	Product Description	(kg)	A (mm)	B (mm)	C (mm)	D (mm)	E (mm)
T84-34	QR Engineers Vice 4-1/2" (115mm)	17	115	80	150	143	194
T36	QR Engineers Vice 6" (150mm)	29	150	100	190	165	121
T112	QR Engineers Vice 6" (150mm)	33	150	95	185	192	221
T114	QR Engineers Vice 8" (205mm)	39	205	115	235	203	280

WOODWORKING

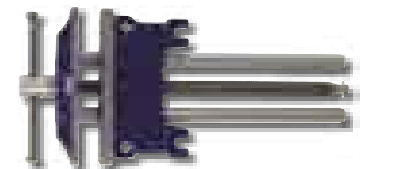

PLAIN SCREW VICES

SKU	Product Description	(kg)	A (mm)	B (mm)	C (mm)	D (mm)	E (mm)	F (kg)
T52PD	Plain Screw Vices 7"	9.1	175	75	205	150	150	1000
T52.1/2PD	Plain Screw Vices 9"	16.3	230	100	330	190	175	1000
T53PD	Plain Screw Vices 10-1/2"	17.1	265	100	380	190	175	1000

IRWIN®

Record®

Professional Quick-Release Woodworking Vices

Squeeze the trigger, and a quick-release vice can be opened and closed without using the mainscrew. Large and small work pieces can be quickly interchanged, while releasing the trigger returns the mechanism to normal for fine adjustment.

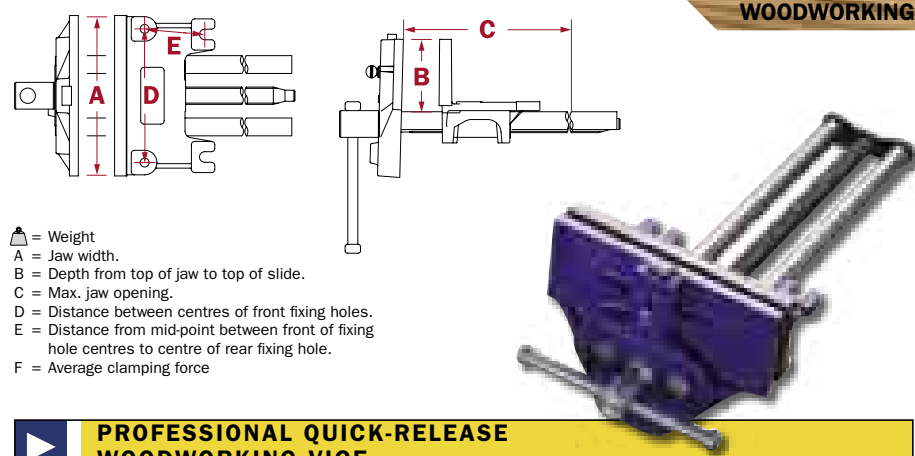

▲ = Weight
 A = Jaw width.
 B = Depth from top of jaw to top of slide.
 C = Max. jaw opening.
 D = Distance between centres of front fixing holes.
 E = Distance from mid-point between front of fixing hole centres to centre of rear fixing hole.
 F = Average clamping force

PROFESSIONAL QUICK-RELEASE WOODWORKING VICE								
SKU	Product Description	▲ (kg)	A (mm)	B (mm)	C (mm)	D (mm)	E (mm)	F (kg)
T52ED	QR Woodworking Vice 7"	9.1	175	75	205	150	150	1000
T521/2ED	QR Woodworking Vice 9"	16.30	230	100	330	190	175	1000
53ED	QR Woodworking Vice 10-1/2"	17.10	265	100	380	190	175	1000

Woodcraft Vices

This is a range of lightweight vices for the young woodworker, or home handyman, yet it provides a robust product suitable for the professional who needs a compact vice for smaller work. The V150 (150mm / 6") and V175 (165mm / 7") are made to be fitted under the work bench, in the normal way, so that the jaws are flush with the bench top.



WOODCRAFT VICES								
SKU	Product Description	▲ (kg)	A (mm)	B (mm)	C (mm)	D (mm)	E (mm)	F (kg)
TV149B	Woodworking Vice 6"	2.5	150	50	115	120	120	500
TV150B	Woodworking Vice 6"	2.8	150	50	115	N/A	120	500
TV175B	Woodworking Vice 7"	5.3	175	70	165	150	137	700

Table Vice

This is an ideal portable vice for the multipurpose use. The built-in clamp allows it to be easily and quickly attached to a bench, table or work surface. Pipe grips are incorporated below the parallel jaws. A useful anvil is also included on the rear of the body.

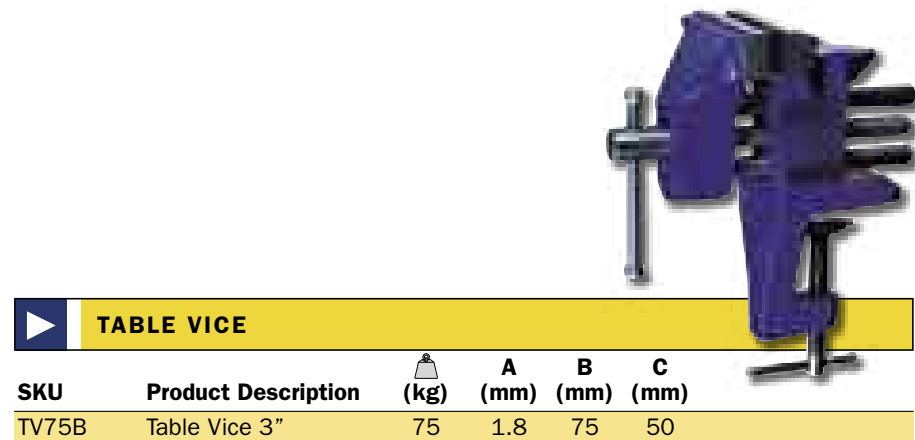

TABLE VICE					
SKU	Product Description	▲ (kg)	A (mm)	B (mm)	C (mm)
TV75B	Table Vice 3"	75	1.8	75	50

IRWIN®

Record®

Accessories

Replaceable Vice Jaws

Replaceable jaw plates are available for all Mechanics, Fitters, Multi-Purpose and Engineers Vices. Hardened, CHC machined, complete with screws or bolts and ready to fit.



RELACEABLE VICE JAWS		
SKU	Product Description	Accessory for...
T1-D	Replaceable jaw plates 1-D 3"	N°. 1 Vices
T3-D	Replaceable jaw plates 3-D 4"	N°. 3 Vices
T4-D	Replaceable jaw plates 4-D 4-1/2" (for Vices Pre 1996)	N°. 4 Vices
T4-DN	Replaceable jaw plates 4-DN 4-1/2" (for Vices Post 1996)	N°. 4 Vices
T5-D	Replaceable jaw plates 5-D 5"	N°. 5 Vices
T6-D	Replaceable jaw plates 6-D 6"	N°. 6 Vices
T8-D	Replaceable jaw plates 8-D 8"	N°. 8 Vices
T23-O	Replaceable jaw plates 23-O 4-1/2"	N°. 23 Vices
T25-O	Replaceable jaw plates 25-O 6"	N°. 25 Vices
T84-O	Replaceable jaw plates 84-O 4-1/2"	N°. 84 Vices
T36-O	Replaceable jaw plates 36-O 6"	N°. 36 Vices
T112-O	Replaceable jaw plates 112-O 8"	N°. 112 Vices
T114-O	Replaceable jaw plates 114-O 8"	N°. 114 Vices

Swivel Bases

360 degrees swivel bases are used to rotate and lock the vice at the most convenient working angle.

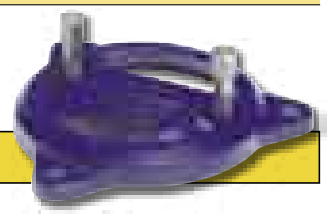

SWIVEL BASE		
SKU	Product Description	Accessory for...
T1SB	Swivel Base 1SB	N°. 1 Vices
T3SB	Swivel Base 3SB	N°. 3 Vices
T4SB	Swivel Base 4SB	N°. 4 & 5 Vices
T6SB	Swivel Base 6SB	N°. 6, 8, 25 & 36 Vices
T84-34/23SB	Swivel Base 84-34/23SB	N°. 84-34 & 23 Vices

Fibre Grips

These fibre faced clip-on jaws are made in a range of nine sizes up to a maximum jaw width of 150mm (6"). They are used for holding and protecting copper, aluminium, brass and similar soft metal components.



FIBRE GRIPS		
SKU	Product Description	Accessory for...
TFG3	Fibre Grips 3"	3" Per Pair
TFG3-1/2	Fibre Grips 3-1/2"	3-1/2" Per Pair
TFG4	Fibre Grips 4"	4" Per Pair
TFG4-1/4	Fibre Grips 4-1/4"	4-1/4" Per Pair
TFG4-1/2	Fibre Grips 4-1/2"	4-1/2" Per Pair
TFG5	Fibre Grips 5"	5" Per Pair
TFG5-1/2	Fibre Grips 5-1/2"	5-1/2" Per Pair
TFG6	Fibre Grips 6"	6" Per Pair