

Parts Information:
Trolley 2-Level Heavy-Duty with Lockable
Top & 2 Drawers
Model No: CX1042D

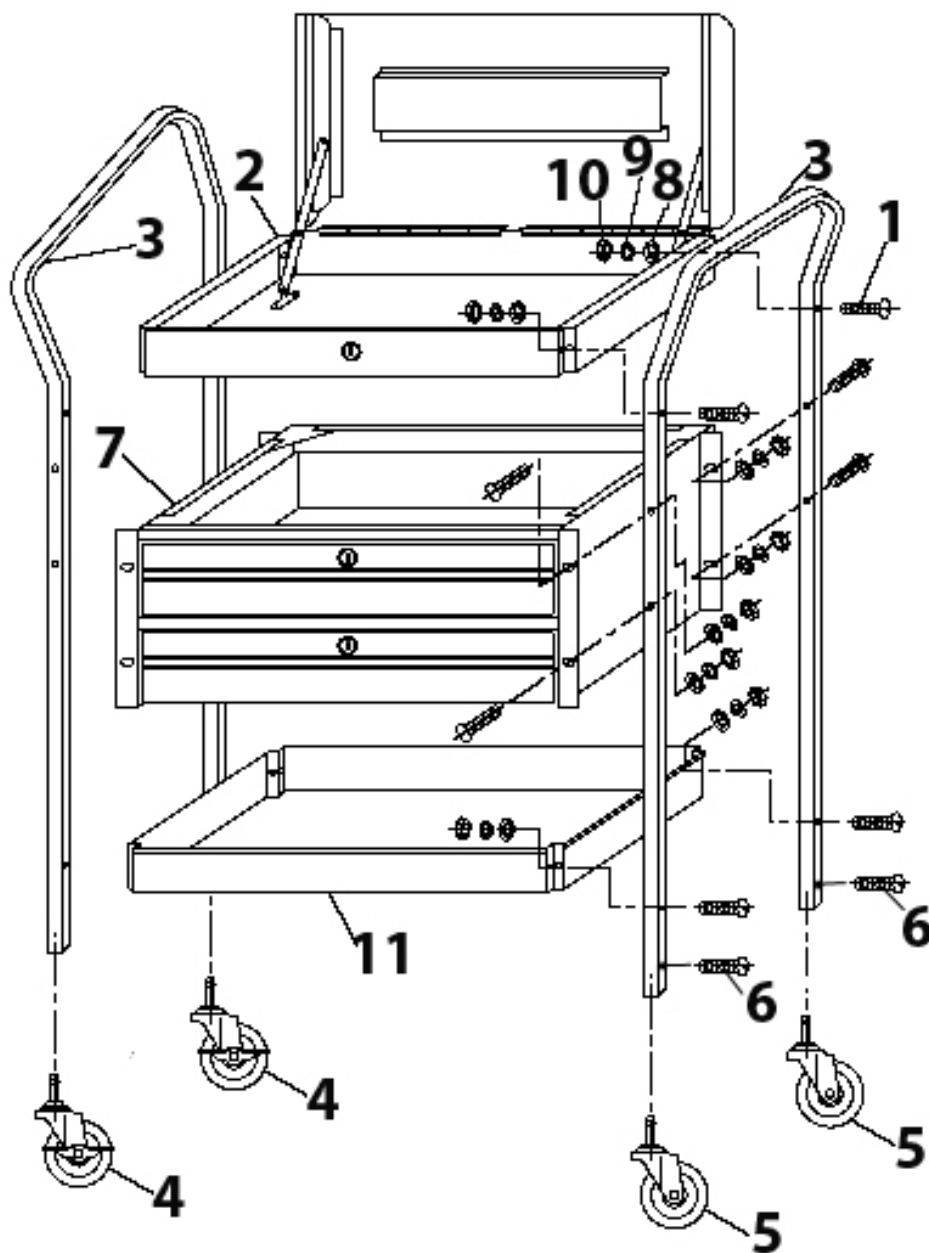

Item	Part No.	Description
1	MSP635.S	MACHINE SCREW PAN HEAD PHILLIPS M6x35mm
2	CX1042D.02	TRAY WITH LID
3	CX1042D.03	CHROME HANDLE
4	CX1042D.04	WHEEL,CASTOR (W/BRAKE)(102x9x29x123)
5	CX1042D.05	WHEEL,CASTOR (102x9x30x123)
6	MSP612.S	MACHINE SCREW PAN HEAD PHILLIPS M6x12mm

Item	Part No.	Description
7	CX1042D.07	TOOL CHEST
8	LS1050V.27	WASHER M6
9	SWM6.S	SPRING WASHER M6 ZINC (SINGLE)
10	SN6.S	STEEL NUT M6 ZINC DIN934 (SINGLE)
11	CX1042D.11	TRAY
--	CX101D.12	LOCK & KEY (NOT SHOWN)

NOTE: It is our policy to continually improve products and as such we reserve the right to alter data, specifications and component parts without prior notice.
IMPORTANT: No liability is accepted for incorrect use of product.
WARRANTY: Guarantee is 12 months from purchase date, proof of which will be required for any claim.