



# APPLICATION GUIDE FOR: FLYWHEEL & FRONT PULLEY **LOCKING TOOL SET**

27111



This document is part of the product, keep it for the life of the product passing it on to any subsequent holder of the product. Read all information before operating product.

This guide has been compiled by Draper Tools describing the purpose for which the product has been designed, and contains necessary information to ensure its correct and safe use. By following the information contained in this guide, it will ensure both product and operator safety, together with longer life of the product itself.

All photographs and drawings in this guide are supplied by Draper Tools to help illustrate the operation of the product.

Whilst every effort has been made to ensure the accuracy of information contained in this guide, the Draper Tools policy of continuous improvement determines the right to make modifications without prior warning.

# 1. TITLE PAGE

---

## 1.1 INTRODUCTION:

**USER GUIDE FOR: Flywheel & Front Pulley Locking Tool Set**

**Stock No: 27111**

**Part No: ETK219**

## 1.2 REVISIONS:

**Date first published June 2018.**

---

---

---

---

As our user manuals are continually updated, users should make sure that they use the very latest version.

**Downloads are available from:** <http://drapertools.com>

Draper Tools Limited

Hursley Road

Chandler's Ford

Eastleigh

Hampshire

SO53 1YF

UK

**Website:** [drapertools.com](http://drapertools.com)

**Product Helpline:** +44 (0) 23 8049 4344

**General Fax:** +44 (0) 23 8026 0784

## 1.3 UNDERSTANDING THIS GUIDES SAFETY CONTENT:

**WARNING!** – Information that draws attention to the risk of injury or death.

**CAUTION!** – Information that draws attention to the risk of damage to the product or surroundings.

## 1.4 COPYRIGHT © NOTICE:

Copyright © Draper Tools Limited.

Permission is granted to reproduce this publication for personal and educational use only. Commercial copying, redistribution, hiring or lending is prohibited.

No part of this publication may be stored in a retrieval system or transmitted in any other form or means without written permission from Draper Tools Limited.

In all cases this copyright notice must remain intact.

## 2. CONTENTS

---

<b>1. TITLE PAGE</b>	
1.1 INTRODUCTION .....	2
1.2 REVISION HISTORY .....	2
1.3 UNDERSTANDING THIS GUIDE.....	2
1.4 COPYRIGHT NOTICE .....	2
<b>2. CONTENTS</b>	
2.1 CONTENTS .....	3
<b>3. GUARANTEE</b>	
3.1 GUARANTEE .....	4
<b>4. GENERAL PRODUCT INFORMATION</b>	
4.1 GENERAL PRODUCT INFORMATION .....	5
<b>5. HEALTH AND SAFETY INFORMATION</b>	
5.1 GENERAL SAFETY INSTRUCTIONS FOR USE	
<b>Personal safety</b> .....	6
<b>6. CONTENTS</b>	
6.1 PARTS DRAWING AND LISTING .....	7
<b>7. APPLICATION</b>	
7.1 PRODUCT APPLICATION AND COMPATIBILITY LISTING .....	8
<b>8. PREPARATION</b>	
8.1 ADVISORIES BEFORE USE .....	9
<b>9. PROCEDURE AND APPLICATION GUIDE</b>	
9.1 APPLICATION GUIDANCE .....	10
<b>10. EXPLANATION OF SYMBOLS</b>	
10.1 EXPLANATION OF SYMBOLS .....	11

## 3. GUARANTEE

---

### 3.1 GUARANTEE

Draper tools have been carefully tested and inspected before shipment and are guaranteed to be free from defective materials and workmanship.

Should the tool develop a fault, please return the complete tool to your nearest distributor or contact:

**Draper Tools Limited, Chandler's Ford, Eastleigh, Hampshire, SO53 1YF. England.**

**Telephone Sales Desk: (023) 8049 4333** or:

**Product Helpline (023) 8049 4344.**

A proof of purchase must be provided.

If upon inspection it is found that the fault occurring is due to defective materials or workmanship, repairs will be carried out free of charge. This guarantee period covering parts/labour is 12 months from the date of purchase except where tools are hired out when the guarantee period is 90 days from the date of purchase. This guarantee does not apply to normal wear and tear, nor does it cover any damage caused by misuse, careless or unsafe handling, alterations, accidents, or repairs attempted or made by any personnel other than the authorised Draper warranty repair agent.

Note: If the tool is found not to be within the terms of warranty, repairs and carriage charges will be quoted and made accordingly.

This guarantee applies in lieu of any other guarantee expressed or implied and variations of its terms are not authorised.

Your Draper guarantee is not effective unless you can produce upon request a dated receipt or invoice to verify your proof of purchase within the guarantee period.

Please note that this guarantee is an additional benefit and does not affect your statutory rights.

**Draper Tools Limited.**

## 4. GENERAL PRODUCT INFORMATION

---

This product is designed to be used correctly and with care for the purpose for which it is intended. No liability is accepted by Draper Tools Limited for incorrect use or application of any of our products, and Draper Tools Limited cannot be held responsible for any damage to personnel, property or equipment when using this product. Incorrect use will also invalidate any warranty.

The applications database and any instructional information provided has been designed to offer general guidance for a particular product's use and while all attention is given to the accuracy of the data, no project should be attempted without referring first to the manufacturer's technical documentation (workshop or instruction manual) or the use of a recognised authority such as Autodata.

It is our policy to continually improve our products and thus we reserve the right to alter specifications and components without prior notice. It is the responsibility of the user to ensure the suitability of the product and information prior to use.

## 5. HEALTH AND SAFETY INFORMATION

---

### GENERAL SAFETY INSTRUCTIONS

**Warning:** Please read all safety warnings and all details carefully. Failure to follow the warnings may result in serious injury or major component damage.

**Important:** Draper Tools recommends that this product should not be modified or used for any application other than that for which it was designed.

**Save all warnings and instructions for future reference.**

#### 1) Personal safety

- a) Stay alert, watch what you are doing and use common sense when using this product. Do not use this product while you are tired or under the influence of drugs, alcohol or any medication. A moment of inattention while using this product may result in serious personal injury.
- b) Use personal protective equipment as necessary.
- c) Check and remove any part of the product before turning/testing the engine. A part left attached to a rotating part of the engine may result in personal injury or major component damage.
- d) Carefully clean the tool components after every use.
- f) Keep the tool components safe and tidy.
- g) Do not use this product for any purpose other than for which it is designed.

**Warning!** Some of the packaging materials used may be harmful to children. Do not leave any of these materials in the reach of children.

If any of the packaging is to be thrown away, make sure it is disposed of correctly; according to local regulations.

## 6. CONTENTS

---

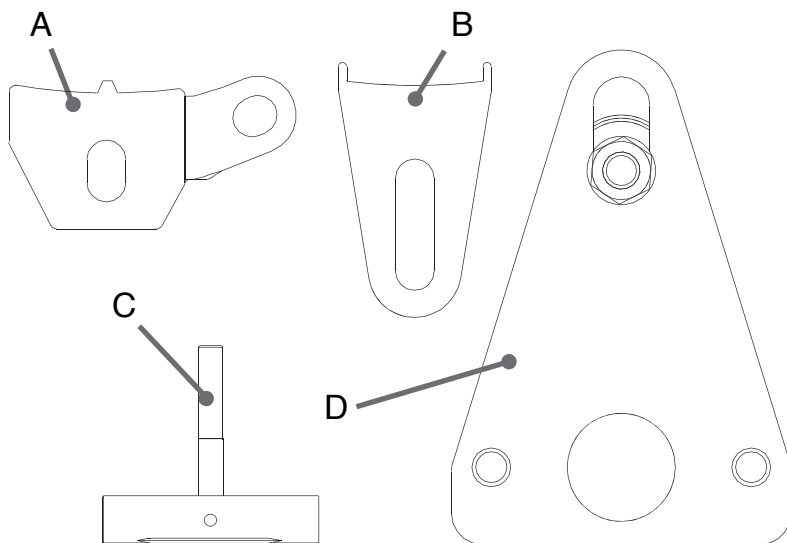

ITEM	DESCRIPTION	OEM	STOCK No.
A	Flywheel Locking Tool	MOT 919-02	34606
B	Flywheel Locking Tool	MOT.1431	34611
C	Cover Joint Separator Tool	MOT1716	34638
D	Crankshaft Pulley Holding Tool	MOT.2019 MOT.1789	34645

## 7. APPLICATION

The 27111 has been developed as a **flywheel and front pulley locking tool set** for the vehicles listed below. Designed as a flywheel and front pulley locking tool for Renault and Nissan engines. The kit also contains the essential cover joint separator tool.

### Used on the following Vehicles:

Renault Clio 2006 - 2016 Renaultsport 220 Trophy

Renault Espace V 2015 - 2016 TCe 130

Renault Espace/Grand Espace IV 2002 - 2015 dCi

Renault Fluence 2009 - 2015 TCe

Renault Koleos 2008 - 2016 Renaultsport dCi 175

Renault Laguna 2005 - 2015 16V

Renault Latitude 2010 - 2016 Flex-Fuel 16V

Renault Master III 2010 - 2016

Renault Megane 2006 - 2015 Bio-Ethanol

Renault Scenic/Grand Scenic 2006 - 2015 16V E85

Renault Traffic II 2007 - 2015 GT dCi

Renault Vel Satis 2000 - 2010 CDTi

Nissan NP300 Navara 2015 - 2016

Nissan NV400 2011 - 2016

Nissan Primastar 2006 - 2015

Nissan Qashqai/Qashqai+2 2007 - 2014

Nissan X-Trail 2007 - 2014

### Engine Codes:

1.4cc H4Jt 700

1.6cc

M5M 400, M5M, M5M 450

2.0cc

M4R 700, M4R 701, M4R 714, M4R 750, M4R 751, M4R 752, M4R 753, M4R 737, M4R 704, M4R 726, M4R 730, M4R 735, M4R 746, M4R, M4R 711, M4R 713, M9R 740, M9R 760, M9R 761, M9R 812, M9R 814, M9R 815, M9R 830, M9R 832, M9R 833, M9R 834, M9R 835, M9R 836, M9R 838, M9R 855, M9R 856, M9R 865, M9R 866, M9R 742, M9R 800, M9R 805, M9R 700, M9R 721, M9R 722, M9R 724, M9R 613, M9R 615, M9R 610, M9R 630, M9R 780, M9R 782, M9R 750, M9R 762, M9R 763, M9R 858, M9R 859, M9R 8, M9R 744, M9R 746, M9R 748, M9R 754, M9R 802, M9R 803, M9R 806, M9R 808, M9R 809, M9R 820, M9R 828, M9R 845, M9R 849, M9R 854, M9R 857, M9R 816, M9R 756, M9R 804, M9R 811, M9R 817, M9R 824, M9R 839, M9R 844, M9R 846, M9R 692, M9R 784, M9R 786, M9R 788, M9R

2.3cc

M9T 670, M9T 672, M9T 676, M9T 678, M9T 680, M9T 686, M9T 690, M9T 692, M9T 694, M9T 696, M9T 698, M9T 700, M9T 702, M9T 870, M9T 880, M9T 890, M9T 896, M9T 898, M9T C6, YS23DDT, YS23DDTT, M9T 706, M9T 708

2.5cc

2TR 700, 2TR 700, 2TR 702, 2TR 703, 2TR 704, 2TR 705, 2ZV 604, V4U 604, VQ25

3.5cc

V4Y 711, V4Y 715, V4Y 701, V4Y 713



## 8. PREPARATION

---

The following is for guidance only. Please refer to OEM derived data such as the vehicle manufacturer's own data or Autodata. The use of this product is purely down to the user's discretion and Draper Tools Limited cannot be held responsible for any damage caused what so ever.

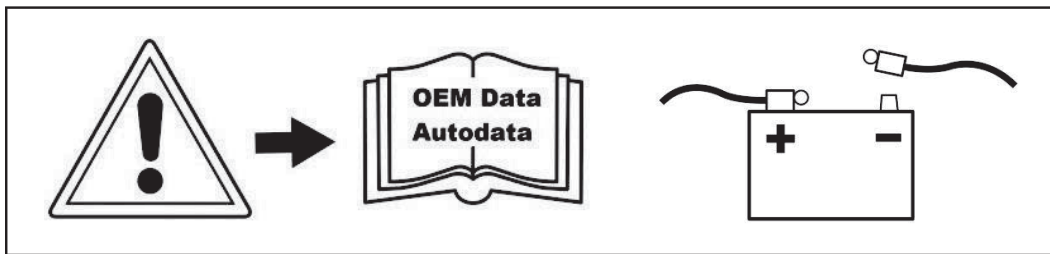

# 9. PROCEDURE AND APPLICATION GUIDE

Depending on manufacture and model, some engine components do change. Please check with Autodata or the manufacturer's data before use.

## A & B = Flywheel locking tool assembly

Components A & B are both flywheel locking tools designed to bolt on to the engine to lock the crankshaft by locking the flywheel via the ring gear teeth. Both components are used as shown with the engine and transmission removed:

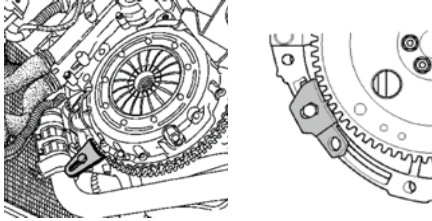

## C = Cover/Sump/joint separator tool

Component (C) is used to separate the timing cover from the engine casing once the bolts are removed. Component (C) is used as a lever and scraper to remove any sealant residue. Assemble (C) as shown. Use assembled tool to separate the cam chain casing as shown after removing fixing bolts.

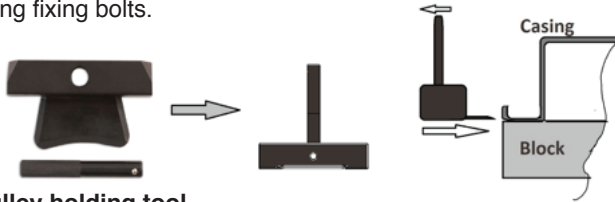

## D = Crankshaft pulley holding tool

Component D is used to hold the front engine pulley while loosening and tightening the pulley fixing bolt. Component D is a combination tool that is equivalent to 2 OEM Renault tools (MOT.2019 & MOT.1789) thanks to its adjustable locking boss.

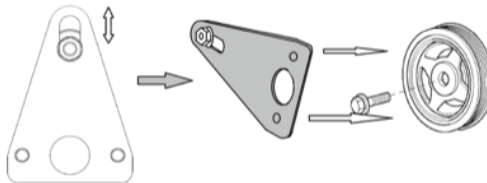

Please note images are for guidance only and subject to change.

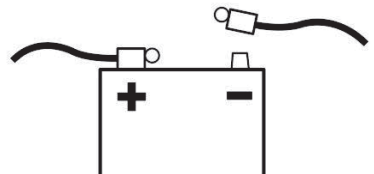

# 10. EXPLANATION OF SYMBOLS

---

## 10.1 EXPLANATION OF SYMBOLS



Read the guide.



Refer to website.

# CONTACTS

Draper Tools Limited, Hursley Road,  
Chandler's Ford, Eastleigh, Hampshire. SO53 1YF. U.K.

Helpline: (023) 8049 4344

Sales Desk: (023) 8049 4333

Internet: [drapertools.com](http://drapertools.com)

E-mail: [sales@drapertools.com](mailto:sales@drapertools.com)

General Enquiries: (023) 8026 6355

Service/Warranty Repair Agent:

For aftersales servicing or warranty repairs, please contact the  
Draper Tools Helpline for details of an agent in your local area.

YOUR DRAPER STOCKIST

CMDB0618

©Published by Draper Tools Limited.

No part of this publication may be reproduced, stored in a retrieval system or transmitted in any form or by any means, electronic, mechanical photocopying, recording or otherwise without prior permission in writing from Draper Tools Ltd.