

To make assembly easier we recommend having two persons aid one another.

FITTING THE WALL CABINET TO A PEGBOARD

STEP 1:

Attach the mounting brackets to the hanging panel with bolts M6 X 12mm (3 pcs per panel) and tighten with cross slot screwdriver (not included).

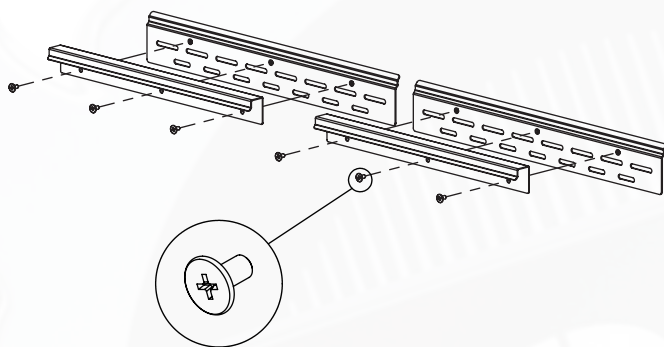

STEP 2:

Hang the mounting brackets onto the pegboard.

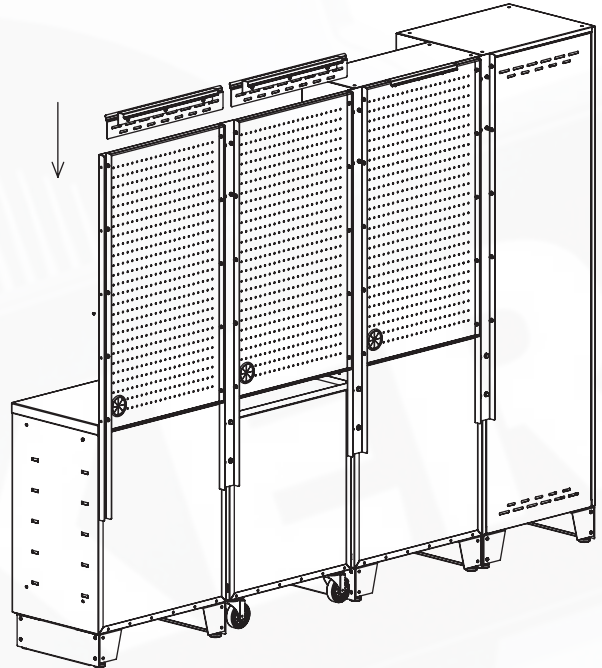

STEP 3:

Tighten the bolt M8 x 25mm (4pcs) to the wall brackets.

Note: Do not fully tighten.

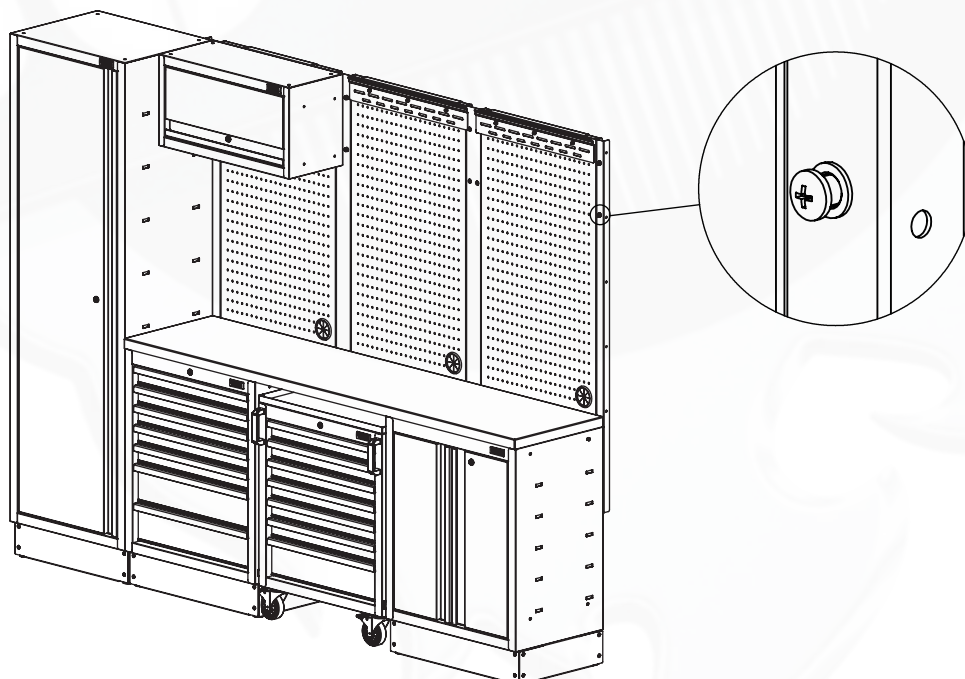

STEP 4:

Hang the wall cabinet onto the bolts and hanging panel.

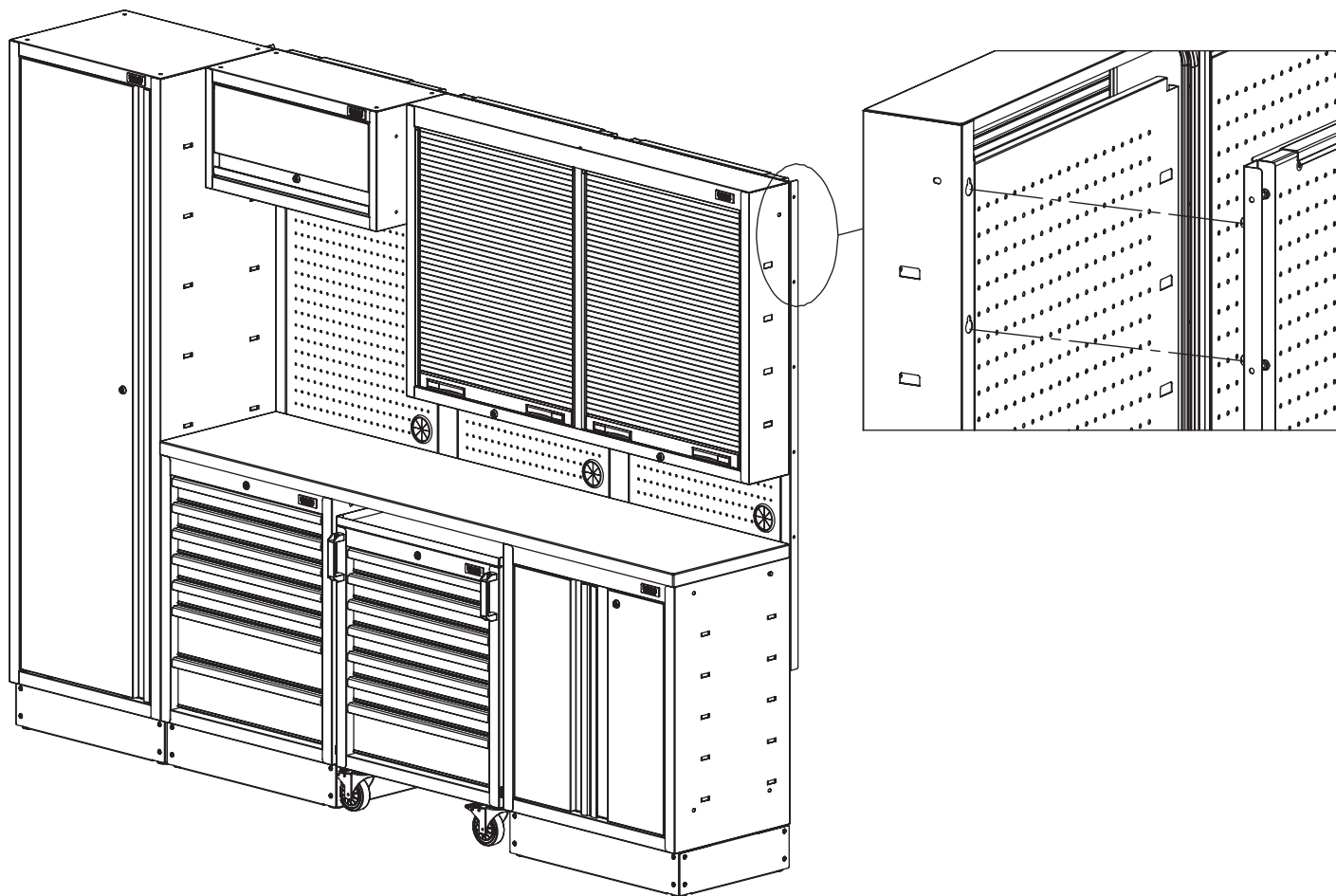

STEP 5:

Connect the side panels of two cabinets with bolt M6 x 16mm and nut M6 and tighten with wrench (not included).

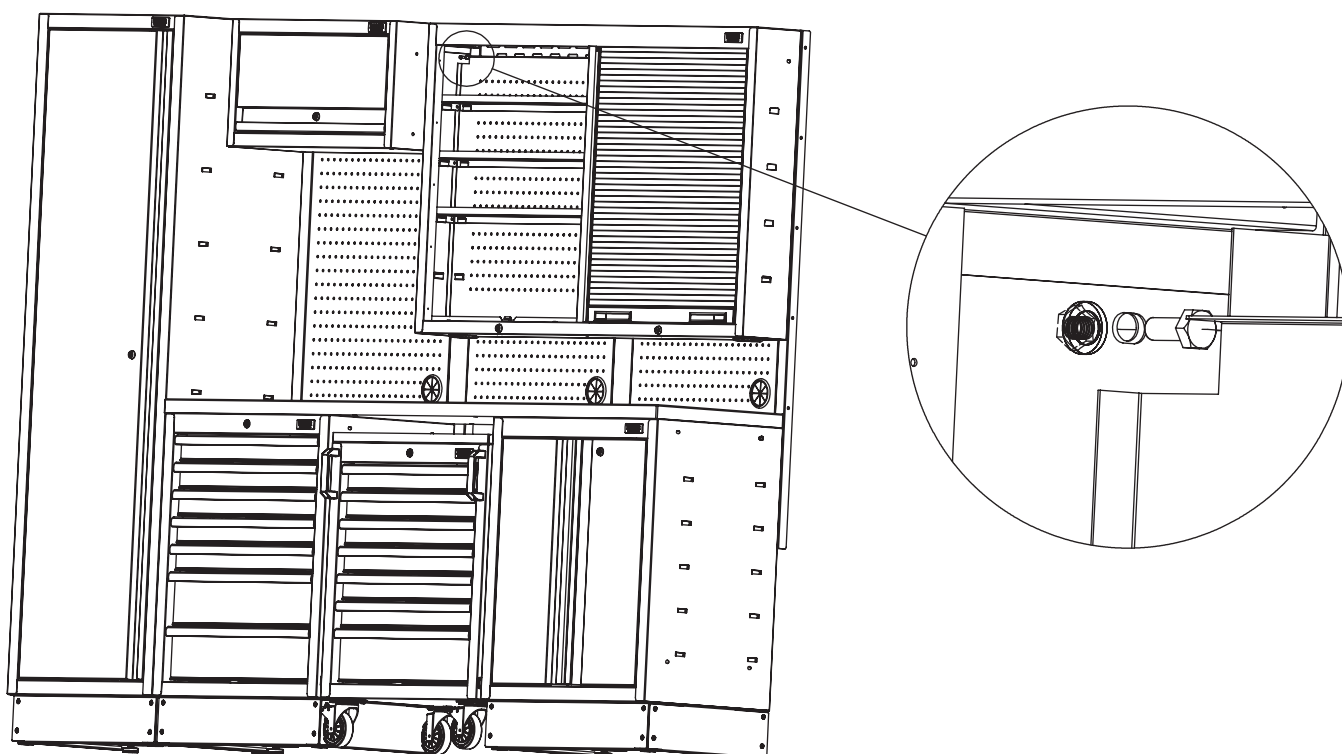

FITTING THE WALL CABINET TO A WALL

- Position the hanging panel on the wall surface, and space the plastic plugs at the required height.
- Use the holes to line up and mark the position as per the figure below.
- Using a drill bit, drill the holes and insert the eight plastic plugs.

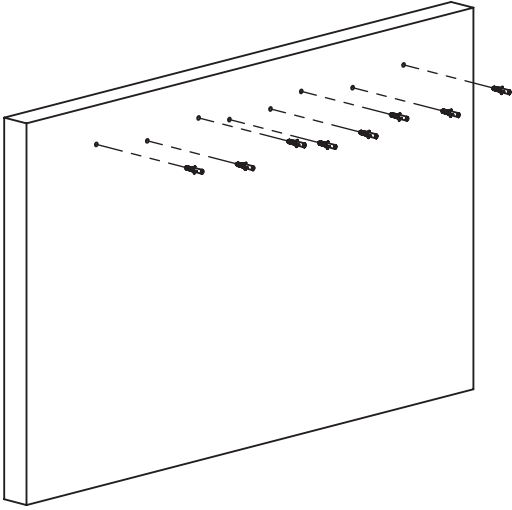

- Insert the screws (ST6.3 x 65mm) into the plastic plugs. DO NOT fully tighten.
- Hang the panels onto the screws.
- Fully tighten all the screws.

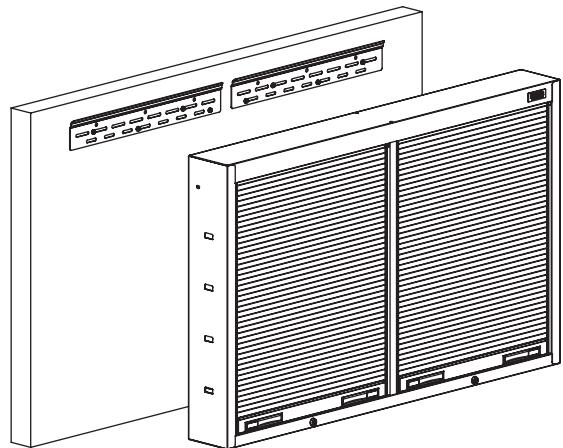
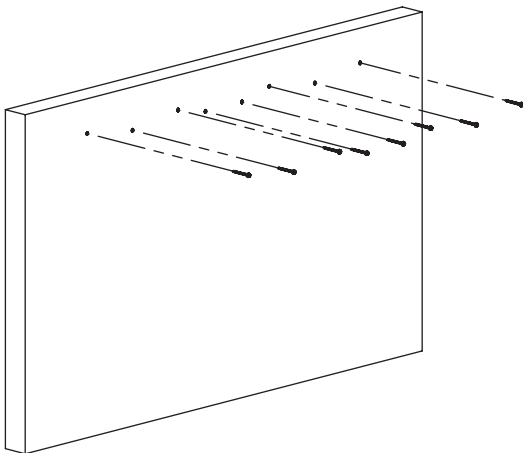

- Hang the wall cabinet onto the panels.

